

14FF-2Z-C10

PUSH-IN RELAY SOCKET

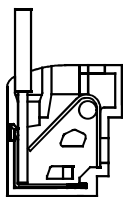

CE

cULUS

认证号:E253370



Features

- Ambient Temperature:-40℃~70℃
- Nominal Voltage: 250VAC/DC
Nominal Current: 10A
- Wire strip length:8mm
- Applicable relay types:
HF115F/115F-A,HF140FF/115FP, etc

CONTACT DATA

Type	Nominal Voltage	Nominal Current	Dielectric Strength			Conductor Cross Section Max.
			Between coil & contacts	Between open contacts	Between contact sets	
14FF-2Z-C10	250VAC/DC	10A	5000 Vrms	2000 Vrms	2000 Vrms	1×2.5mm ² (Without casing) 2×1.5mm ² (Without casing) 1×1.5mm ² (With casing) 2×1.0mm ² (With casing)

OUTLINE DIMENSIONS, WIRING DIAGRAM AND PC BOARD LAYOUT

Socket (If you need accessories, please order separately)	Outline Dimensions	Wiring Diagram / PCB Layout	Accessory Available
	<p>Top view</p>		<p>Retainer: 14FF-H4 14FF-H6 14FF-H10</p> <p>Marker: 14FF-M1</p> <p>module: HFAA~HFHU</p>

Notes: *If need accesscry,please order with type.



HONGFA RELAY

ISO9001、IATF16949、ISO14001、OHSAS18001、IECQ QC 080000 CERTIFIED

2022 Rev. 1.00

DIMENSION OF RELATED ACCESSORY (AVAILABLE)

Unit: mm

Retainer

14FF-H4(Plastic retainer)

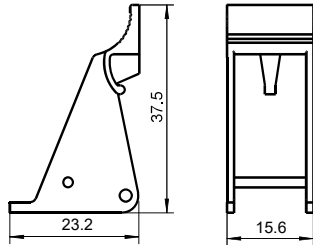

Remark: Applicable for HF115F/HF115F-A, etc

14FF-H6(Plastic retainer)

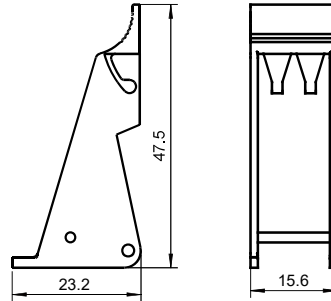

Remark: Applicable for HF115FP, HF14FF, HF14FW, HF140FF, etc.

Retainer

14FF-H10

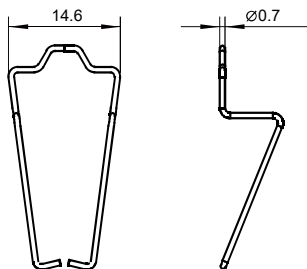

Remark: Applicable for HF158F-V (relay height 20.0mm) , etc

Marker

14FF-M1

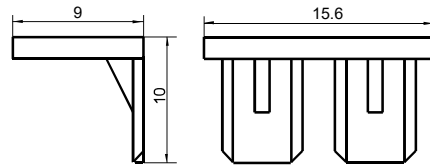

PRECAUTIONS FOR USE

Applicable conductor cross section

Solid wire	1×0.5/0.75/1.0/1.5/2.5 mm ²	
	2×0.5/0.75/1.0/1.5 mm ²	
Stranded wire	without bootlace crimp	1×0.5/0.75/1.0/1.5/2.5 mm ²
		2×0.5/0.75/1.0/1.5 mm ²
	with bootlace crimp	1×0.5/0.75/1.0/1.5 mm ²
		2×0.5/0.75/1.0 mm ²

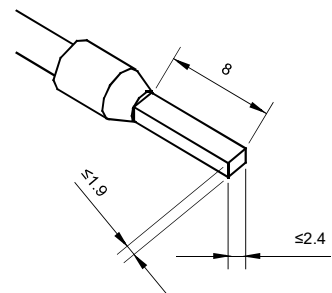

PRECAUTIONS FOR USE

Precautions For Use

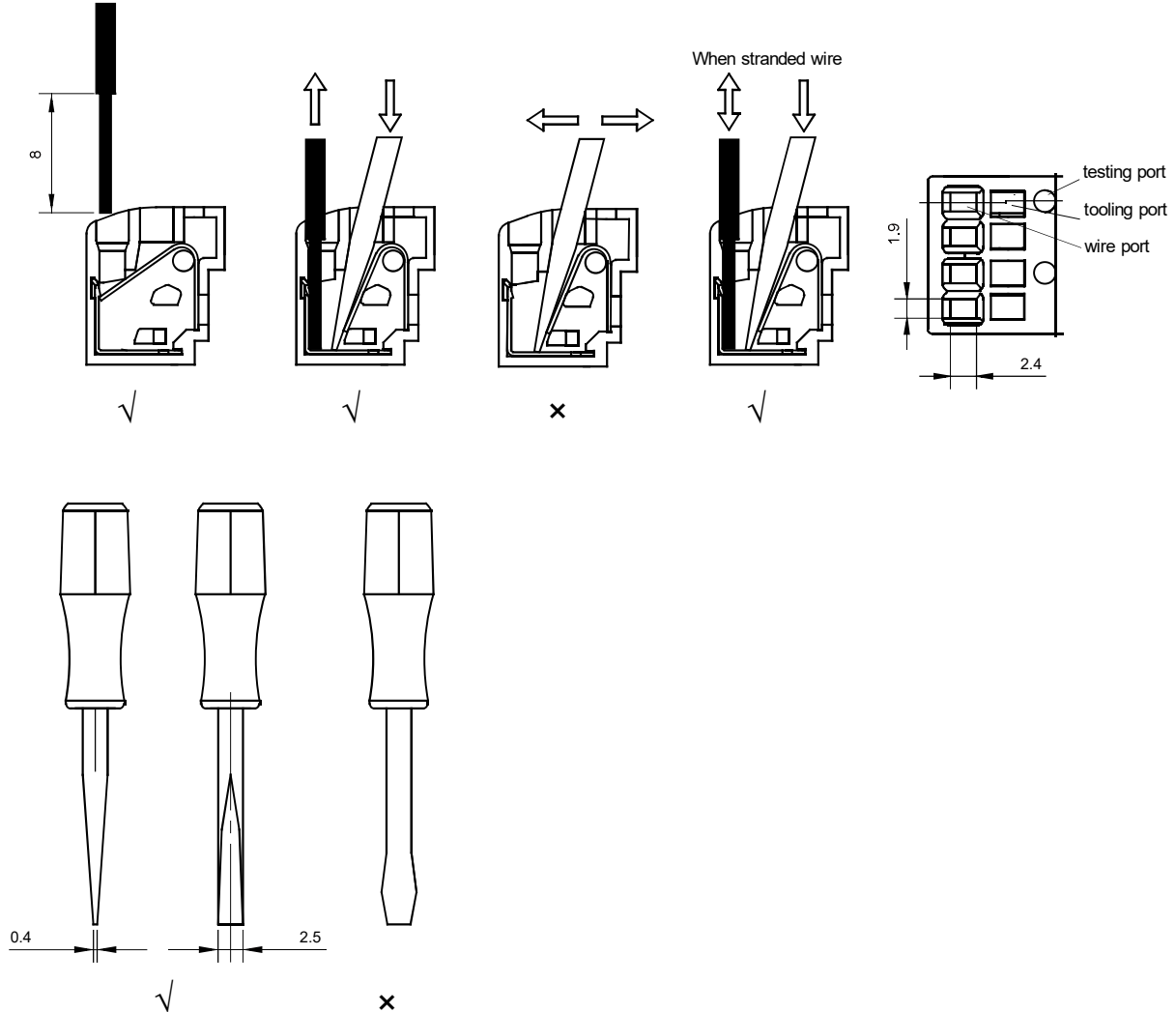

Things to be noticed when selecting sockets:

1. Please choose suitable relay socket according to the actual mounting environment, relay contact poles and terminal layout. If there is any query on selection, please contact Hongfa for the technical service.
2. Socket which can be mounted with markers is furnished with a marker; as for other related components, they should be selected separately. Please do give clear indication of the types of relay sockets and related components you choose while placing order.
3. The above is only an example of typical socket and related component type which is suitable to HF18FZ relay. If you have any special requirements, please contact us.
4. Main outline dimension, outline dimension $> 50\text{mm}$, tolerance should be $\pm 1\text{mm}$; $20\text{mm} < \text{outline dimension} \leq 50\text{mm}$, tolerance should be $\pm 0.5\text{mm}$; $5\text{mm} < \text{outline dimension} \leq 20\text{mm}$, tolerance should be $\pm 0.4\text{mm}$; outline dimension $\leq 5\text{mm}$, tolerance should be $\pm 0.3\text{mm}$.
5. DIN rail mounting: recommend to use standard rail $35 \times 7.5 \times 1\text{mm}$, $35 \times 15 \times 1\text{mm}$.

Disclaimer

The specification is for reference only. See to "Terminology and Guidelines" for more information. Specifications subject to change without notice. We could not evaluate all the performance and all the parameters for every possible application. Thus the user should be in a right position to choose the suitable product for their own application. If there is any query, please contact Hongfa for the technical service. However, it is the user's responsibility to determine which product should be used only.

© Xiamen Hongfa Electroacoustic Co., Ltd. All rights of Hongfa are reserved.