

HFE66-100 SMART CAPACITOR LATCHING RELAY



Features

- Latching relay
- Apply to smart capacitor
- 100A switching capacity (Res. load)
- Low bounce time: less than 200μs

RoHS compliant

CONTACT DATA

Contact arrangement	1A
Contact resistance ¹⁾	≤2mΩ(100A)
Contact material	AgSnO ₂
Contact rating (Res. load)	100A 250VAC(COSØ=1)6 x 10 ³ ops
Max. switching voltage	277VAC
Max. switching current	100A
Max. switching power	27700VA
Mechanical endurance	1 x 10 ⁶ ops
Electrical endurance	See "contact rating"

Notes: 1) The data shown above are initial values.

CHARACTERISTICS

Insulation resistance		1000MΩ(500VDC)
Dielectric strength	Between coil & contacts	4000VAC 1min
	Between open contacts	3000VAC(50/60Hz,1min)
Creepage distance		8.4mm
Operate time(at twice nomi. volt.)		≤6ms
Release time(at twice nomi. volt.)		≤6ms
Bounce time		≤0.2ms
Shock resistance	Functional	98m/s ²
	Destructive	980m/s ²
Vibration resistance		10Hz ~ 55Hz 1.5mm DA
Humidity		5% ~ 85% RH
Ambient temperature		-40% ~ 85%
Termination	Coil terminal	PCB、QC
	Load terminal	QC
Unit weight		Approx.42g
Construction		Plastic sealed

Notes: The data shown above are initial values.

COIL

Rated power	Single coil latching:2.5W Double coils latching:5.0W
-------------	---

COIL DATA

23°C

Single coil latching

Nominal Voltage VDC	Set / Reset Voltage ¹⁾²⁾ VDC	Pulse Duration ms	Coil Resistance x (1±10%) Ω
5	≤4.0	≥50	10
6	≤4.8	≥50	14.4
9	≤7.2	≥50	32.4
12	≤9.6	≥50	57.6
24	≤19.2	≥50	230.4
48	≤38.4	≥50	921.6

Double coils latching

Nominal Voltage VDC	Set / Reset Voltage ¹⁾²⁾ VDC	Pulse Duration ms	Coil Resistance x (1±10%) Ω
5	≤4.0	≥50	5+5
6	≤4.8	≥50	7.2+7.2
9	≤7.2	≥50	16.2+16.2
12	≤9.6	≥50	28.8+28.8
24	≤19.2	≥50	115.2+115.2
48	≤38.4	≥50	460.8+460.8

Notes:1) The data shown above are initial values.

2) The above set voltage, reset voltage are the test value for relay without load. Please use 1~1.5 times of rated voltage to drive the relay for your application.



HONGFA RELAY

ISO9001、IATF16949、ISO14001、OHSAS18001、IECQ QC 080000 CERTIFIED

2021 Rev.1.00

ORDERING INFORMATION

Type	HFE66	-100	/12	-H	T	-1	1	-R	(XXX)
Contact rating	100:100A								
Coil voltage	5,6,9,12,24,48 VDC								
Contact arrangement ¹⁾	H: 1 Form A								
Contact material	T: AgSnO ₂								
Version	1: Type 1 coil pins 2: Type 2 coil pins 3: Type 3 coil pins 4: Type 4 coil pins								
Coil type	1: Single coil latching 2: Double coils latching								
Polarity	R: Reverse polarity Nil: Standard polarity								
Special code ²⁾	XXX: Customer special requirement								

Notes:1) H means that relay is on the "reset" status when delivery;

2) The customer special requirement express as special code after evaluating by Hongfa.

OUTLINE DIMENSIONS AND WIRING DIAGRAM

Unit: mm

Outline Dimensions

HFE66-100 Type 1 coil pins

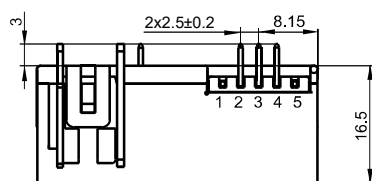

Coil Type	Pin
Single coil	2、4
Double coil	2、3、4

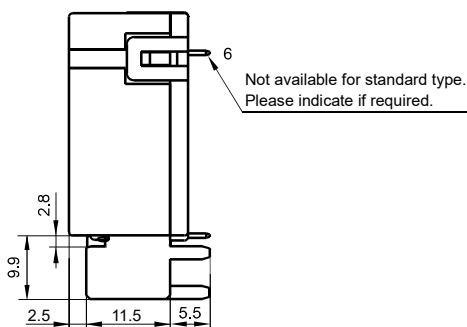
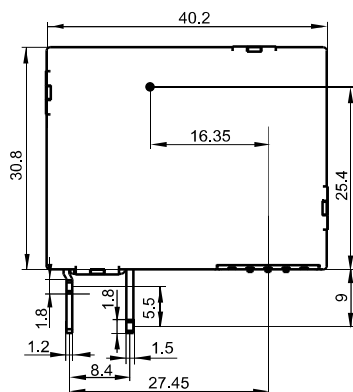

Outline Dimensions

HFE66-100 Type 2 coil pins

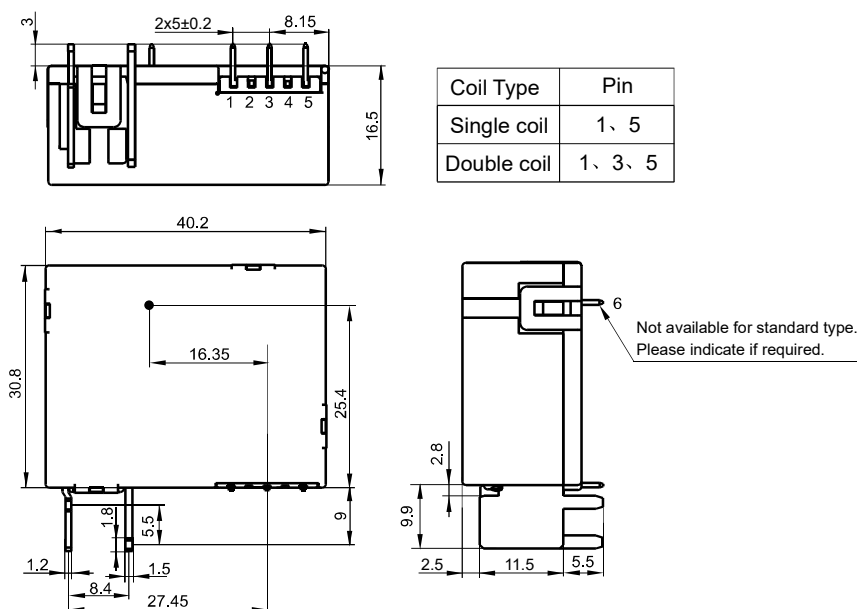

HFE66-100 Type 3 coil pins

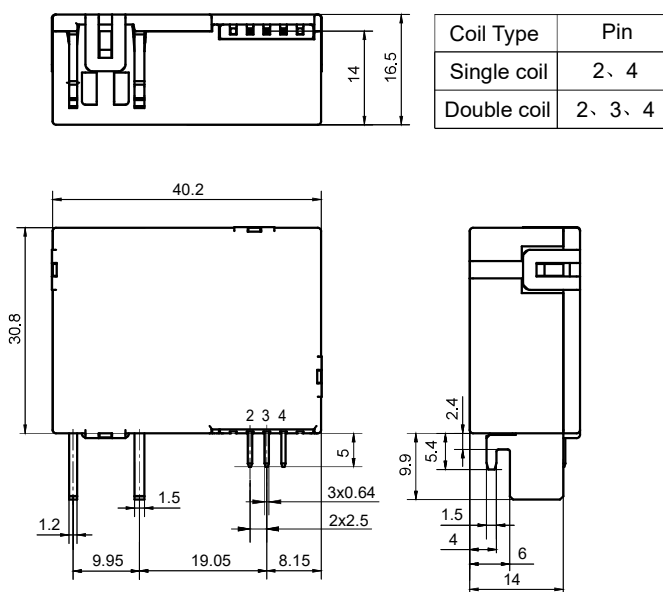

Remark:(1) In case of no tolerance shown in outline dimension: outline dimension $\leq 1\text{mm}$, tolerance should be $\pm 0.2\text{mm}$; outline dimension $> 1\text{mm}$ and $\leq 5\text{mm}$, tolerance should be $\pm 0.3\text{mm}$; outline dimension $> 5\text{mm}$, tolerance should be $\pm 0.4\text{mm}$.

(2) The tolerance without indicating for PCB layout is always $\pm 0.1\text{mm}$.

(3) Please confirm with us for the detailed mounting method and external connector.

OUTLINE DIMENSIONS AND WIRING DIAGRAM

Unit: mm

Outline Dimensions

HFE66-100 Type 4 coil pins

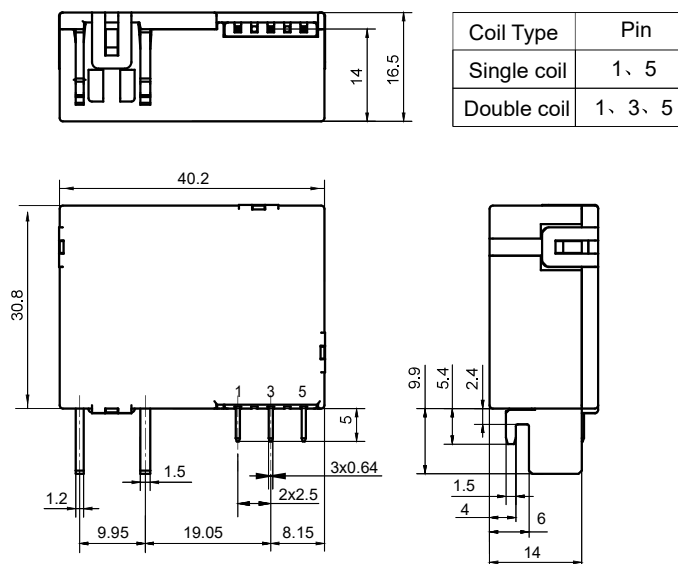

Wiring Diagram

Standard polarity

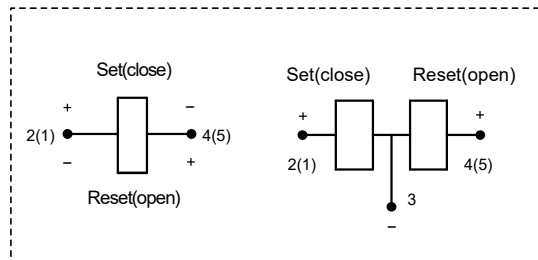

Reverse polarity

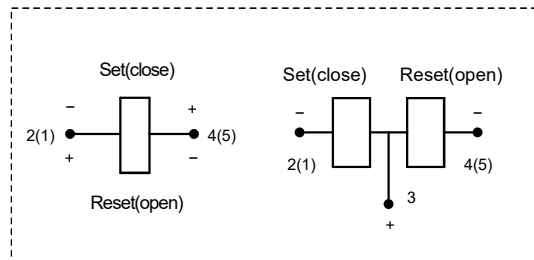

CAUTIONS

- Relay is on the "reset" or "set" status when delivery, with the consideration of shock risen from transit and relay mounting, relay would be changed to "set" or "reset" status, therefore, when application (connecting the power supply), please reset the relay to "set" or "reset" status on request.
- In order to maintain "set" or "reset" status, energized voltage applied across the coil should reach the rated voltage, impulse width should be 5 times more than "set" or "reset" time. Do not energize voltage to "set" coil and "reset" coil simultaneously. And also long energized time (more than 1 min) should be avoided.
- The terminals of relay without twisted copper wire can not be tin-soldered, can not be moved willfully.
- Because of the dust proof structure and custom made external terminal, the recommended storage time shall not longer than 6 months. Please pay attention to the storage environment. To ensure contact reliability, we will keep contact status be open when delivery if no special required by customer.

Disclaimer

The specification is for reference only. Specifications subject to change without notice.

We could not evaluate all the performance and all the parameters for every possible application. Thus the user should be in a right position to choose the suitable product for their own application. If there is any query, please contact Hongfa for the technical service. However, it is the user's responsibility to determine which product should be used only.