

Features

- Nominal current: 10A
- Nominal Voltage: 220V
- Insulation resistance: $\geq 1000\text{M}\Omega$ (normal), $\geq 100\text{M}\Omega$ (damp)
- Dielectric strength: 2000V 1min
- Ambient temperature: $-40^{\circ}\text{C}\sim 85^{\circ}\text{C}$
- Electrical endurance: ≥ 500 次
- Installation hole torque: Relays and sockets $0.45\text{N}\cdot\text{m}$,
On socket structure $0.6\text{N}\cdot\text{m}$

MODEL NAMING RULES

S470M	1	1
Applicable relay types	Mounting Hardware 1: Positioning with M3 screw	Contact type 1: Wiring Size Specification: $(0.75\sim 1.5)\text{mm}^2$

OUTLINE DIMENSIONS, WIRING DIAGRAM AND PC BOARD LAYOUT

Outline Dimensions

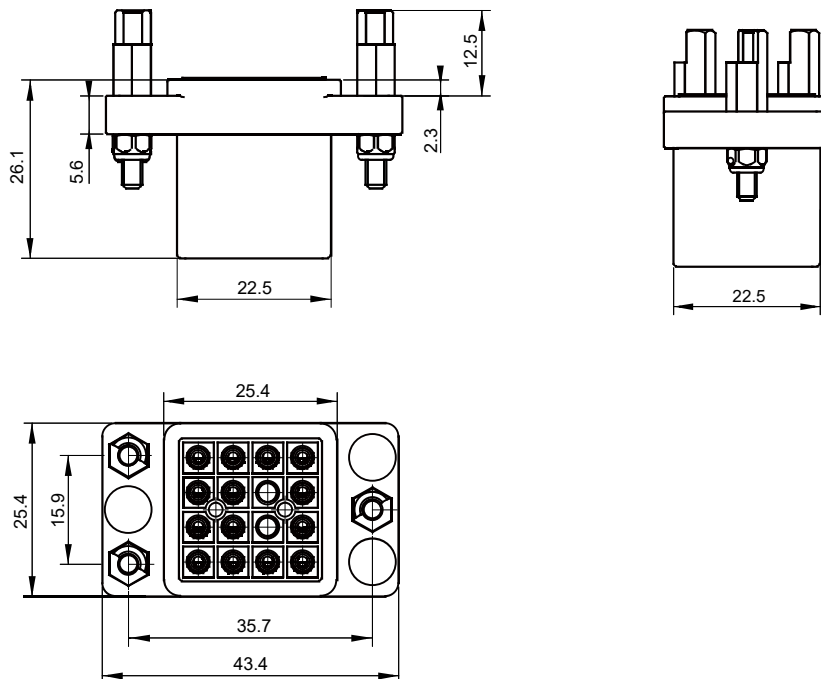

HONGFA RELAY

ISO9001、IATF16949、ISO14001、OHSAS18001、IECQ QC 080000 CERTIFIED

2023 Rev. 1.00

PCB Layout

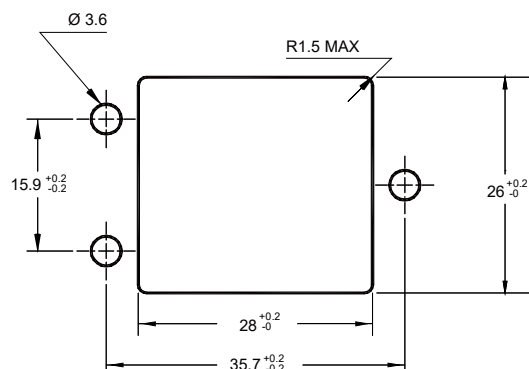

Wiring diagram
(Standardized subway)

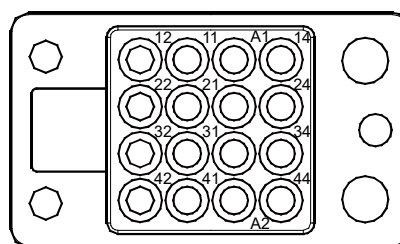

Installation Diagram

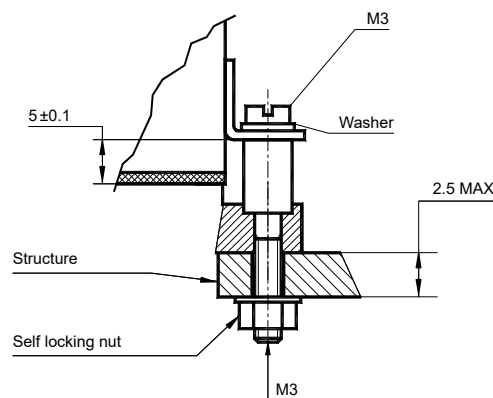
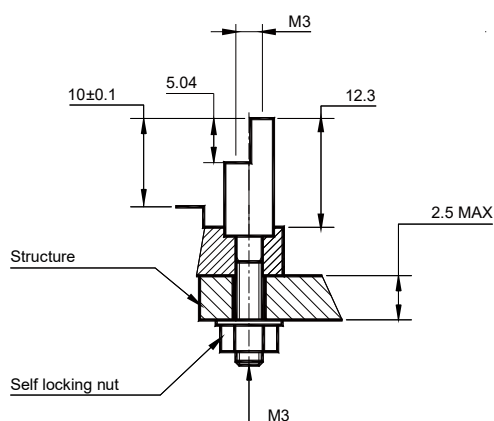

Things to be noticed when selecting sockets:

1. Please choose suitable relay socket according to the actual mounting environment, relay contact poles and terminal layout. If there is any query on selection, please contact Hongfa for the technical service.
2. Socket which can be mounted with markers is furnished with a marker; as for other related components, they should be selected separately. Please do give clear indication of the types of relay sockets and related components you choose while placing order.
3. The above is only an example of typical socket and related component type which is suitable to HF18FZ relay. If you have any special requirements, please contact us.
4. Main outline dimension, outline dimension > 50mm, tolerance should be $\pm 1\text{mm}$; $20\text{mm} < \text{outline dimension} \leq 50\text{mm}$, tolerance should be $\pm 0.5\text{mm}$; $5\text{mm} < \text{outline dimension} \leq 20\text{mm}$, tolerance should be $\pm 0.4\text{mm}$; outline dimension $\leq 5\text{mm}$, tolerance should be $\pm 0.3\text{mm}$.
5. DIN rail mounting: recommend to use standard rail $35 \times 7.5 \times 1\text{mm}$, $35 \times 15 \times 1\text{mm}$.

Disclaimer

The specification is for reference only. See to "Terminology and Guidelines" for more information. Specifications subject to change without notice. We could not evaluate all the performance and all the parameters for every possible application. Thus the user should be in a right position to choose the suitable product for their own application. If there is any query, please contact Hongfa for the technical service. However, it is the user's responsibility to determine which product should be used only.

© Xiamen Hongfa Electroacoustic Co., Ltd. All rights of Hongfa are reserved.