

HF32FV

SUBMINIATURE INTERMEDIATE POWER RELAY



File No.:E134517



File No.:40012204



File No.:CQC14002120720



Features

- 5A switching capability
- Dielectric strength 4kV (between coil and contacts)
- 1 Form A configurations
- Standard PCB layout
- Plastic sealed and flux proofed types available
- UL insulation system: Class F
- Product in accordance to IEC 60335-1 available
- Meet reinforce insulation
- Relow soldering version available
- Halogen-free products are available

CONTACT DATA

| | | |
|-------------------------------|----------------------------------|--|
| Contact arrangement | 1A | |
| Contact resistance 1) | 100mΩ max.(at 1A 6VDC) | |
| Contact material | AgSnO ₂ , AgCdO, AgNi | |
| Contact rating (Res. load) | Standard | Sensitive |
| | 5A 250VAC 5A 30VDC | 3A 250VAC 3A 30VDC |
| Max. switching voltager | 277VAC / 30VDC | |
| Max. switching current | 5A | 3A |
| Max. switching power | 1385VA / 150W | 831VA / 90W |
| Mechanical endurance | 1 x 10 ⁷ OPS | |
| Electrical endurance | Standard | 1 x 10 ⁵ OPS (5A 250VAC Resistive load, at room temp., 1s on 9s off) 5 x 10 ⁴ OPS (5A 250VAC Resistive load, at 85°C, 1s on 9s off) |
| | Sensitive | 1 x 10 ⁵ OPS (3A 250VAC Resistive load, at room temp., 1s on 9s off) 5 x 10 ⁴ OPS (3A 250VAC Resistive load, at 85°C, 1s on 9s off) |

Notes: 1) The data shown above are initial values.

CHARACTERISTICS

| | | |
|--------------------------------|------------------------------|-----------------------|
| Insulation resistance | 1000MΩ (at 500VDC) | |
| Dielectric strength | Between coil & contacts | 4000VAC 1min |
| | Between open contacts | 1000VAC 1min |
| Surge withstand voltage | 6kV(1.2 / 50μs) | |
| Operate time (at rated. volt.) | 8ms max. | |
| Release time (at rated. volt.) | 5ms max. | |
| Shock * resistance | Functional | 294m/s ² |
| | Destructive | 980m/s ² |
| Vibration resistance * | Functional | 10Hz to 55Hz 1.5mm DA |
| Humidity | 5% to 85% RH | |
| Ambient oprating temperature | -40°C to 105°C | |
| Termination | PCB | |
| Unit weight | Approx. 6g | |
| Construction | Plastic sealed, Flux proofed | |

Notes:1) The data shown above are initial values.

2) For working environment temperature > 85°C, please contact with Hongfa.

COIL

| | |
|------------|--|
| Coil power | Standard: Approx. 450mW; Sensitive: Approx. 200mW |
|------------|--|

COIL DATA

at 23°C

Standard Type

| Nominal Voltage VDC | Pick-up Voltage VDC max.1) | Drop-out Voltage VDC min. 1) | Max. Voltage VDC*2) | Coil Resistance Ω |
|---------------------|----------------------------|------------------------------|---------------------|-------------------|
| 3 | 2.25 | 0.15 | 3.9 | 20 x (1±10%) |
| 5 | 3.75 | 0.25 | 6.5 | 55 x (1±10%) |
| 6 | 4.50 | 0.30 | 7.8 | 80 x (1±10%) |
| 9 | 6.75 | 0.45 | 11.7 | 180 x (1±10%) |
| 12 | 9.00 | 0.60 | 15.6 | 320 x (1±10%) |
| 18 | 13.5 | 0.90 | 23.4 | 720 x (1±10%) |
| 24 | 18.0 | 1.20 | 31.2 | 1280 x (1±10%) |
| 48 | 36.0 | 2.40 | 62.4 | 5120 x (1±10%) |

Sensitive Type

| Nominal Voltage VDC | Pick-up Voltage VDC max.1) | Drop-out Voltage VDC min. 1) | Max. Voltage VDC*2) | Coil Resistance Ω |
|---------------------|----------------------------|------------------------------|---------------------|-------------------|
| 3 | 2.25 | 0.15 | 4.5 | 45 x (1±10%) |
| 5 | 3.75 | 0.25 | 7.5 | 125 x (1±10%) |
| 6 | 4.50 | 0.30 | 9.0 | 180 x (1±10%) |
| 9 | 6.75 | 0.45 | 13.5 | 400 x (1±10%) |
| 12 | 9.00 | 0.60 | 18.0 | 720 x (1±10%) |
| 18 | 13.5 | 0.90 | 27.0 | 1600 x (1±10%) |
| 24 | 18.0 | 1.20 | 36.0 | 2800 x (1±10%) |
| 48 | 36.0 | 2.40 | 72.0 | 11520 x (1±10%) |

Notes: 1) The data shown above are initial values.

2)* Maximum voltage refers to the maximum voltage which relay coil could endure in a short period of time.



HONGFA RELAY

ISO9001, IATF16949, ISO14001, ISO45001, IECQ QC 080000, ISO/IEC 27001 CERTIFIED

2025 Rev. 1.00

SAFETY APPROVAL RATINGS

| | | |
|--------|--------------------|--|
| UL/CUL | AgSnO ₂ | 5A 277VAC /250VAC General Use at 40°C 5A 277VAC/250VAC General Use at 85°C 5A 30VDC General Use at 85°C 300W 120VAC Tungsten at 40°C 1/4HP 250VAC at 85°C 3A 277VAC/250VAC General Use (Sensitive) at 85°C 5A 277VAC/250VAC Resistive at 105°C 3A 30VDC General Use (Sensitive) at 85°C 3A 277VAC/250VAC General Use (Sensitive) at 105°C TV-3 120VAC at 40°C |
| | AgCdO | 5A 277VAC/250VAC General Use at 85°C 5A 30VDC Resistive at 85°C |
| | AgNi | 5A 277VAC/250VAC General Use at 85°C 5A 30VDC Resistive at 85°C 3A 30VDC Resistive (Sensitive) at 85°C 3A 277VAC/250VAC General Use (Sensitive) at 85°C 5A 277VAC/250VAC General Use at 105°C 3A 277VAC/250VAC General Use (Sensitive) at 105°C |
| VDE | AgSnO ₂ | 250VAC 4(2) Inductive load at 85°C 5A 30VDC Resistive at 85°C 5A 277VAC/250VAC Resistive at 85°C 3A 277VAC/250VAC Resistive at 85°C 3A 30VDC Resistive (Sensitive) at 85°C 5A 277VAC/250VAC Resistive at 105°C 3A 277VAC/250VAC Resistive (Sensitive) at 105°C |
| | AgCdO | 5A 277VAC/250VAC Resistive at 85°C 5A 30VDC Resistive at 85°C |
| | AgNi | 5A 277VAC/250VAC Resistive at 85°C 3A 277VAC/250VAC Resistive (Sensitive) at 85°C 5A 277VAC/250VAC Resistive at 105°C 3A 277VAC/250VAC Resistive (Sensitive) at 105°C |
| CQC | AgSnO ₂ | 5A 277VAC/250VAC Resistive at 85°C 5A 30VDC Resistive at 85°C 3A 277VAC/250VAC Resistive (Sensitive) at 85°C 5A 277VAC/250VAC Resistive at 105°C 3A 277VAC/250VAC Resistive (Sensitive) at 105°C |
| | AgCdO | 5A 277VAC/250VAC Resistive at 85°C 5A 30VDC Resistive at 85°C |
| | AgNi | 5A 277VAC/250VAC Resistive at 85°C 5A 30VDC Resistive at 85°C 3A 277VAC/250VAC Resistive (Sensitive) at 85°C |

Notes: 1) All values unspecified are at room temperature.

2) Only typical loads are listed above. Other load specifications can be available upon request.

ORDERING INFORMATION

| | | | | | | | | |
|-------------------------------------|-----------------------------------|----|-------------------|---|---------------|---------|---|-------|
| | HF32FV / | 12 | -H | S | L | T | F | (XXX) |
| Type | | | | | | | | |
| Coil voltage | 3, 5, 6, 9, 12, 18, 24, 48VDC | | | | | | | |
| Contact arrangement | H: 1 Form A | | | | | | | |
| Construction ¹⁾²⁾ | S: Plastic sealed | | Nil: Flux proofed | | | | | |
| Coil power | L: Sensitive ³⁾ | | Nil: Standard | | | | | |
| Contact material | T: AgSnO ₂ | | Nil: AgCdO | | | 3: AgNi | | |
| Insulation standard | F: Class F | | | | | | | |
| Customer special code ⁴⁾ | XXX: Customer special requirement | | | | Nil: Standard | | | |

- Notes:** 1) We recommend flux proofed types for a clean environment (free from contaminations like H₂S, SO₂, NO₂, dust, etc.).
2) Contact is recommended for suitable condition and specifications if water cleaning or surface process is involved in assembling relays on PCB.
3) Sensitive loading: 3A.
4) The customer special requirement express as special code after evaluating by Hongfa. e.g.(335) stands for product in accordance to IEC 60335-1 (GWT); e.g.(590) stands for product in accordance to TV-3 loading,only for standard type.
5) Two packing methods available: paper box package, tube package,Standard tube packing length is 553mm. Any special requirement needed, please contact us for more details.
6) For products that should meet the explosion-proof requirements of "IEC 60079 series",please note [Ex] after the specification while placing orders.Not all products have explosion-proof certification,so please contact us if necessary, in order to select the suitable products.

OUTLINE DIMENSIONS, WIRING DIAGRAM AND PC BOARD LAYOUT

Unit: mm

Outline Dimensions

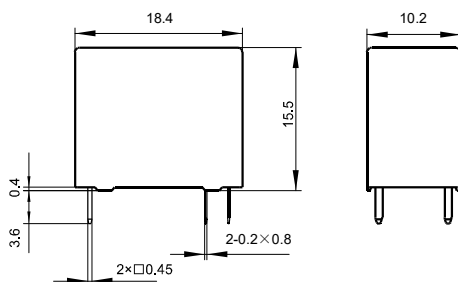

Wiring Diagram

(Bottom view)

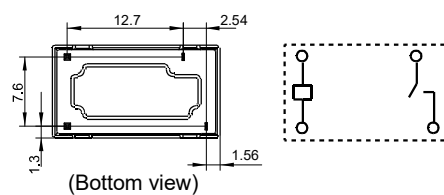

PCB Layout

(Bottom view)

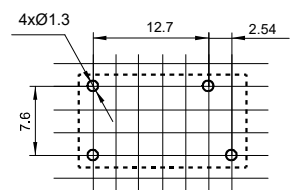

Remark: 1) *The additional tin top is max. 1mm.

2) In case of no tolerance shown in outline dimension: outline dimension ≤1mm, tolerance should be ±0.2mm; outline dimension >1mm and ≤5mm, tolerance should be ±0.3mm; outline dimension >5mm, tolerance should be ±0.4mm.

3) The tolerance without indicating for PCB layout is always ±0.1mm.

4) The width of the gridding is 2.54mm.

CHARACTERISTIC CURVES

MAXIMUM SWITCHING POWER

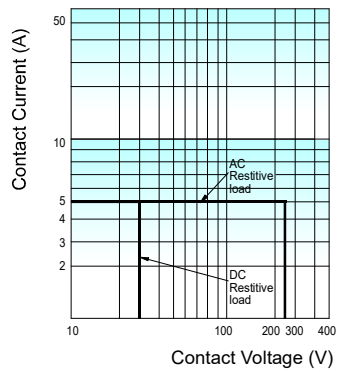

ENDURANCE CURVE

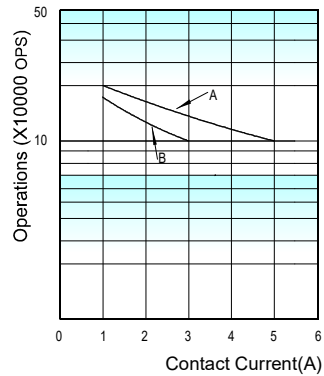

COIL TEMPERATURE RISE

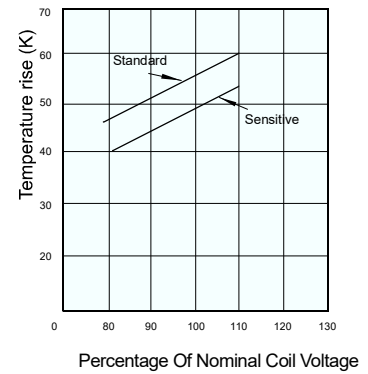

Remark:

- Curve A: standard
Curve B: sensitive
- Testing conditions:
Standard: flux proofed, resistive load,
5A 250VAC, at room temp. 1s on 9s off.
Sensitive: flux proofed, resistive load,
3A 250VAC, at room temp. 1s on 9s off.

Testing conditions:

Standard: 5A at 85°C.
Sensitive: 3A at 85°C
Mounting distance: 5mm

Disclaimer

The specification is for reference only. See to "Terminology and Guidelines" for more information. Specifications subject to change without notice. We could not evaluate all the performance and all the parameters for every possible application. Thus the user should be in a right position to choose the suitable product for their own application. If there is any query, please contact Hongfa for the technical service. However, it is the user's responsibility to determine which product should be used only.