

HFE82P-150B

DIRECT CURRENT RELAY



RoHS compliant

Features

- Hermetically sealed with ceramic brazing technology, without risk of arc leaking, no fire or explosion.
- Filled with hydrogen gas to prevent oxidation and burn out of contacts; Low and stable contact resistance, contact block with IP67 compliant.
- 150A continuous carry current capability at 85°C.
- Meet the requirements for handling abnormal operating conditions and can switch under 10-times overcurrent.
- Max. insulation resistance up to 1000MΩ (1000 VDC), dielectric strength (between contact and coil) up to 4kV, IEC60664-1 compliant.
- Loads have polarity requirements, while coil drives are non-polarized.
- Applied to the energy storage, safety conformity of ≤1000V.

CONTACT DATA

Contact arrangement	1 Form A
Contact resistance ¹⁾	≤0.2mΩ(at 150A)
Contact rating	150A
Mechanical endurance	2 x 10 ⁵ ops
Max. switching voltage	1000 VDC
Max. breaking current	1500A(800VDC 0.6s on) 1 op
Max. switching power	180kW
Electrical endurance ²⁾	Making:2x10 ⁴ ops(150A 37.5VDC Inrush current:400A,RC=1ms)
	Breaking:6000 ops(60A 750VDC)
	Breaking:1000 ops(150A 450VDC)
	Breaking:500 ops(150A 1000VDC)
Current carrying ³⁾ endurance	150A: Cont.
	180A: 2h
	225A: 15min
	320A: 2min
	400A: 60s
	600A: 20s
	900A: 8s

Notes:1) The above values are the initial values.

2) Unless otherwise specified, the temperature of electrical endurance is at 23°C and the on-off ratio is 0.6s:5.4s.

The coil was not connected to the surge suppression device during the test. Please note that the use of a well-connected diode will greatly increase the release time of the relay, resulting in a reduced lifetime.

3) Ambient temperature is at 85°C and cross-sectional area of conductor is 50mm² min. See Fig. Endurance Capacity Curve for more information.

COIL DATA

23°C

Rated Voltage VDC	Pick-up Voltage VDC	Drop-out Voltage VDC	Coil power W
12	≤9.6	≥1	6
24	≤19.2	≥2	6

CHARACTERISTICS

Insulation resistance	1000MΩ(1000 VDC)	
Dielectric strength	Between open contacts	4000 VAC 1min
	Between contact and coil	3000 VAC 1min
Operate time (at rated volt.)	≤30ms	
Release time (at rated volt.)	≤10ms	
Shock resistance	Functional	98m/s ²
	Destructive	490m/s ²
Vibration resistance	10Hz ~ 55Hz 49m/s ²	
Humidity	5% ~ 85% RH	
Ambient temperature	-40°C ~ 85°C	
Load terminal structure	M6 internal thread	
Unit weight	12V: Approx.315±20g	
	24V: Approx.320±20g	
Outline Dimensions	81.0x39.0x70.0mm	
	81.7x39.5x69.6mm	

Note:The above values are the initial values measured at room temperature.



HONGFA RELAY

ISO9001、IATF16949、ISO14001、ISO45001、IECQ QC 080000、ISO/EC 27001 CERTIFIED 2026 Rev. 1.00

ORDERING INFORMATION

Type	HFE82	P	-150	B/	XXX-	XX-	H	C	5	Y	(XXX)
Application	P: PV and energy storage										
Contact rating	150: 150A										
Series breakdown	B: B series										
Load voltage	Nil: 450 VDC 800: 800 VDC 1000: 1000 VDC										
Coil voltage	12: 12 VDC 24: 24 VDC										
Contact arrangement	H: 1 Form A										
Coil terminal structure	C: Connector										
Load terminal structure	5: Internal thread										
Mounting	Nil: Vertical mounting Y: Horizontal mounting										
Special code ¹⁾	XXX: Customer requirement(used when customers have special requirements)										

Note: 1) The customer special requirement express as special code after evaluating by Hongfa.

OUTLINE DIMENSIONS, MOUNTING HOLE, TERMINAL ARRANGEMENT

Unit: mm

Outline Dimensions

HFE82P-150B/XXX-XX-HC5

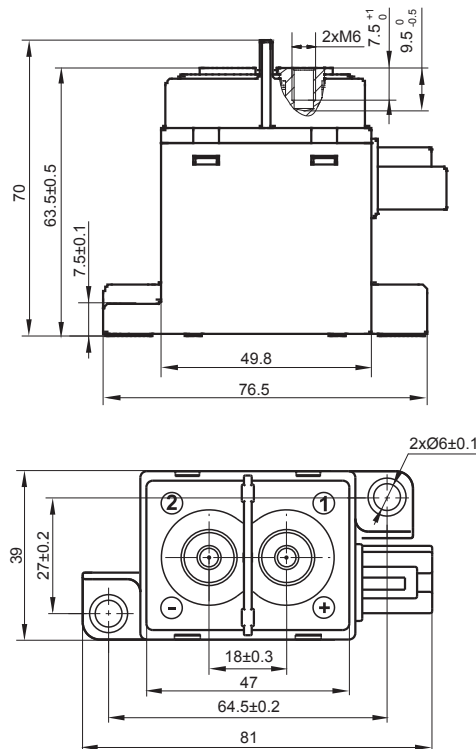

Tolerance(mm):

Outline dimension	Tolerance
≤10	±0.3
> 10 and ≤50	±0.5
> 50	±0.8

OUTLINE DIMENSIONS, MOUNTING HOLE, TERMINAL ARRANGEMENT

Unit: mm

Outline Dimensions

HFE82P-150B/XXX-XX-HC5Y

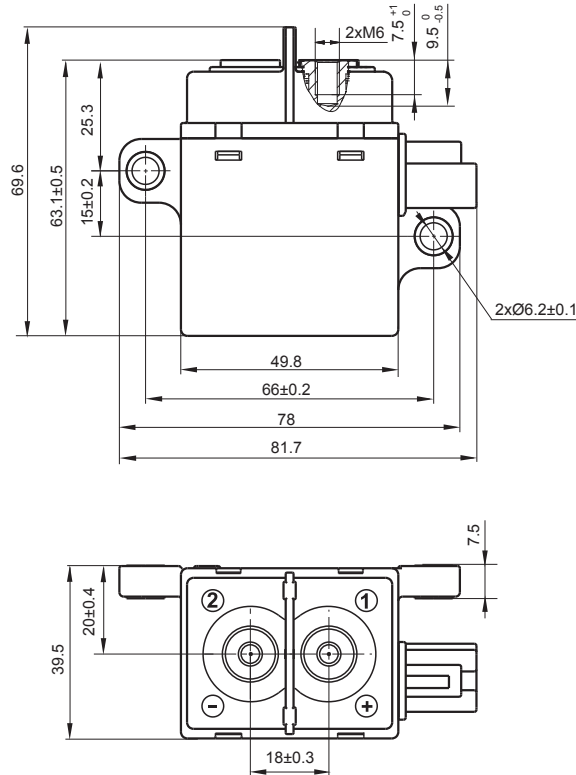

Tolerance(mm):

Outline dimension	Tolerance
≤10	±0.3
> 10 and ≤50	±0.5
> 50	±0.8

Mounting Hole

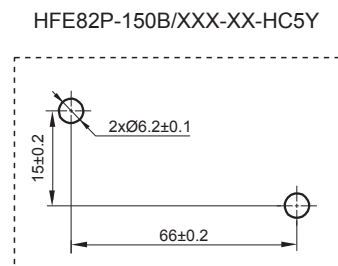
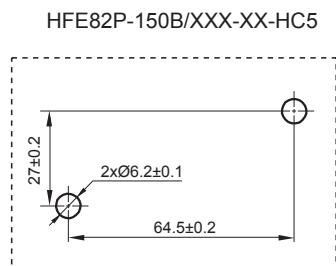

Terminal Arrangement

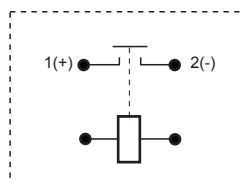

Note: The load side has polarity,
No polarity on the coil side.

C : Connector

(Configured by customers: THB:0435series、Yazaki:7283-1020)

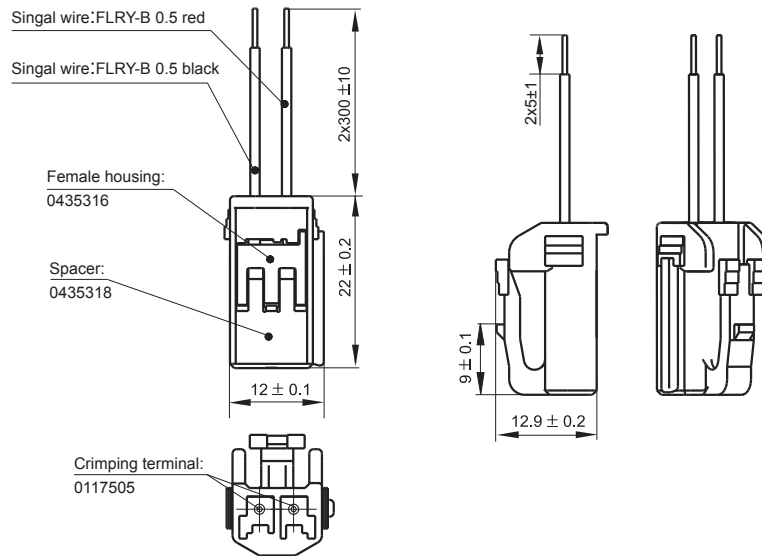

CHARACTERISTIC CURVES

Breaking Capability Curve (Resistive Load)

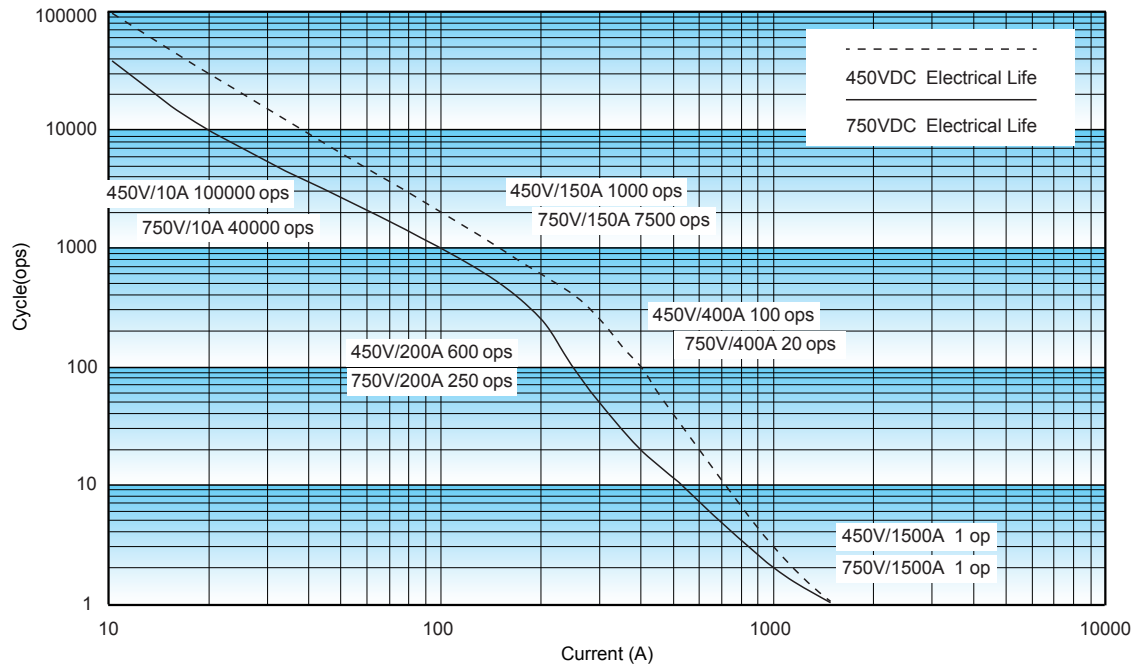

Notes:

1. The data is for reference only.
2. Conductor cross-sectional area $\geq 50\text{mm}^2$.
3. The data is measured under the resistive load ($L/R \leq 1\text{ms}$), the duty cycle: 0.6s on: 5.4s off, ambient temperature: 23°C .
The values may change according to the load type, duty cycle, and environmental conditions. therefore, it is recommended to confirm the values under actual load.
4. The curve is based on the standard relay measurement data. It is necessary to consider system voltage, electromagnetic compatibility of the copper busbar, the influence of installation stress when designing the system. If you have any questions, please contact hongfa technology team.

Pick-up Voltage / Drop-out Voltage Curve

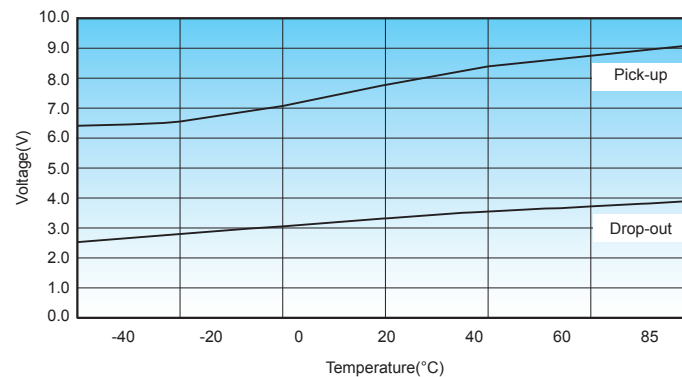

Notes:

1. The above values are sampling values for reference only.
2. The rated voltage of the sample coil is 12VDC.
3. The sampling ambient temperature is $-40^\circ\text{C} \sim 85^\circ\text{C}$.
4. The curve is based on the standard relay measurement data. It is necessary to consider system voltage, electromagnetic compatibility of the copper busbar, the influence of installation stress when designing the system. If you have any questions, please contact hongfa technology team.

CHARACTERISTIC CURVES

Endurance Capacity Curve

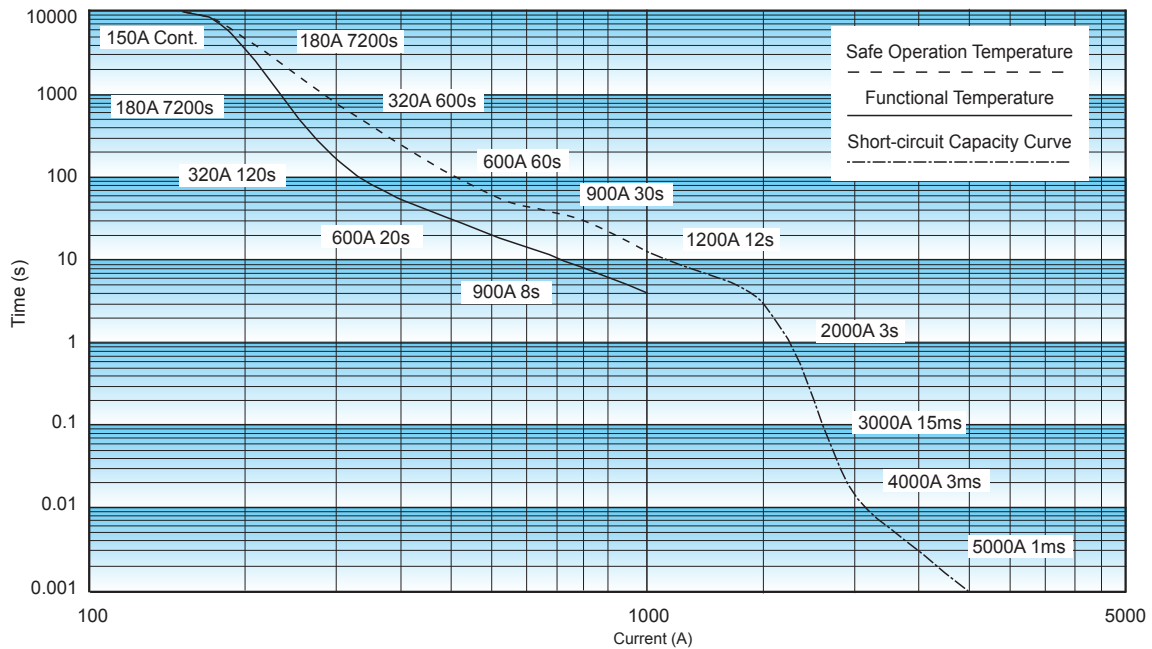

Notes:

1. The data is for design reference, it shall be verified as actual for model selection and fuse mating of short-circuit current test.
- 2.1. The upper limit of the safe operation temperature set by this curve is 180 °C, and the upper limit of the functional temperature is 130 °C; The long-term service temperature of the material is 130 °C, the short-term service temperature of the material after aging is 180 °C;
- 2.2. It is recommended that the upper temperature limit shall not exceed 130 °C when long time operation. It may also cause relay failure, if the safe temperature limit of 180 °C is exceeded;
- 2.3. There is a risk of fire and explosion in conditions beyond the safety curve. In case of similar conditions, the relay shall be replaced in time;
- 2.4. The ambient temperature is 85 °C for safe operation and function, and for current above 1200A, the temperature is room temperature with cross-sectional area $\geq 50\text{mm}^2$.
- 3.1. Even if it is below the safety curve when the current $\geq 1200\text{A}$, the relay is likely to be stuck during current carrying. If there is a break beyond the specification, fire and explosion may occur;
- 3.2. The contact is likely to bounce off when the current $\geq 3000\text{A}$. If the fuse cannot be fused in time, the relay may explode and may be ignited if the arc continues to burn after the explosion;
- 3.3. When the over-current is higher than 6000A, the levitation of contacts will possibly happen, and the circuit current cannot rise continuously. The relay may explode if the fuse blown cannot happen in time and fire may be caused if the arc continues after the explosion.
4. The curve is the measured data of standard relays. System voltage, electromagnetic compatibility and installation stress of copper busbar should be taken into consideration in system design. If any questions, please contact with our technical support for further consultation.

CAUTIONS

1、 In case of looseness, please use collars when mounting the relay. The torque beyond the range may cause damage.

Mounting for load terminal				Mounting for relay body	
Mounting way	Torque requirement	Hole dia. of copper bus bar	Thickness of copper bus bar	Mounting way	Torque requirement
M6 Screw	5N·m ~ 6N·m	Ø6.0mm~Ø6.5mm	2mm~3mm	M5 Screw	3N·m ~ 4N·m

2. Please tighten the load terminal of relay vertically with preloading first when installing. Repeat locking is not recommended.

3. If any special screws and nuts, such as nylok, are used when installing, it is recommended to contact and confirm with Hongfa.

4. If any special installation requirements, such as a downward direction, multi busbar connection, are involved, it is recommended to contact and confirm with Hongfa.

5. Please avoid adhering to foreign matter such as grease on the terminal lead end and please use the conductor with min. cross-sectional area of 50mm², otherwise it may cause the abnormal heating of the terminal part.

6. Cautions of mounting for relay body:

Unrecommended method

Large opening of mounting plate at customer-side.

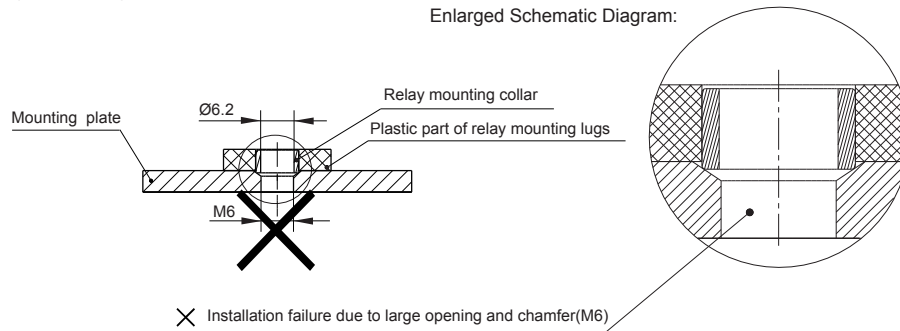

Recommended method

Appropriate opening (M5) of mounting plate at customer-side.

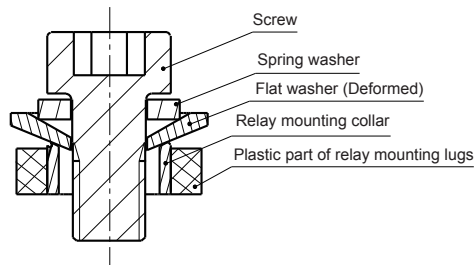
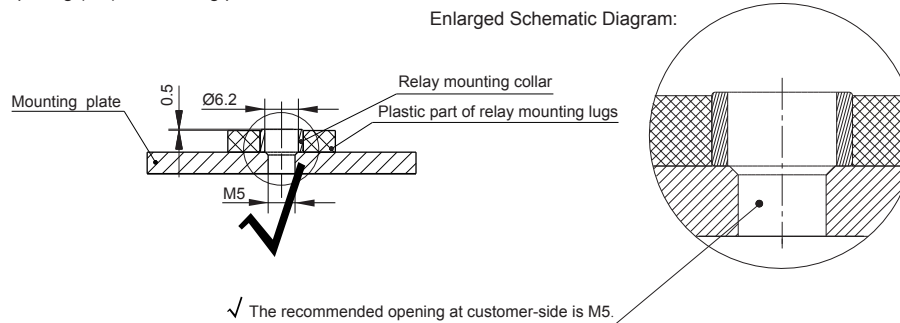

When use M5 screw, the thickness and strength of the washer needs to be guaranteed or it may deform and burst the cover.

Disclaimer

The specification is for reference only. See to "Terminology and Guidelines" for more information. Specifications subject to change without notice. We could not evaluate all the performance and all the parameters for every possible application. Thus the user should be in a right position to choose the suitable product for their own application. If there is any query, please contact Hongfa for the technical service. However, it is the user's responsibility to determine which product should be used only.

© Xiamen Hongfa Electroacoustic Co.,Ltd. All rights of Hongfa are reserved.