

HF18FF-G-AS/HF18FH-G-AS

RELAY MODULE



File No.:
E253370(Socket)
E133481(Relay)



File No.: R 50147087(Relay)



File No.:
CQC09002030026(DC Relay)
CQC09002030027(AC Relay)

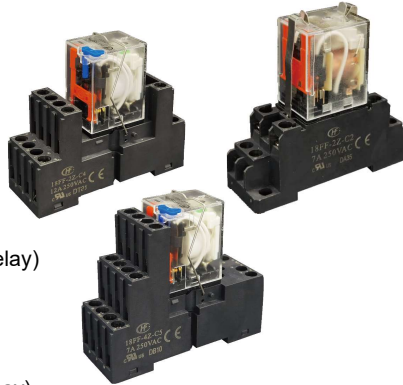

Features

- 5000VAC insulation, 1000MΩ insulation resistance
- DIN rail or Screw mounting type available
- With 2 or 3 sets of changeover contact options
- Products with finger protection are available
- Gold plated contact product selection

RoHS compliant

CONTACT DATA

| | |
|-------------------------------|--|
| Contact arrangement | 2Z,3Z |
| Contact rating (Res. load) | 12A 250VAC/30VDC(2Z) 10A 250VAC/30VDC(3Z) |
| Max. switching voltage | 250VAC/30VDC |
| Max. switching current | 12A (2Z), 10A (3Z) |

CHARACTERISTICS

| | | |
|-------------------------------|-------------------------|---|
| Insulation resistance | | 1000MΩ (500VAC) |
| Dielectric strength(RMS) | Between coil & contacts | 1500VAC 1min |
| | Between open contacts | 1000VAC 1min |
| | Between contact sets | 1500VAC 1min |
| Operate time (at nomi. volt.) | | 20ms max. |
| Release time (at nomi. volt.) | | 15ms (DCtype max.) 25ms (DC with freewheeling diode type max.) 25ms (ACtype max.) |
| Humidity (RH) | | 5% to 85%RH |
| Ambient temperature | | -40℃ to 70℃ |

COIL DATA

23°C

| Nominal Voltage VDC | Pick-up Voltage VDC max. | Drop-out Voltage VDC min | Max. Allowable Voltage VDC |
|---------------------|--------------------------|--------------------------|----------------------------|
| 5 | 4.0 | 0.50 | 5.5 |
| 6 | 4.8 | 0.60 | 6.6 |
| 9 | 7.2 | 0.90 | 9.9 |
| 13 | 9.6 | 1.20 | 13.2 |
| 21 | 16.8 | 2.10 | 23.1 |
| 24 | 19.2 | 2.40 | 26.4 |
| 30 | 24.0 | 3.00 | 33.0 |
| 36 | 28.8 | 3.60 | 39.6 |
| 48 | 38.4 | 4.80 | 52.8 |
| 60 | 48.0 | 6.00 | 66.0 |
| 110 | 80.0 | 11.0 | 121.0 |
| 125 | 100.0 | 12.5 | 137.5 |
| 220 | 176.0 | 22.0 | 242.0 |

| Nominal Voltage VAC | Pick-up Voltage VAC max. | Drop-out Voltage VAC min | Max. Allowable Voltage VAC |
|---------------------|--------------------------|--------------------------|----------------------------|
| 6 | 4.80 | 1.80 | 6.6 |
| 12 | 9.60 | 3.60 | 13.2 |
| 24 | 19.2 | 7.20 | 26.4 |
| 36 | 28.8 | 10.8 | 39.6 |
| 48 | 38.4 | 14.4 | 52.8 |
| 60 | 48.0 | 18.0 | 66.0 |
| 110 | 80.0 | 33.0 | 121.0 |
| 120 | 88.0 | 36.0 | 132.0 |
| 220 | 160.0 | 66.0 | 242.0 |
| 240 | 176.0 | 72.0 | 264.0 |
| 277 | 221.6 | 83.1 | 304.7 |



HONGFA RELAY

ISO9001, IATF16949, ISO14001, ISO45001, IECQ QC 080000, ISO/IEC 27001 CERTIFIED

2024 Rev. 1.00

ORDERING INFORMATION

| | |
|--|--|
| HF18FF-AS / <input type="checkbox"/> <input type="checkbox"/> - <input type="checkbox"/> Z 1 <input type="checkbox"/> <input type="checkbox"/> <input type="checkbox"/> - <input type="checkbox"/> - H <input type="checkbox"/> (XXX) | |
| Relay module | HF18FF: Without button type HF18FH: With button type G: High load type AS: Module |
| Coil Power | A: AC (50HZ or 60HZ) Nil: DC |
| Relay coil voltage | DC: 005~220VDC AC: 006~277VAC |
| Contact arrangement | 2Z: 2 Form C 3Z: 3 Form C |
| Installation method | 1: Plug-in |
| Contact material | 3: AgNi T: AgSnO ₂ |
| Contact plating | Nil: No gold plated G: Au plated |
| Component code | Nil: Without component D: With LED J: Freewheeling diode DJ: With LED, freewheeling diode |
| Matching socket | C2(734), C4(734), C5(734) for 2Z C5(734) for 4Z |
| Matching retaining clip | H2 for C2 H5 for C4,C5 |
| Special code | XXX: The customer special requirement Nil: Standard type |

OUTLINE DIMENSIONS, WIRING DIAGRAM

Unit: mm

Outline Dimensions

Wiring Diagram(Bottom view)

HF18FF-G-AS/☐☐-2Z1☐☐☐-C2(734)-H2

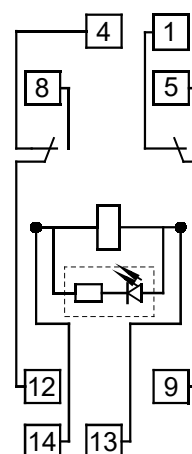
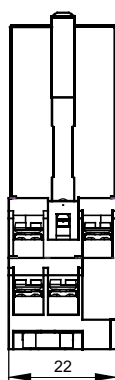
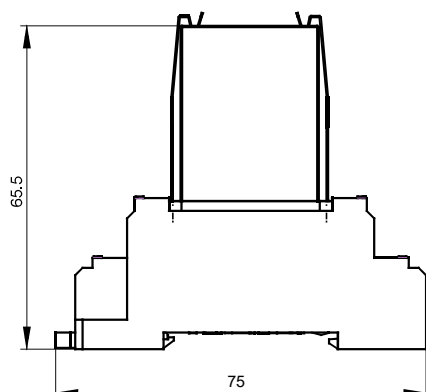

OUTLINE DIMENSIONS, WIRING DIAGRAM

Unit: mm

Outline Dimensions

Wiring Diagram(Bottom view)

HF18FF-G-AS/□□-2Z1□□□-C4(734)-H5

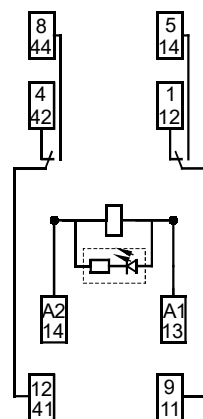
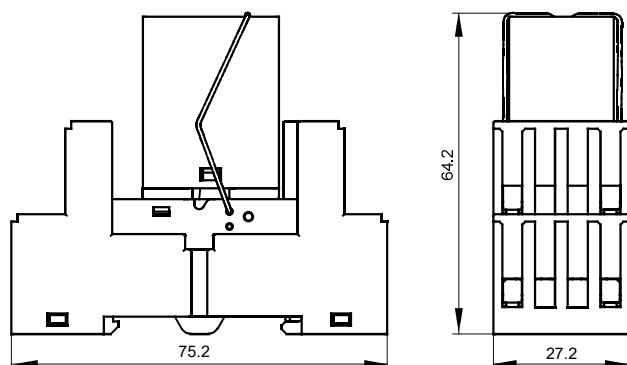

HF18FF-G-AS/□□-2Z1□□□-C5(734)-H5

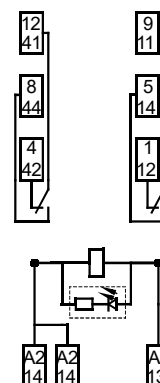
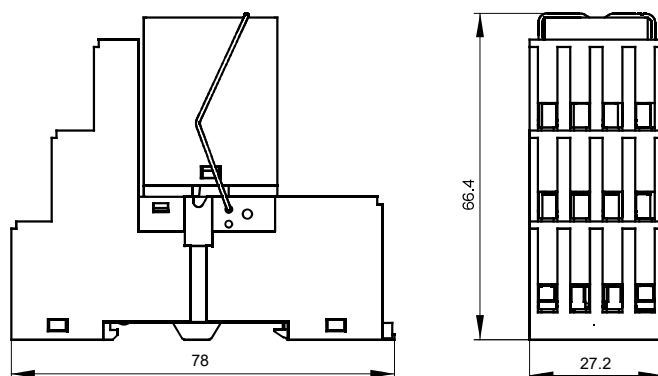

HF18FH-G-AS/□□-2Z1□□□-C4(734)-H5

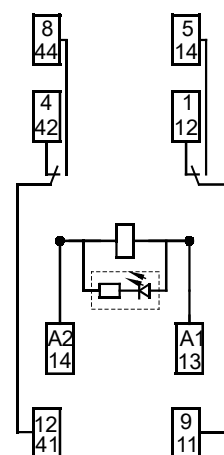
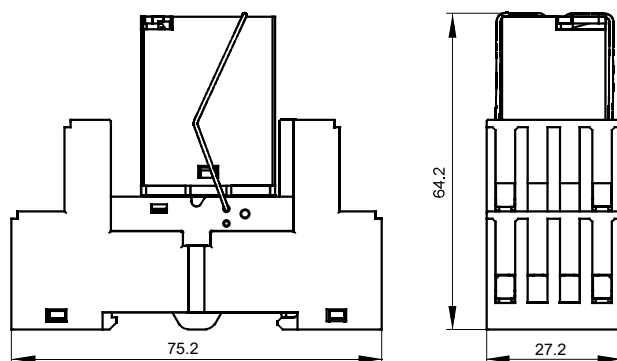

OUTLINE DIMENSIONS, WIRING DIAGRAM

Unit: mm

Outline Dimensions

Wiring Diagram(Bottom view)

HF18FH-G-AS/□□-2Z1□□□-C5(734)-H5

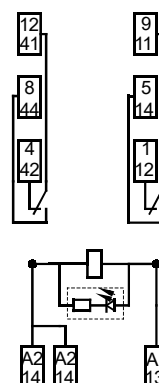
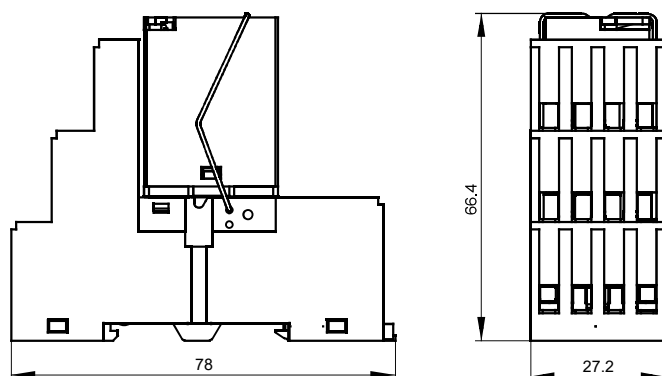

HF18FF-G-AS/□□-3Z1□□□-C5(734)-H5

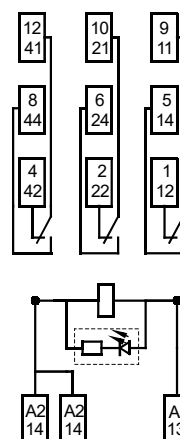
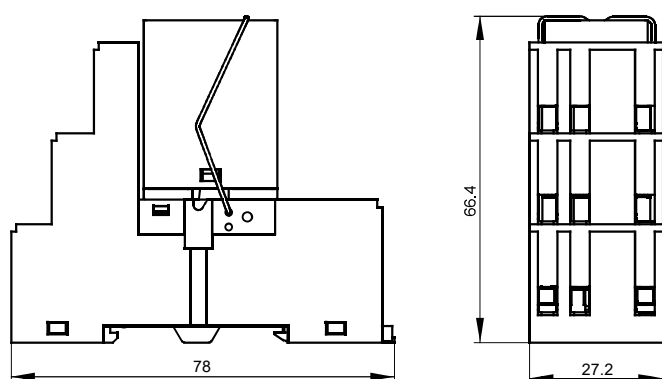

HF18FH-G-AS/□□-3Z1□□□-C5(734)-H5

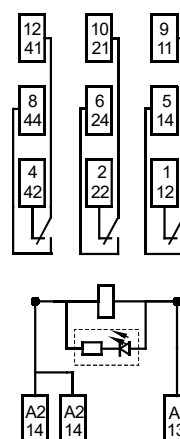
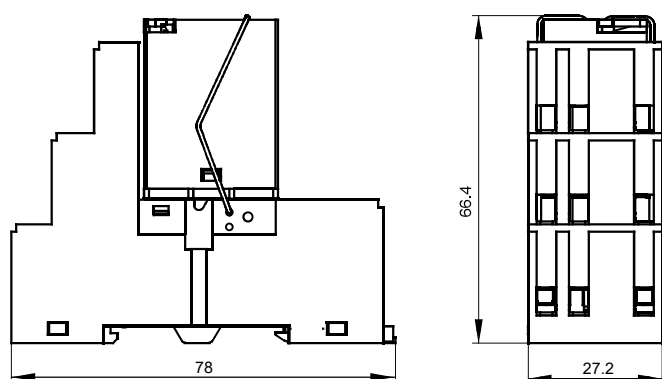

COMPONENT ORDERING INFORMATION

Gasket screw Relay

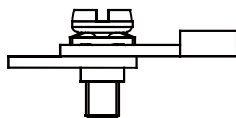

| P/N | Module type | Relay type | Socket type | Retainer type |
|-----|-----------------------------------|---------------------|---------------------|---------------|
| — | HF18FF-G-AS/012-2Z13D-C2(734)-H2 | HF18FF-G/012-2Z13D | 18FF-2Z-C2 (734) | 18FF-H2 |
| — | HF18FF-G-AS/024-2Z13D-C2(734)-H2 | HF18FF-G/024-2Z13D | | |
| — | HF18FF-G-AS/A110-2Z13D-C2(734)-H2 | HF18FF-G/A110-2Z13D | | |
| — | HF18FF-G-AS/A220-2Z13D-C2(734)-H2 | HF18FF-G/A220-2Z13D | | |

Screw terminal

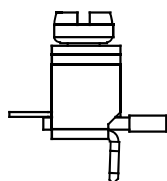

| P/N | Module type | Relay type | Socket type | Retainer type |
|-----|-----------------------------------|---------------------|---------------------|---------------|
| —— | HF18FF-G-AS/012-2Z13D-C4(734)-H5 | HF18FF-G/012-2Z13D | 18FF-2Z-C4 (734) | 18FF-H5 |
| —— | HF18FF-G-AS/024-2Z13D-C4(734)-H5 | HF18FF-G/024-2Z13D | | |
| —— | HF18FF-G-AS/A110-2Z13D-C4(734)-H5 | HF18FF-G/A110-2Z13D | | |
| —— | HF18FF-G-AS/A220-2Z13D-C4(734)-H5 | HF18FF-G/A220-2Z13D | | |
| —— | HF18FF-G-AS/012-2Z13D-C5(734)-H5 | HF18FF-G/012-2Z13D | 18FF-2Z-C5 (734) | |
| —— | HF18FF-G-AS/024-2Z13D-C5(734)-H5 | HF18FF-G/024-2Z13D | | |
| —— | HF18FF-G-AS/A110-2Z13D-C5(734)-H5 | HF18FF-G/A110-2Z13D | | |
| —— | HF18FF-G-AS/A220-2Z13D-C5(734)-H5 | HF18FF-G/A220-2Z13D | | |
| —— | HF18FF-G-AS/012-3Z13D-C5(734)-H5 | HF18FF-G/012-3Z13D | 18FF-3Z-C5 (734) | |
| —— | HF18FF-G-AS/024-3Z13D-C5(734)-H5 | HF18FF-G/024-3Z13D | | |
| —— | HF18FF-G-AS/A110-3Z13D-C5(734)-H5 | HF18FF-G/A110-3Z13D | | |
| —— | HF18FF-G-AS/A220-3Z13D-C5(734)-H5 | HF18FF-G/A220-3Z13D | | |
| —— | HF18FH-G-AS/012-2Z13D-C4(734)-H5 | HF18FH-G/012-2Z13D | 18FF-2Z-C4 (734) | |
| —— | HF18FH-G-AS/024-2Z13D-C4(734)-H5 | HF18FH-G/024-2Z13D | | |
| —— | HF18FH-G-AS/A110-2Z13D-C4(734)-H5 | HF18FH-G/A110-2Z13D | | |
| —— | HF18FH-G-AS/A220-2Z13D-C4(734)-H5 | HF18FH-G/A220-2Z13D | | |
| | HF18FH-G-AS/012-2Z13D-C5(734)-H5 | HF18FH-G/012-2Z13D | 18FF-2Z-C5 (734) | |
| | HF18FH-G-AS/024-2Z13D-C5(734)-H5 | HF18FH-G/024-2Z13D | | |
| | HF18FH-G-AS/A110-2Z13D-C5(734)-H5 | HF18FH-G/A110-2Z13D | | |
| | HF18FH-G-AS/A220-2Z13D-C5(734)-H5 | HF18FH-G/A220-2Z13D | | |
| | HF18FH-G-AS/012-3Z13D-C5(734)-H5 | HF18FH-G/012-3Z13D | 18FF-3Z-C5 (734) | |
| | HF18FH-G-AS/024-3Z13D-C5(734)-H5 | HF18FH-G/024-3Z13D | | |
| | HF18FH-G-AS/A110-3Z13D-C5(734)-H5 | HF18FH-G/A110-3Z13D | | |
| | HF18FH-G-AS/A220-3Z13D-C5(734)-H5 | HF18FH-G/A220-3Z13D | | |

Note: Please contact us for any information.

Precautions when choosing components:

1. The main external dimension, when the external dimension > 50mm, the tolerance is ±1mm; When the 20mm dimensions are between 50mm, the tolerance is ±0.5mm; When the 5mm < dimensions are between ≤ 20mm, The tolerance is ±0.4mm, and when the overall dimension is ≤ 5mm, the tolerance is ±0.3mm;
2. For rail installation, it is recommended to use DIN standard 35×7.5×1, 35×15×1 standard rails.

Disclaimer

The specification is for reference only. See to "Terminology and Guidelines" for more information. Specifications subject to change without notice. We could not evaluate all the performance and all the parameters for every possible application. Thus the user should be in a right position to choose the suitable product for their own application. If there is any query, please contact Hongfa for the technical service. However, it is the user's responsibility to determine which product should be used only.

© Xiamen Hongfa Electroacoustic Co., Ltd. All rights of Hongfa are reserved.