

14FF Series

Push-In Relay Socket



ORDERING INFORMATION

Type	14FF	-2Z	-C10
Contact arrangement	2Z: 2 Form C		
Termination & mounting	C10: Push-In C10/P: Push-in with button		

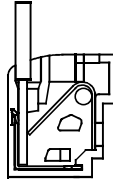



File No.: E253370

CHARACTERISTICS

Type	Nominal Voltage	Nominal Current	Ambient Temperature	Dielectric Strength min.	Screw Torque	Wire Strip Length	Unit weight	Min. package qty.	IP
14FF-2Z-C10	300VAC/DC	10A	-40°C~70°C	5000 Vrms	—	10mm	Approx.36g	10	IP 20
14FF-2Z-C10/P	300VAC/DC	10A	-40°C~70°C	5000 Vrms	—	10mm	Approx.37g	10	IP 20

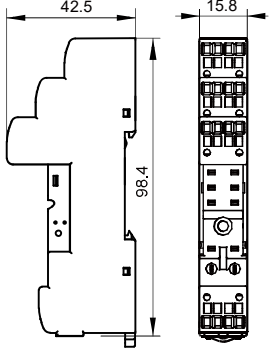
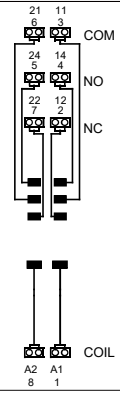
OUTLINE DIMENSIONS, WIRING DIAGRAM AND PC BOARD LAYOUT

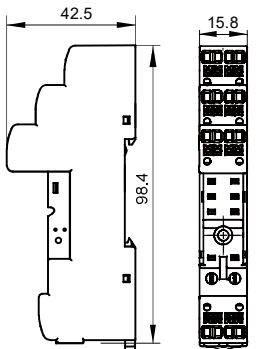
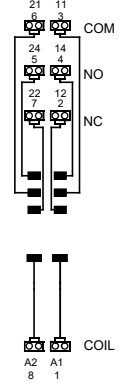
Socket (If need accesscry,please order with type.)	Outline Dimensions	PCB Layout	Accessory Available
14FF-2Z-C10 	 (Top View)		Retainer: 14FF-H4 14FF-H6 14FF-H7 14FF-H8 14FF-H10 Marker: 14FF-M1 Plug-in module: HFAA~HFHU
14FF-2Z-C10/P 	 (Top View)		Retainer: 14FF-H4 14FF-H6 14FF-H7 14FF-H8 14FF-H10 Marker: 14FF-M1 Plug-in module: HFAA~HFHU

Notes: If need accesscry,please order with type.



HONGFA RELAY

ISO9001, IATF16949, ISO14001, ISO45001, IECQ QC 080000, ISO/IEC 27001 CERTIFIED

2024 Rev. 1.00

DIMENSION OF RELATED ACCESSORY (AVAILABLE)

Unit: mm

Retainer

14FF-H4 (Plastic retainer)

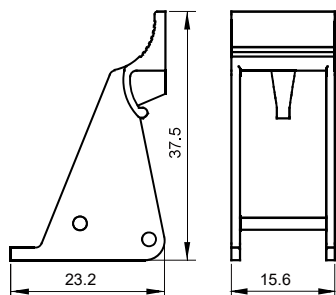

Applicable for HF115F/115F-A etc..

14FF-H6 (Plastic retainer)

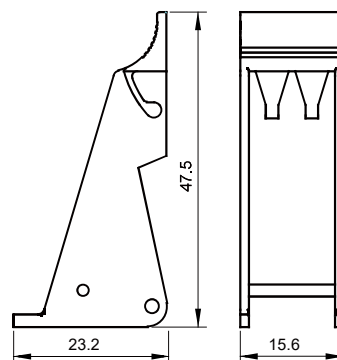

Applicable for HF115FP, HF140FF-G etc..

14FF-H7 (metallic retainer)

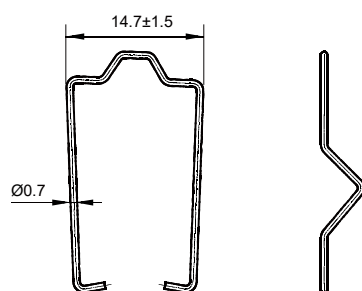

Applicable for HF115F/115F-A etc..

14FF-H8 (metallic retainer)

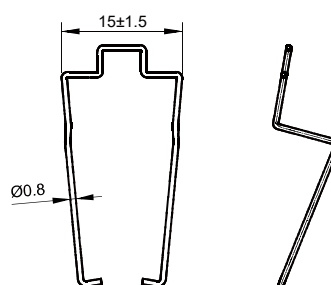

Applicable for HF115FP, HF14FW,
HF140FF-G etc..

14FF-H10 (metallic retainer)

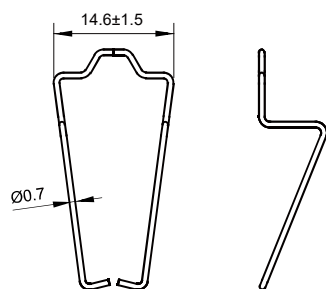

Applicable for HF158F-V etc..

DIMENSION OF RELATED ACCESSORY (AVAILABLE)

Unit: mm

Marker

14FF-M1

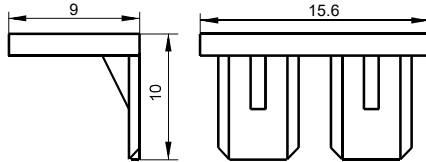

SELECTION OF PARTS

Type of Relay	Socket	Retainer	Marker	Module
HFA2/□□□-□□□□□□	14FF-2Z-A1	14FF-H11	—	—
	14FF-2Z-C2(767)	14FF-H6	14FF-M1	HFAA~HFHU
	14FF-2Z-C10			
HF115F/□□□-2□□□□□	14FF-2Z-A1	14FF-H1/H9	—	—
	14FF-2Z-C2	14FF-H4	14FF-M1	HFAA~HFHU
	14FF-2Z-C3			
	14FF-2Z-C4			
	14FF-2Z-C10			
HF115F-A/□□□-2□□□□□	14FF-2Z-A1	14FF-H1/H9	—	—
	14FF-2Z-C2	14FF-H4	14FF-M1	HFAA~HFHU
	14FF-2Z-C3			
	14FF-2Z-C4			
	14FF-2Z-C10			
HF115F/□□□-1□□3□□	14FF-2Z-A1	14FF-H1/H9	—	—
	14FF-2Z-C2	14FF-H4	14FF-M1	HFAA~HFHU
	14FF-2Z-C3			
	14FF-2Z-C4			
	14FF-2Z-C10			
HF115F-A/□□□-1□□3□□	14FF-2Z-A1	14FF-H1/H9	—	—
	14FF-2Z-C2	14FF-H4	14FF-M1	HFAA~HFHU
	14FF-2Z-C3			
	14FF-2Z-C4			
	14FF-2Z-C10			

SELECTION OF PARTS

Type of Relay	Socket	Retainer	Marker	Module
HF115FP/□□□-□□□□	14FF-2Z-A1	14FF-H3/H11	—	—
	14FF-2Z-C3	14FF-H6	14FF-M1	HFAA~HFHU
	14FF-2Z-C4			
	14FF-2Z-C10			
HF115FK/□□-□□□□□	14FF-2Z-A1	14FF-H9	—	—
	14FF-2Z-C3	14FF-H4	14FF-M1	HFAA~HFHU
	14FF-2Z-C10			
HF158F-V/□□-H□□2T	14FF-2Z-A1	—	—	—
	14FF-2Z-C3	14FF-H10	14FF-M1	HFAA~HFHU
	14FF-2Z-C10			
HF158F/□□-□□3□	14FF-2Z-A1	14FF-H1/H9	—	—
	14FF-2Z-C3	14FF-H4	14FF-M1	HFAA~HFHU
	14FF-2Z-C10			
HF14FF/□□□-□□□□□	14FF-1Z-A1	14FF-H2	—	—
HF14FW/□□□-□□□□□	14FF-2Z-A1	14FF-H3	—	—
HF140FF-G/□□□-□□□□□	14FF-2Z-A1	14FF-H3	—	—
	14FF-2Z-C2(767)	14FF-H6	14FF-M1	HFAA~HFHU
	14FF-2Z-C10			

Precautions For Use

For your personal safety and the normal operation of the equipment, as well as to prevent fire, please note the following issues:

1. The rated current of the socket should be no less than the rated current of the relay.
2. Sockets are required to be firmly fixed to prevent the wiring from loosening and affecting the quality of wiring.
3. Be sure to disconnect power to the outlet before installation, disassembly, wiring, maintenance and inspection.
4. Prevent foreign objects such as wire shavings from falling inside this product when wiring.
5. Be sure to install the relay in place, and use accessories such as retainer if necessary to improve contact reliability. Do not use with incomplete connections.
6. Be sure to observe the relay ratings and do not overload the relay.
7. Before selecting a relay, make sure that the drive voltage matches the relay excitation voltage.

Applicable conductor cross section

solid wire	1×0.5/0.75/1.0/1.5/2.5 mm ²	
	2×0.5/0.75/1.0/1.5 mm ²	
Multi-stranded wire	Multi-stranded wire without standard sleeve	1×0.5/0.75/1.0/1.5/2.5 mm ²
		2×0.5/0.75/1.0/1.5 mm ²
	Multi-stranded wire with standard sleeve	1×0.5/0.75/1.0/1.5 mm ²
		2×0.5/0.75/1.0 mm ²

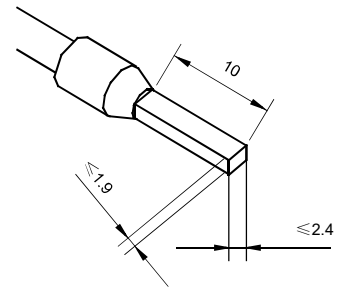

Precautions For Use

Regarding push in socket

- The screwdriver insertion hole must not be wired.
 - When inserting the screwdriver into the hole, please insert it at an angle.
 - Do not twist or wiggle the screwdriver when it is in the hole, as this may cause damage the socket.
 - Do not forcibly bend or pull on the wire. Otherwise it may result broken wire.
 - Do not insert more than one wires into one wiring hole.
 - To prevent smoke and fire from the wiring material, check the power supply rating and that the wire sleeves used are in accordance with DIN 46228-4.
- The conductors used comply with GB/T 5023.3-2008 (IEC 60227-3) standard.

Recommended Wires	Film peel (when bar terminals are not used)
0.5~2.5mm ² /AWG20~14	≥10mm

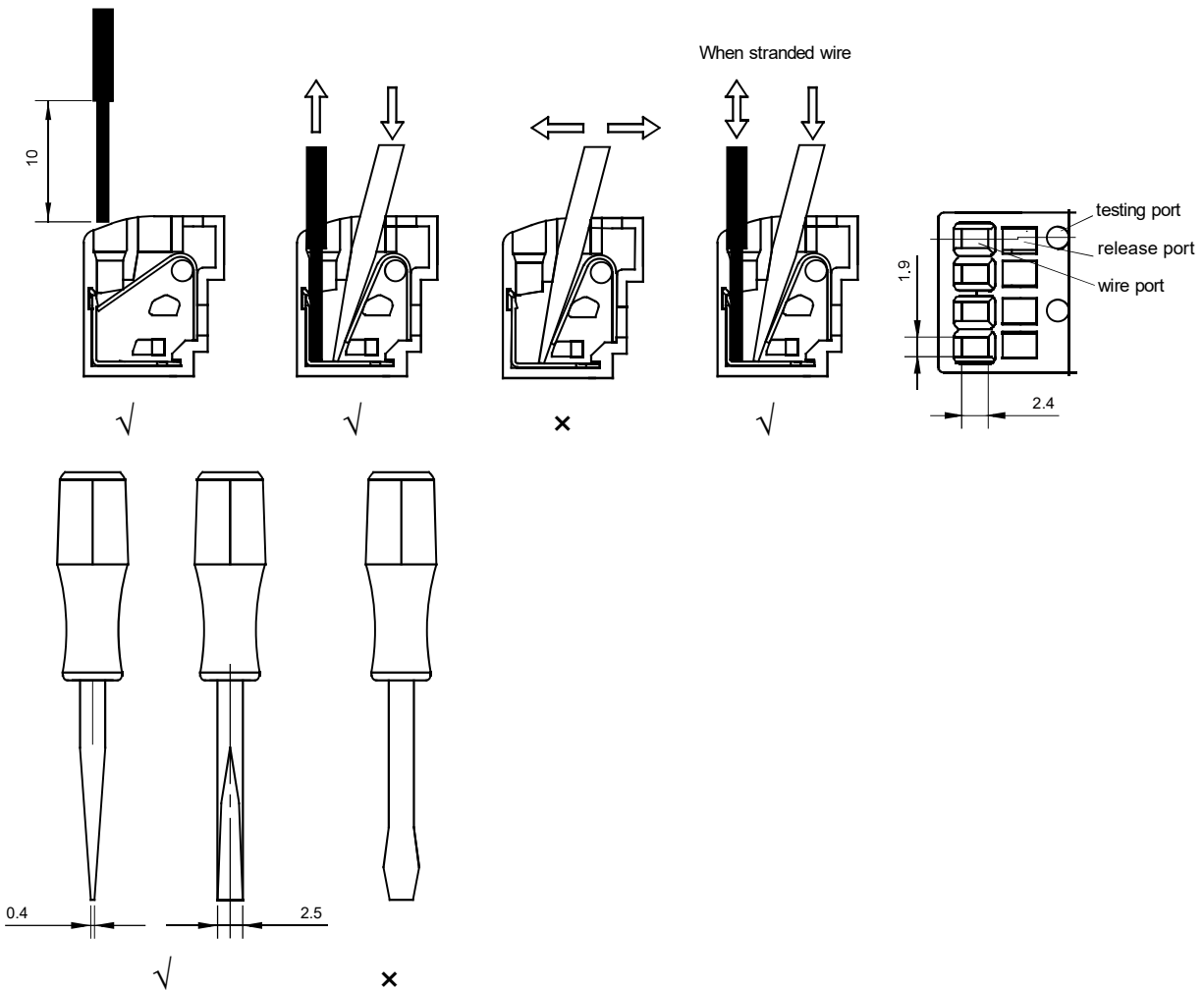

Things to be noticed when selecting sockets:

1. Please choose suitable relay socket according to the actual mounting environment, relay contact poles and terminal layout. If there is any query on selection, please contact Hongfa for the technical service;
2. Relevant accessories must be selected separately. Please indicate the model of the selected accessories when ordering;
3. Main outline dimension, outline dimension > 50mm, tolerance should be ±1mm; 20mm < outline dimension ≤ 50mm, tolerance should be ±0.5mm; 5mm < outline dimension ≤ 20mm, tolerance should be ±0.4mm, outline dimension ≤ 5mm, tolerance should be ±0.3mm;
4. DIN rail mounting: recommend to use standard rail 35×7.5×1mm, 35×15×1mm. When installed vertically, the coil terminal at the bottom please .

Disclaimer

The specification is for reference only. See to "Terminology and Guidelines" for more information. Specifications subject to change without notice. We could not evaluate all the performance and all the parameters for every possible application. Thus the user should be in a right position to choose the suitable product for their own application. If there is any query, please contact Hongfa for the technical service. However, it is the user's responsibility to determine which product should be used only.

© Xiamen Hongfa Electroacoustic Co., Ltd. All rights of Hongfa are reserved.