

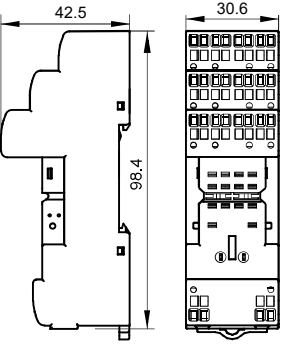

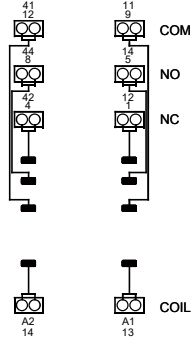

OUTLINE DIMENSIONS, WIRING DIAGRAM AND PC BOARD LAYOUT

Socket (If need accessory, please order with type.)	Outline Dimensions	PCB Layout	Accessory Available
<p>18FF-2Z-C10/P</p> 			<p>Retainer: 18FF-H4 18FF-H5</p> <p>Jumper: 18FF-J2</p> <p>Marker: 18FF-M1</p> <p>Plug-in module: HFAA~HFHU</p>
<p>18FF-4Z-C10</p> 			<p>Retainer: 18FF-H4 18FF-H5</p> <p>Jumper: 18FF-J2</p> <p>Marker: 18FF-M1</p> <p>Plug-in module: HFAA~HFHU</p>
<p>18FF-4Z-C10/P</p> 			<p>Retainer: 18FF-H4 18FF-H5</p> <p>Jumper: 18FF-J2</p> <p>Marker: 18FF-M1</p> <p>Plug-in module: HFAA~HFHU</p>

Notes: If need accessory, please order with type.

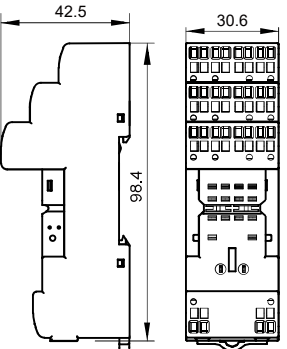
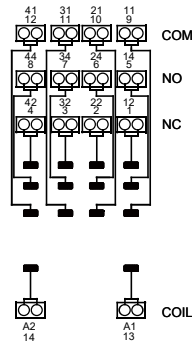
DIMENSION OF RELATED ACCESSORY (AVAILABLE)

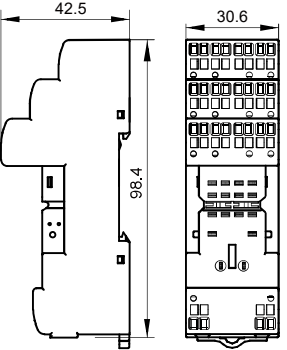
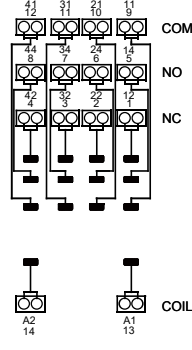
Unit: mm

Retainer

18FF-H4(Plastic retainer)

18FF-H5(Metallic retainer)

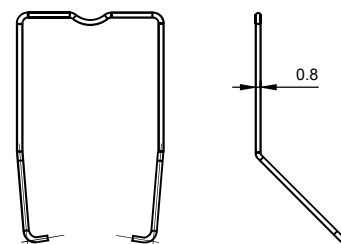
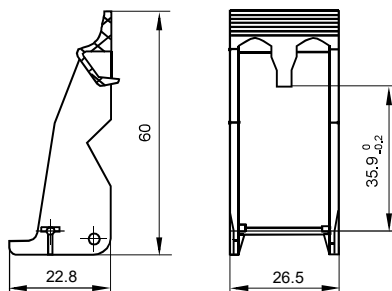

DIMENSION OF RELATED ACCESSORY (AVAILABLE)

Unit: mm

Jumper

18FF-J2

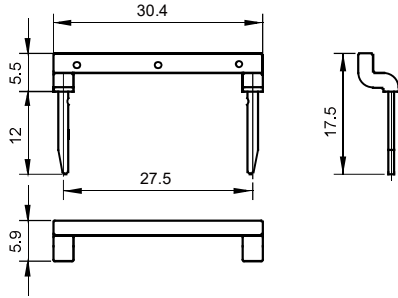

Marker

18FF-M1

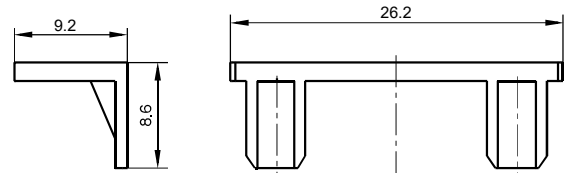

SELECTION OF PARTS

Type of Relay	Mounting termination	Socket	Retainer	Marker	Module
HF18FF/□□-2Z1□□□	without button	18FF-2Z-A2	18FF-H1	—	—
		18FF-2Z-C2			
		18FZ-2Z-C2			
		18FF-2Z-C4	18FF-H4/H5/H8	18FF-M1	HFAA~HFHU
		18FF-2Z-C5			
		18FF-2Z-C8		18FF-M3	
		18FF-2Z-C9			
		18FF-2Z-C10			
18FF-2Z-C10/P					
18FF-3Z-C4		18FF-M1			
18FF-3Z-C5					
HF18FF/□□-4Z1□□□		18FF-4Z-A2	18FF-H1	—	—
		18FF-4Z-C1			
		18FF-4Z-C2	18FF-H2		
		18FZ-4Z-C2			
		18FF-4Z-C4	18FF-H4/H5	18FF-M1	HFAA~HFHU
	18FF-4Z-C5				
	18FF-4Z-C8	18FF-M3			
	18FF-4Z-C9				
	18FF-4Z-C10				
	18FF-4Z-C10/P	18FF-M1			

SELECTION OF PARTS

Type of Relay	Mounting termination	Socket	Retainer	Marker	Module
HF18FH/□□-2Z1□□□	with button	18FF-2Z-C2	18FF-H3	—	—
		18FZ-2Z-C2			
		18FF-2Z-C4	18FF-H4/H5/H8	18FF-M1	HFAA~HFHU
		18FF-2Z-C5			
		18FF-2Z-C8			
		18FF-2Z-C9		18FF-M3	
		18FF-2Z-C10			
		18FF-2Z-C10/P		18FF-M1	
		18FF-3Z-C4			
		18FF-3Z-C5			
18FF-3Z-C5	18FF-M1				
18FF-4Z-C5					
18FF-4Z-C8	18FF-M3				
18FF-4Z-C9					
18FF-4Z-C10	18FF-M1				
18FF-4Z-C10/P					
HF18FF-G/□□-2Z1□□□	without button	18FF-2Z-C2(734)	18FF-H2/H3	—	—
HF18FF-G/□□-3Z1□□□		18FF-2Z-C4(734)	18FF-H4/H5/H8	18FF-M1	HFAA~HFHU
		18FF-2Z-C5(734)			
		18FF-3Z-C5(734)			
HF18FF-G/□□-2Z1□□□	with button	18FF-2Z-C2(734)	18FF-H3	—	—
HF18FF-G/□□-3Z1□□□		18FF-2Z-C4(734)	18FF-H4/H5/H8	18FF-M1	HFAA~HFHU
		18FF-2Z-C5(734)			
		18FF-3Z-C5(734)			
HF18FZ/□□-2Z□□□1/2□	without button	18FF-2Z-A2	18FF-H1		
		18FF-2Z-C2		—	—
		18FZ-2Z-C2			
		18FF-2Z-C4	18FF-H4/H5/H8	18FF-M1	HFAA~HFHU
		18FF-2Z-C5			
		18FF-2Z-C8		18FF-M3	
		18FF-2Z-C9			
		18FF-2Z-C10		18FF-M1	
18FF-2Z-C10/P					
HF18FZ/□□-4Z□□□1/2□	without button	18FF-4Z-A2	18FF-H1		
		18FF-4Z-C1	18FF-H2		
		18FF-4Z-C2		—	—
		18FZ-4Z-C2			
		18FF-4Z-C4	18FF-H4/H5/H8	18FF-M1	HFAA~HFHU
		18FF-4Z-C5			
		18FF-4Z-C8		18FF-M3	
		18FF-4Z-C9			
18FF-4Z-C10	18FF-M1				
18FF-4Z-C10/P					

SELECTION OF PARTS

Type of Relay	Mounting termination	Socket	Retainer	Marker	Module
HF18FZ/□□-2Z□□□3□	with button	18FF-2Z-C2	18FZ-H1	—	—
		18FZ-2Z-C2			
		18FF-2Z-C4	18FF-H4	18FF-M1	HFAA~HFHU
		18FF-2Z-C5			
		18FF-2Z-C8			
		18FF-2Z-C9			
		18FF-2Z-C10			
		18FF-2Z-C10/P			
HF18FZ/□□-4Z□□□3□		18FF-4Z-C1	18FZ-H1	—	—
		18FF-4Z-C2			
		18FZ-4Z-C2			
		18FF-4Z-C4	18FF-H4	18FF-M1	HFAA~HFHU
		18FF-4Z-C5			
		18FF-4Z-C8			
		18FF-4Z-C9			
		18FF-4Z-C10			
18FF-4Z-C10/P	18FF-M1				

Things to be noticed when selecting sockets:

1. Please choose suitable relay socket according to the actual mounting environment, relay contact poles and terminal layout. If there is any query on selection, please contact Hongfa for the technical service;
2. Relevant accessories must be selected separately. Please indicate the model of the selected accessories when ordering;
3. Main outline dimension, outline dimension > 50mm, tolerance should be ±1mm; 20mm < outline dimension ≤ 50mm, tolerance should be ±0.5mm; 5mm < outline dimension ≤ 20mm, tolerance should be ±0.4mm, outline dimension ≤ 5mm, tolerance should be ±0.3mm;
4. DIN rail mounting: recommend to use TH 35-7.5 mounting rails compliant with IEC 60715. For non-standard rail requirements, please consult our sales department for compatibility verification.

Precautions For Use

For your personal safety and the normal operation of the equipment, as well as to prevent fire, please note the following issues:

1. The rated current of the socket should be no less than the rated current of the relay.
2. Sockets are required to be firmly fixed to prevent the wiring from loosening and affecting the quality of wiring.
3. Be sure to disconnect power to the outlet before installation, disassembly, wiring, maintenance and inspection.
4. Prevent foreign objects such as wire shavings from falling inside this product when wiring.
5. Be sure to install the relay in place, and use accessories such as retainer if necessary to improve contact reliability. Do not use with incomplete connections.
6. Be sure to observe the relay ratings and do not overload the relay.
7. Before selecting a relay, make sure that the drive voltage matches the relay excitation voltage.

Applicable conductor cross section

solid wire	1×0.5/0.75/1.0/1.5/2.5 mm ²	
	2×0.5/0.75/1.0/1.5 mm ²	
Multi-stranded wire	Multi-stranded wire without standard sleeve	1×0.5/0.75/1.0/1.5/2.5 mm ²
		2×0.5/0.75/1.0/1.5 mm ²
	Multi-stranded wire with standard sleeve	1×0.5/0.75/1.0/1.5 mm ²
		2×0.5/0.75/1.0 mm ²

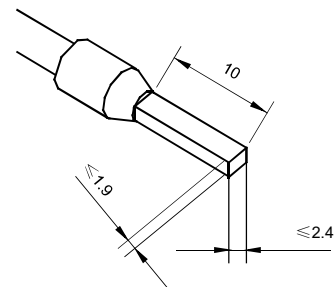

Precautions For Use

Regarding push in socket

- The screwdriver insertion hole must not be wired.
- When inserting the screwdriver into the hole, please insert it at an angle.
- Do not twist or wiggle the screwdriver when it is in the hole, as this may cause damage the socket.
- Do not forcibly bend or pull on the wire. Otherwise it may result broken wire.
- Do not insert more than one wires into one wiring hole.
- To prevent smoke and fire from the wiring material, check the power supply rating and that the wire sleeves used are in accordance with DIN 46228-4.

The conductors used comply with GB/T 5023.3-2008 (IEC 60227-3) standard.

Recommended Wires	Film peel (when bar terminals are not used)
0.5~2.5mm ² /AWG20~14	≥10mm

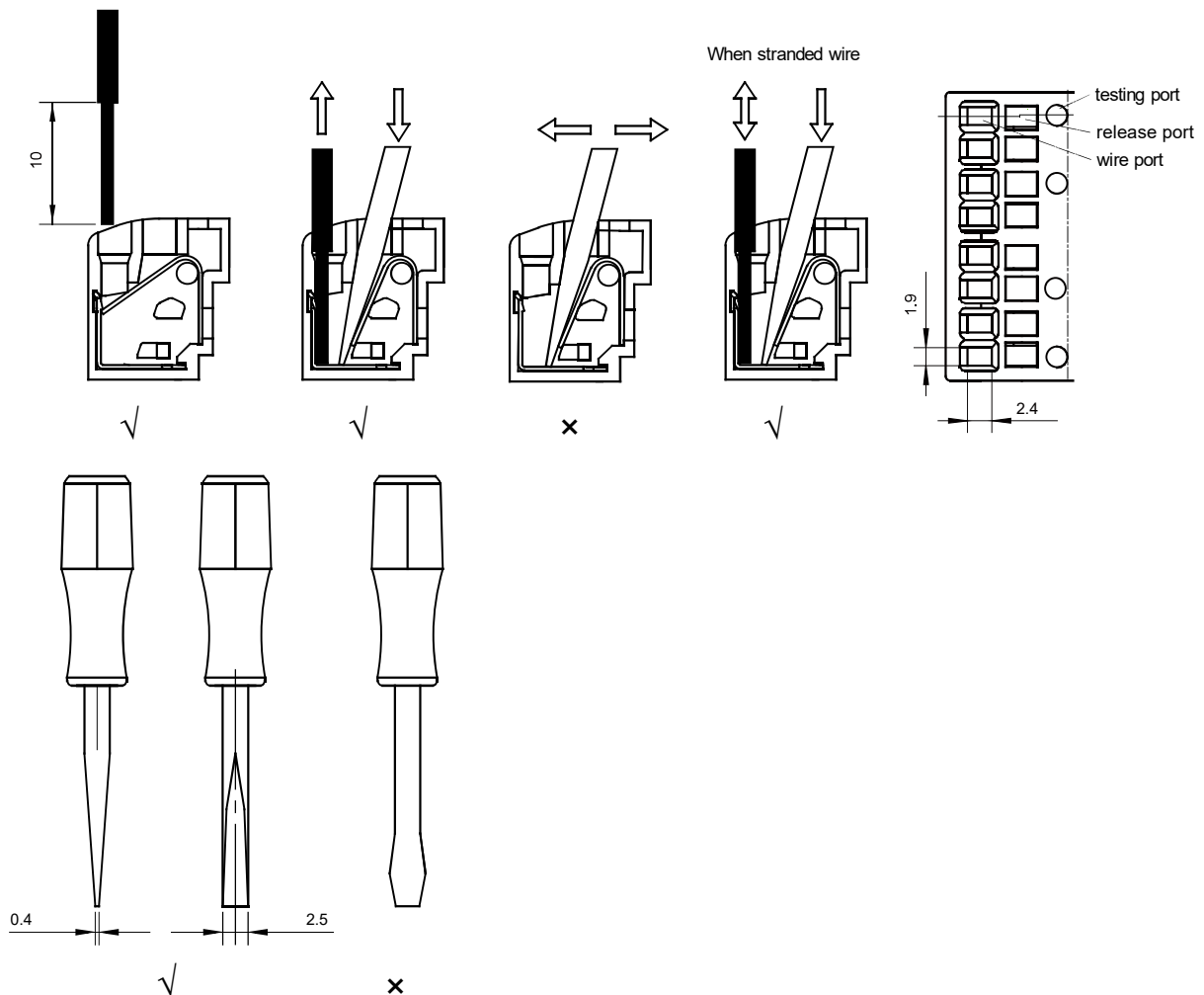

Disclaimer

The specification is for reference only. See to "Terminology and Guidelines" for more information. Specifications subject to change without notice. We could not evaluate all the performance and all the parameters for every possible application. Thus the user should be in a right position to choose the suitable product for their own application. If there is any query, please contact Hongfa for the technical service. However, it is the user's responsibility to determine which product should be used only.

© Xiamen Hongfa Electroacoustic Co., Ltd. All rights of Hongfa are reserved.