

# Contactors Catalogue

For more information please visit our website:

[www.hongfa.com](http://www.hongfa.com)



XIAMEN HONGFA ELECTRICAL SAFETY & CONTROLS CO.,LTD.  
ADD:No.566 Donglin Road,Jimei North ind. District,Xiamen 361021



Established in 1984, Hongfa (stock code: 600885) has achieved the scale of multi-category products research/production and international sales abiding by the enterprise spirit of “Persevere for Progress, Strive for Excellence”. At present, Hongfa owns 38 fully-owned or holding subsidiaries with completed factory area of 350 thousand square meters and new factory area of 540 thousand square meters under construction. Hongfa products including switching devices (circuit breaker, contactor, SPD etc.), high/low voltage switchgear, relay, precision components, automation equipments etc.

Hongfa technical center, which is of state class in China, the R&D team is constituted of top technical personnel in the industry. The center has led the formulation of several national standards and implementation of several national key projects. Meanwhile, Hongfa is the only enterprise that owns postdoctor working station and academician working station of the industry in China.

Hongfa test & inspection center is the biggest and technically most advanced inspection and analysis lab of the industry in China. Also, the center is approved by VDE (German), UL (North America) and CNAS (China). Hongfa has gotten domestic/overseas safety certificates of UL/CUL, VDE, TÜV, CQC etc. for its products.

Hongfa Sales Center exploit the international high level market with abundant experience and advantage, which has won the strategic cooperation opportunity with the worldwide famous switching and electrification devices manufacturer. Many worldwide top 500 enterprises and domestic famous companies have become our partners, such as SAMSUNG, UTC, EATON, ENEL, INGERSOLL RAND, JCI, GE, EMERSON, HONEYWELL, Faxcoon, China State Grid, China Southern Grid, China Telecom, China Railway Engineering, China Railway Construction, China Coal, China Shenhua Group, China Huadian Group, China Guodian Group, China Huaneng, China Datang, Greenland Group, Gold Wind, TBEA, Gree, Media, Haier, and regional power companies.

Hongfa is willing to develop with global customers hand in hand to share the convenience and achievement brought to the humanbeing by the technology!

## Cross reference

### Definite Purpose Contactors

HONGFA	Tyco/PU	Siemens/Furnas	GE	CUTLER –hammer	Schneider/Square D.	Honeywell
XMC0	3100	42/45	CR453	C25	8910	R82



# Contents

---

## XMC0 Series

Description .....	▶ 01
Features .....	▶ 01
Environmental Characteristics .....	▶ 01
Model Nomenclature-Ordering Information .....	▶ 02
Characteristics .....	▶ 04
Outline Dinmensions .....	▶ 07
Wiring Diagram .....	▶ 16
Main Contact Terminals .....	▶ 17
Remarks .....	▶ 18

---

## XMC0 Series

### Definite Purpose Contactors

### Description

Hongfa's Definite Purpose Contactor XMC0 meets the high requirements demands of the HVAC, refrigeration, heating,

data processing, welding, elevators, hoist & cranes, pool, commercial spa, and food service equipment industries. Hongfa contactors are compliance with UL 60947-4-1, GB/T 14048.4, IEC 60947-4-1 and EN 60947-4-1.



### Features

1. Tools-free accessories for quick & easy snap on assembly.
2. Various terminal options for specific application.
3. Standard mounting plate.
4. Silver alloy contact can reach higher electrical endurance.
5. Class F (155°C) Coil insulation supporting a wide range of coil voltage, standard coil frequency 50/60Hz.
6. Coil cover optional for 1 pole and 2 pole AC contactors.
7. UL(USR/CNR) and CCC approved, some models with TÜV or KC certificate.
8. Flame arrest-protected components for use in refrigeration and air-conditioning equipment employing A2L refrigerants (Except for 2 poles w/ the contact normally closed, 1 pole & 2 poles w/ DC coil and 4 poles).
9. XMC0 25-63A of 1 pole, 2 poles and 3 poles have the test button on the cover.

### Environmental characteristics

Operating position		Vertical or Horizontal (Metal/Plastic base mounting)
Ambient temperature	Operation	-40°C ~ +70°C/ -40°F ~ +158°F
	Storage	-40°C ~ +70°C / -40°F ~ +158°F
Relative humidity		90%~95%RH at 40°C
Pollution degree		3

# XMC0 Series

**HONGFA**

## Model nomenclature - Ordering Information

**XMC 0 - 50 J33 . E B B C 0 0 F G Z X**

<b>Product Type</b> <b>XMC</b> = Contactor Series	<b>Option</b> Customer assigned suffix "X" where "X" may be any alphanumeric character or any combined alphanumeric character. Suffix "W": contactor for use in refrigeration and air-conditioning equipment employing A2L refrigerants.				
<b>Design Sequence Number</b> <b>0</b> = Design Sequence Number					
<b>Full Load Amperes (FLA)</b> <b>25</b> = 25A <b>63</b> = 63A <b>32</b> = 32A <b>75</b> = 75A <b>40</b> = 40A <b>90</b> = 90A <b>50</b> = 50A					
<b>Number of Poles</b> <b>1</b> = 1-pole+shunt(25-40A) <b>7</b> = 1-pole(25-40A) <b>2</b> = 2-pole(25-40A) <b>2C</b> = 2-pole Normal Close(40A,UL approved only) <b>3</b> = 3-pole(25-90A) <b>3A</b> = 2-pole (3P frame, 25-90A) <b>4</b> = 4-pole(25-40A,UL approved only) <b>Jmn</b> = Matching mechanically interlocked block (3P/4P frame). "m" = 3A or 3 or 4, number of poles of the contactor A(on the left) and "n" = 3A or 3 or 4, number of poles of the contactor B(on the right). <b>Notes:</b> Quantum series only available for 2P/3P/4P frame, please contact us if you have any request.	<b>Contact Construction Style (For 50/63 FLA only)</b> <b>Blank</b> = Flat construction in shape <b>Z</b> = Bend construction in shape(No "Break All Lines" restriction)				
	<b>Main Contact Quick Terminals</b> <b>Blank</b> = Quad Terminals in 1- and 2- pole models and Dual Terminals in 3/4-pole models <b>G</b> = None QC Terminals <b>Q</b> = Quad Terminals in 3/4-pole models (Only the side no coil terminals)				
	<b>Coil Terminals</b> <b>Blank</b> = Dual QC without screw in 1- and 2- pole models and Single QC with screw in 3/4-pole models <b>F</b> = Dual QC in 3/4-pole models				
<b>Coil Voltage</b> <b>E</b> = 24VAC 50/60Hz <b>F</b> = 110-120VAC 50/60Hz <b>I</b> = 208-220VAC 50Hz    208-240VAC 60Hz <b>L</b> = 277VAC 60Hz <b>N</b> = 380-415VAC 50Hz    440-480VAC 60Hz <b>U</b> = 550-600VAC 50/60Hz <b>P</b> = 12VDC (For 1P/1P+shunt/2P,UL approved only) <b>Q</b> = 24VDC (For 1P/1P+shunt/2P,UL approved only) <b>R</b> = 36VDC (For 1P/1P+shunt/2P,UL approved only) <b>Note:</b> Please contact us if you have any other request.					
<b>Mounting plate</b> <b>B</b> = Metal plate <b>Blank</b> = Metal plate (Quantum series)					
<b>Top Cover</b> <b>B</b> = Short cover <b>Blank</b> = Short cover (Quantum series)					
<b>Main Contact Terminals</b> <b>C</b> = Slotted & Hex head washer w/ quick connect <b>D</b> = Box Lug w/ quick connect <b>E</b> = Box lug w/ quick connect (Line side) Slotted & Hex head washer w/ quick connect (Load side) <b>F</b> = Slotted & Hex head washer w/ quick connect (Line side) Box lug w/ quick connect (Load side) <b>Note:</b> Please contact us if you have any other request.	<table> <tr> <th>Auxiliary Contacts or Microswitch on Left Side (For 3/4-pole models only)</th><th>Auxiliary Contacts or Microswitch on Right Side (For 3/4-pole models only)</th></tr> <tr> <td> <b>0</b> = None (Standard Type)  <b>1</b> = 1NC + 1NO, 0.250" quick connect terminal  <b>3</b> = 1NC, 0.250" quick connect terminal  <b>4</b> = 1NO, 0.250" quick connect terminal  <b>5</b> = 2NC, 0.250" quick connect terminal  <b>6</b> = 2NO, 0.250" quick connect terminal  <b>1P</b> = 1NC + 1NO, pressure plate screw  <b>3P</b> = 1NC, pressure plate screw  <b>4P</b> = 1NO, pressure plate screw  <b>5P</b> = 2NC, pressure plate screw  <b>6P</b> = 2NO, pressure plate screw  <b>L</b> = 2 SPDT  <b>L1</b> = 1 SPDT, left side(position 1) of microswitch block  <b>L2</b> = 1 SPDT, right side(position 2) of microswitch block               </td><td> <b>0</b> = None (Standard Type)  <b>1</b> = 1NC + 1NO, 0.250" quick connect terminal  <b>3</b> = 1NC, 0.250" quick connect terminal  <b>4</b> = 1NO, 0.250" quick connect terminal  <b>5</b> = 2NC, 0.250" quick connect terminal  <b>6</b> = 2NO, 0.250" quick connect terminal  <b>1P</b> = 1NC + 1NO, pressure plate screw  <b>3P</b> = 1NC, pressure plate screw  <b>4P</b> = 1NO, pressure plate screw  <b>5P</b> = 2NC, pressure plate screw  <b>6P</b> = 2NO, pressure plate screw  <b>R</b> = 2 SPDT  <b>R1</b> = 1 SPDT, left side(position 1) of microswitch block  <b>R2</b> = 1 SPDT, right side(position 2) of microswitch block               </td></tr> </table> <p>For example: (Refer to HF logo position, see page 11.)  <b>34P</b> = 1NC 0.250" quick connect terminal on left side                    1NO pressure plate screw on right side  <b>LR1</b> = 2 SPDT on left side                    1 SPDT(position 1 of microswitch block) on right side  <b>3R2</b> = 1NC 0.250" quick connect terminal on left side                    1 SPDT(position 2 of microswitch block) on right side  <b>Note:</b> If "00" will be the final digits in selection, omit from model nomenclature.       </p>	Auxiliary Contacts or Microswitch on Left Side (For 3/4-pole models only)	Auxiliary Contacts or Microswitch on Right Side (For 3/4-pole models only)	<b>0</b> = None (Standard Type) <b>1</b> = 1NC + 1NO, 0.250" quick connect terminal <b>3</b> = 1NC, 0.250" quick connect terminal <b>4</b> = 1NO, 0.250" quick connect terminal <b>5</b> = 2NC, 0.250" quick connect terminal <b>6</b> = 2NO, 0.250" quick connect terminal <b>1P</b> = 1NC + 1NO, pressure plate screw <b>3P</b> = 1NC, pressure plate screw <b>4P</b> = 1NO, pressure plate screw <b>5P</b> = 2NC, pressure plate screw <b>6P</b> = 2NO, pressure plate screw <b>L</b> = 2 SPDT <b>L1</b> = 1 SPDT, left side(position 1) of microswitch block <b>L2</b> = 1 SPDT, right side(position 2) of microswitch block	<b>0</b> = None (Standard Type) <b>1</b> = 1NC + 1NO, 0.250" quick connect terminal <b>3</b> = 1NC, 0.250" quick connect terminal <b>4</b> = 1NO, 0.250" quick connect terminal <b>5</b> = 2NC, 0.250" quick connect terminal <b>6</b> = 2NO, 0.250" quick connect terminal <b>1P</b> = 1NC + 1NO, pressure plate screw <b>3P</b> = 1NC, pressure plate screw <b>4P</b> = 1NO, pressure plate screw <b>5P</b> = 2NC, pressure plate screw <b>6P</b> = 2NO, pressure plate screw <b>R</b> = 2 SPDT <b>R1</b> = 1 SPDT, left side(position 1) of microswitch block <b>R2</b> = 1 SPDT, right side(position 2) of microswitch block
Auxiliary Contacts or Microswitch on Left Side (For 3/4-pole models only)	Auxiliary Contacts or Microswitch on Right Side (For 3/4-pole models only)				
<b>0</b> = None (Standard Type) <b>1</b> = 1NC + 1NO, 0.250" quick connect terminal <b>3</b> = 1NC, 0.250" quick connect terminal <b>4</b> = 1NO, 0.250" quick connect terminal <b>5</b> = 2NC, 0.250" quick connect terminal <b>6</b> = 2NO, 0.250" quick connect terminal <b>1P</b> = 1NC + 1NO, pressure plate screw <b>3P</b> = 1NC, pressure plate screw <b>4P</b> = 1NO, pressure plate screw <b>5P</b> = 2NC, pressure plate screw <b>6P</b> = 2NO, pressure plate screw <b>L</b> = 2 SPDT <b>L1</b> = 1 SPDT, left side(position 1) of microswitch block <b>L2</b> = 1 SPDT, right side(position 2) of microswitch block	<b>0</b> = None (Standard Type) <b>1</b> = 1NC + 1NO, 0.250" quick connect terminal <b>3</b> = 1NC, 0.250" quick connect terminal <b>4</b> = 1NO, 0.250" quick connect terminal <b>5</b> = 2NC, 0.250" quick connect terminal <b>6</b> = 2NO, 0.250" quick connect terminal <b>1P</b> = 1NC + 1NO, pressure plate screw <b>3P</b> = 1NC, pressure plate screw <b>4P</b> = 1NO, pressure plate screw <b>5P</b> = 2NC, pressure plate screw <b>6P</b> = 2NO, pressure plate screw <b>R</b> = 2 SPDT <b>R1</b> = 1 SPDT, left side(position 1) of microswitch block <b>R2</b> = 1 SPDT, right side(position 2) of microswitch block				



## Type Model Nomenclature - Ordering Information

### Auxiliary Contact Blocks:

<b>C03</b>	<b>A</b>	<b>11</b>	<b>P</b>	<b>Q</b>	<b>X</b>
<b>Basic Designation</b>					
C03 = For XMC0 3P/4P Series Definite Purpose Contactors.					
<b>Accessory Category</b>					
A = Auxiliary Contacts Block					
<b>Contact Type</b>					
01 = 1NC    10 = 1NO    11 = 1NC + 1NO    02 = 2NC    20 = 2NO					
Note: NC = Normally Closed, NO = Normally Opened.					
<b>Quick Connect Terminals</b>					
Blank = 0.250" quick connect terminals P = Pressure plate screw (None QC terminals)					
<b>Used Function</b>					
Q = Match with Quantum series					
<b>Option</b>					
Customer assigned suffix "X" where "X" may be any alphanumeric character or any combined alphanumeric character.					

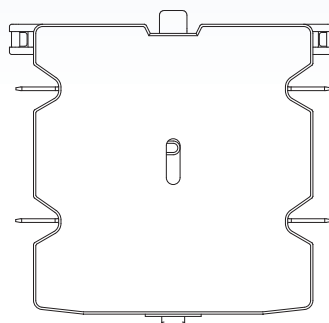

### Microswitch Blocks:

C03	M	10	Q	X
<b>Basic Designation</b>				
C03 = For XMC0 3P/4P Series Definite Purpose Contactors.				
<b>Accessory Category</b>				
M = Microswitch Block				
<b>Contact Type</b>				
Microswitch at Left side(position 1) for Microswitch Assembly		Microswitch at Right side(position 2) for Microswitch Assembly		
0 = None	3 = 1 SPST-NC	0 = None	3 = 1 SPST-NC	
1 = 1 SPDT	4 = 1 SPST-NO	1 = 1 SPDT	4 = 1 SPST-NO	
<b>Note:</b> SPDT = Single Pole Double Throw, SPST = Single Pole Single Throw, NC = Normally Closed, NO = Normally Opened.				
<b>Used Function</b>				
Q = Match with Quantum series				
<b>Option</b>				
Customer assigned suffix "X" where "X" may be any alphanumeric character or any combined alphanumeric character.				

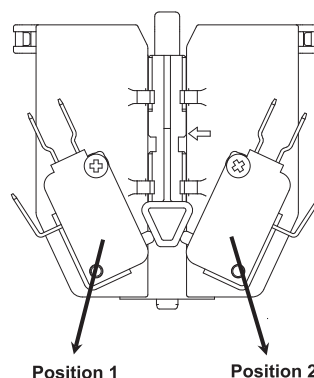

### Interlock Blocks:

<b>C03</b>	<b>J</b>	<b>1Q</b>	<b>X</b>
<b>Basic Designation</b>			
C03 = For XMC0 3P/4P Series Definite Purpose Contactors.			
<b>Accessory Category</b>			
J = Mechanically Interlocked Block			
<b>Interlock Type</b>			
2Q = Match with 75-90A(Quantum series) 1Q = Match with 25-63A(Quantum series)			
<b>Option</b>			
Customer assigned suffix "X" where "X" may be any alphanumeric character or any combined alphanumeric character.			

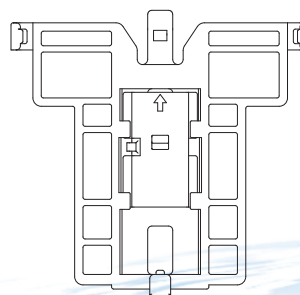

## DIN Rail Adapters:

**C01 D 1 X**

Basic Designation
C01 = For XMC0 1P/2P Series Definite Purpose Contactors.
Accessory Category
D = DIN rail adapter
Used Function
1 = Match with 25-40A
Option
Customer assigned suffix "X" where "X" may be any alphanumeric character or any combined alphanumeric character.

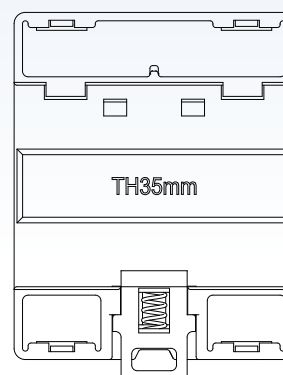

## Characteristics

Full Load Amps (FLA)	Poles	Voltage	Locked Rotor Amps (LRA)	Resistive Amps Rating (RES)	Maximum Horsepower (HP)			Catalog Number
					Voltage	Single Phase	Three Phase	
25	1	240/277 480 600	150 125 100	35	240/277	2	-	XMC0-257* XMC0-251*
32	1	240/277 480 600	180 150 120	40	240/277	2	-	XMC0-327* XMC0-321*
40	1	240/277 480 600	240 200 160	50	240/277	3	-	XMC0-407* XMC0-401
25	1	240/277 480 600	120 100 80	35	240/277	2	-	XMC0-257* XMC0-251* (DC Coil)
32	1	240/277 480 600	150 125 100	40	240/277	2	-	XMC0-327* XMC0-321* (DC Coil)
40	1	240/277 480 600	200 160 120	50	240/277	3	-	XMC0-407* XMC0-401 (DC Coil)
25	2	240/277 480 600	150 125 100	35	240/277	3	-	XMC0-252*
32	2	240/277 480 600	180 150 120	40	240/277	3	-	XMC0-322*
40	2	240/277 480 600	240 200 160	50	240/277	3	-	XMC0-402*
25	2	240/277 480 600	120 100 80	35	240/277	2	-	XMC0-252* (DC Coil)
32	2	240/277 480 600	150 125 100	40	240/277	2	-	XMC0-322* (DC Coil)
40	2	240/277 480 600	200 160 120	50	240/277	3	-	XMC0-402* (DC Coil)
40	2C	240/277	180	50	240/277	-	-	XMC0-402C*

## Characteristics (Continued)

Full Load Amps(FLA)	Poles	Voltage	Locked Rotor Amps (LRA)	Resistive Amps Rating (RES)	Maximum Horsepower(HP)			Catalog Number
					Voltage	Single Phase	Three Phase	
25	2	240/277	150	35	240/277	3	7.5	XMC0-253A*
	3	480	125		480	-	15	XMC0-253*
	4	600	100		600	-	20	XMC0-254*
32	2	240/277	180	40	240/277	5	10	XMC0-323A*
	3	480	150		480	-	15	XMC0-323*
	4	600	120		600	-	20	XMC0-324*
40	2	240/277	240	50	240/277	7.5	10	XMC0-403A*
	3	480	200		480	-	20	XMC0-403*
	4	600	160		600	-	25	XMC0-404*
50	2	240/277	300	63	240/277	10	15	XMC0-503A*
	3	480	250		480	-	25	XMC0-503*
		600	200+		600	-	25	
63	2	240/277	360	75	240/277	10	20	XMC0-633A*
	3	480	300		480	-	30	XMC0-633*
		600	240+		600	-	30	
50	2	240/277	300	63	240/277	10	15	XMC0-503A*Z
	3	480	250		480	-	25	XMC0-503*Z
		600	200		600	-	25	
63	2	240/277	360	75	240/277	10	20	XMC0-633A*Z
	3	480	300		480	-	30	XMC0-633*Z
		600	240		600	-	30	
75	2	240/277	450	94	240/277	15	25	XMC0-753A*
	3	480	375		480	-	40	XMC0-753*
		600	300		600	-	40	
90	2	240/277	540	120	240/277	20	30	XMC0-903A*
	3	480	450		480	-	50	XMC0-903*
		600	360		600	-	50	

### Notes:

1. All models can be used for the application which is no higher than the certificated load, including certificated voltage, FLA, LRA or RES.
2. All the ratings have no "Break All Lines" restriction, except the rating "600VAC 50FLA/200LRA" for "XMC0-50 without Z" and "600VAC 63FLA/240LRA" for "XMC0-63 without Z".
3. Contact factory representative for Cd free option.

## Auxiliary Contacts Block Characteristics

Contact Type:	Rated voltage (VAC)	120	240	480	600
1NO, 1NC,	Breaking current (A)	3.0	1.5	0.75	0.6
1NO+1NC,	Making current (A)	30	15	7.5	6
2NO, 2NC	Conventional free air thermal current	10	10	10	10

## Microswitch Blocks Characteristics

Contact type - SPDT	10A or 11A or 16A, 1/3 HP, 125VAC or 250 VAC 1/2A, 125 VDC; 1/4A, 250 VDC 4A 120 VAC on Lamp Load
<b>Note:</b> Please contact us if you have any other request.	



## AC Coil characteristics @ 25℃ (Cold state)

Part number	Nominal Coil Voltage	Nominal Inrushed VA		Nominal Sealed VA		Maximum Pick-up Volts	Drop-out Volts Range
		60Hz	50Hz	60Hz	50Hz		
XMC0-□1/7	24	25	27	6.5	8.5	18	6-15
	120	25	27	7	9	88	25-70
	208/240	27	25	8.5	8.5	176	50-140
	277	25	-	8.5	-	215	60-165
XMC0-□2	24	25	27	6.5	8.5	18	6-15
	120	25	27	7	9	88	25-70
	208/240	27	25	8.5	8.5	176	50-140
	277	25	-	8.5	-	215	60-165
XMC0-□2C	208/240	30	28	7.5	8	176	50-140
XMC0-□3/3A	24	50	55	8	10	18	6-15
	120	60	65	10	13.5	88	25-70
	208/240	50	45	9.5	9.5	176	50-140
	277	50	-	10.5	-	215	60-165
XMC0-□4	24	55	60	9	12	18	6-15
	120	60	65	11	14	88	25-70
	208/240	60	55	12	12.5	176	50-140
	277	60	-	11.5	-	215	60-165
XMC0-503/633	24	90	100	12.5	16.5	18	6-15
	120	90	100	13	17	88	25-70
	208/240	100	90	15	15	176	50-140
	277	90	-	14	-	215	60-165
XMC0-753/903	24	190	210	23.5	30	18	6-15
	120	230	255	30.5	38.5	88	25-70
	208/240	240	230	32	32	176	50-140
	277	210	-	25	-	215	60-165

### Notes:

1.  $U_s=24VAC$  50/60Hz ("E" coil) or  $120VAC$  50/60Hz ("F" coil) or  $220VAC/50Hz$ ,  $240VAC/60Hz$  ("I" coil) or  $277VAC/60Hz$  ("L" coil).
2. Inrushed and Sealed VA are tested at  $U_s$ .
3. Please contact us if you have any other request.

DC Coil characteristics @ 25℃ (Cold state)

Part number	Nominal Coil Voltage	Nominal Inrushed /Sealed Watts	Maximum Inrushed /Sealed Watts	Maximum Pick-up Volts	Minimum Drop-out Volts
XMC0-□1/7	12	5	6	9.6	1.2
	24	5	6	19.2	2.4
	36	5	6	28.7	3.6
XMC0-□2	12	5	6	9.6	1.2
	24	5	6	19.2	2.4
	36	5	6	28.7	3.6

Notes:

1. Inrushed and Sealed VA are tested at Us.

Outline Dimensions

Unit:mm

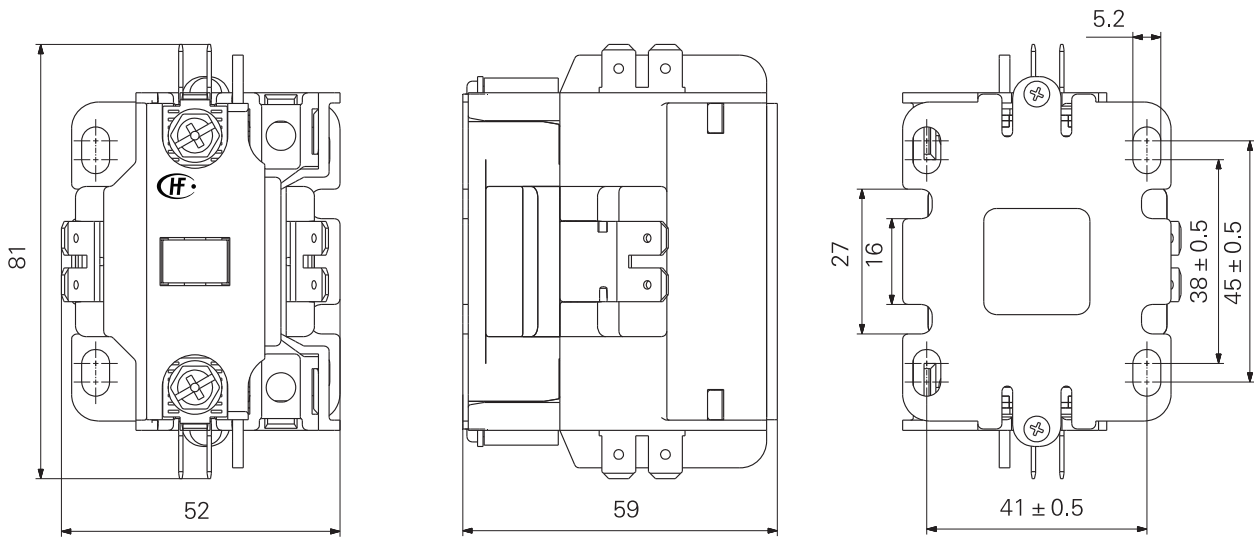

1 pole (metal base, 25-40FLA)

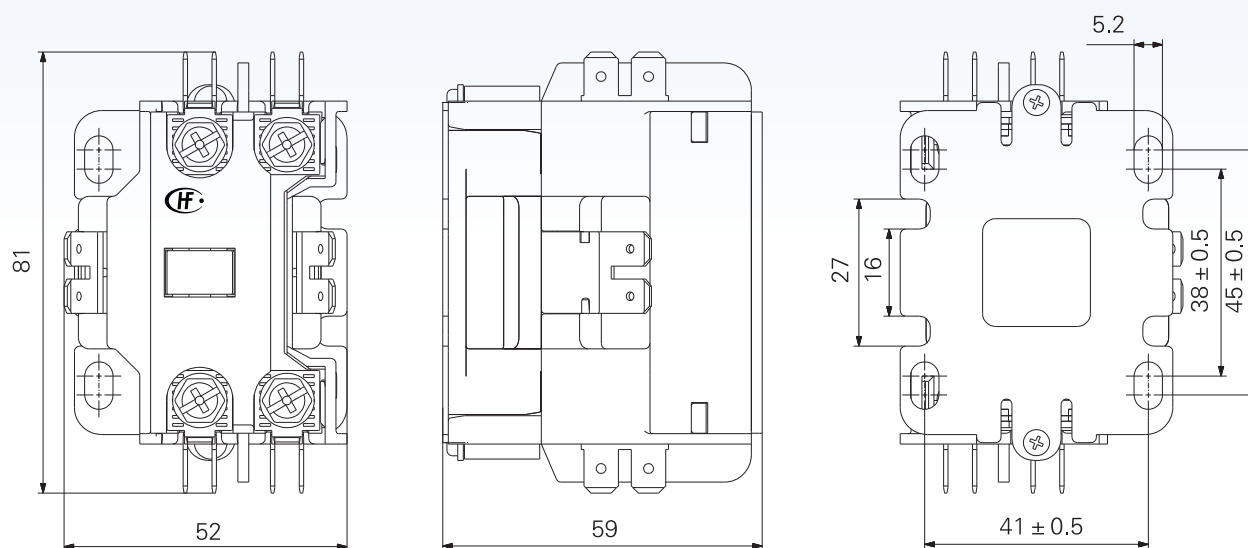

1 pole+shunt (metal base, 25-40FLA)

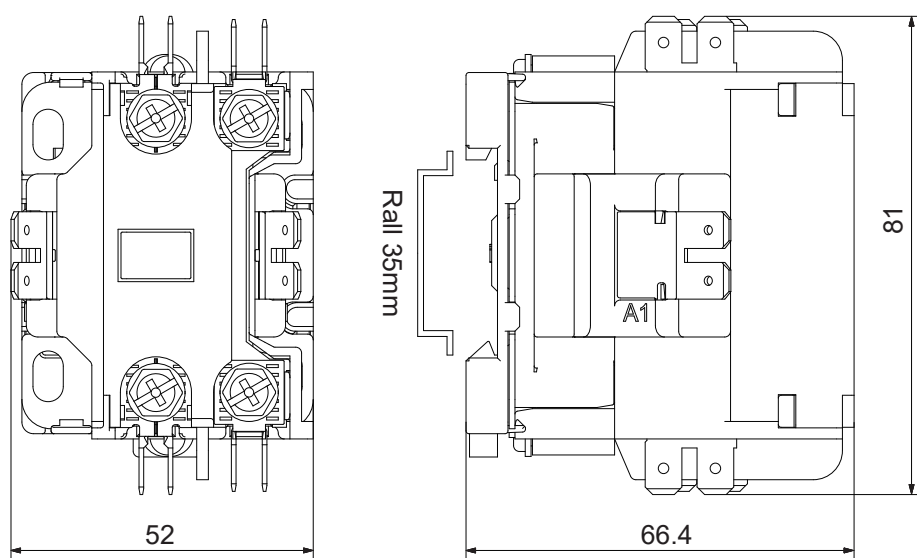

1 pole+shunt (rail mounting, 25-40FLA)

## Outline Dimensions

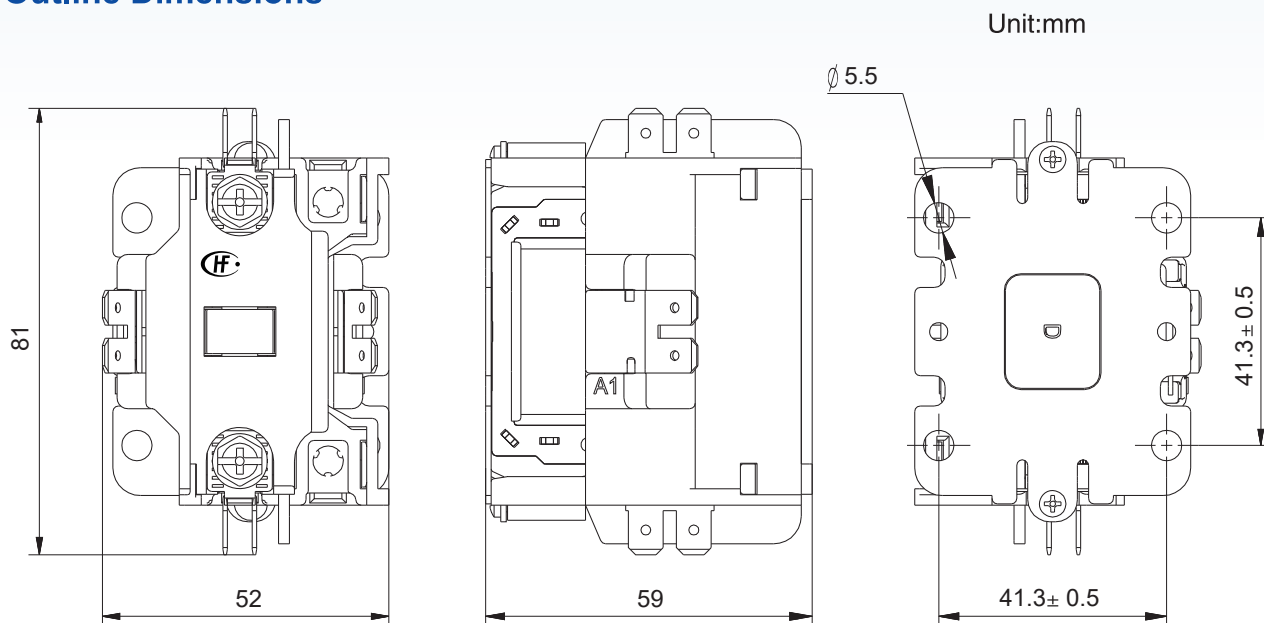

1 pole (metal base, 25-40FLA) - DC Coil, UL approved only

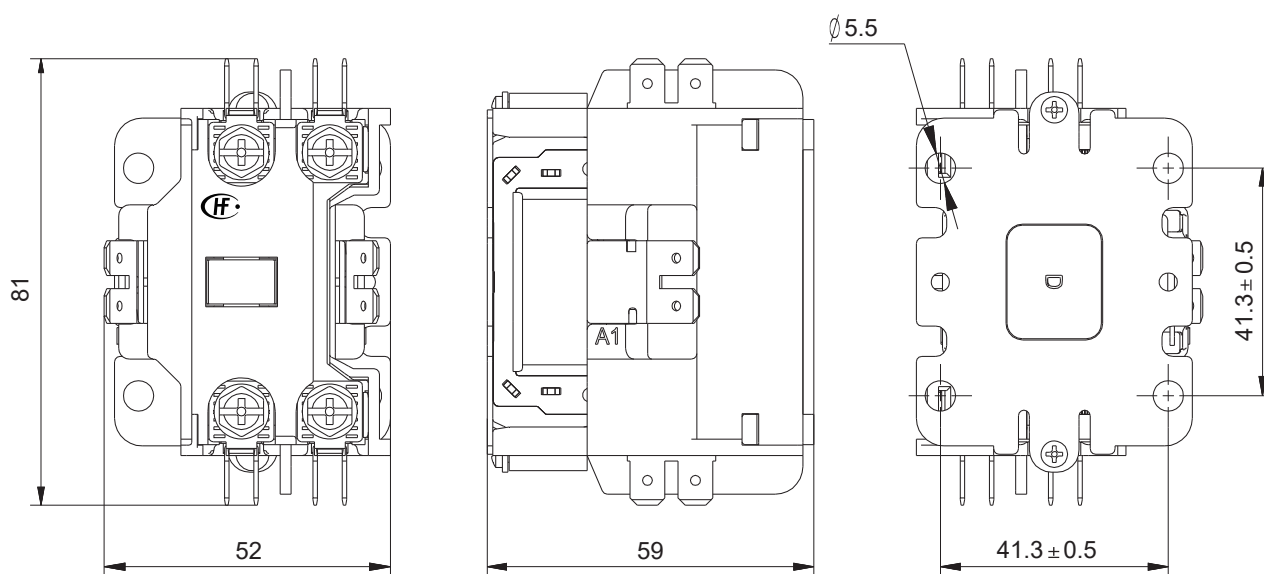

1 pole+shunt (metal base, 25-40FLA) - DC Coil, UL approved only

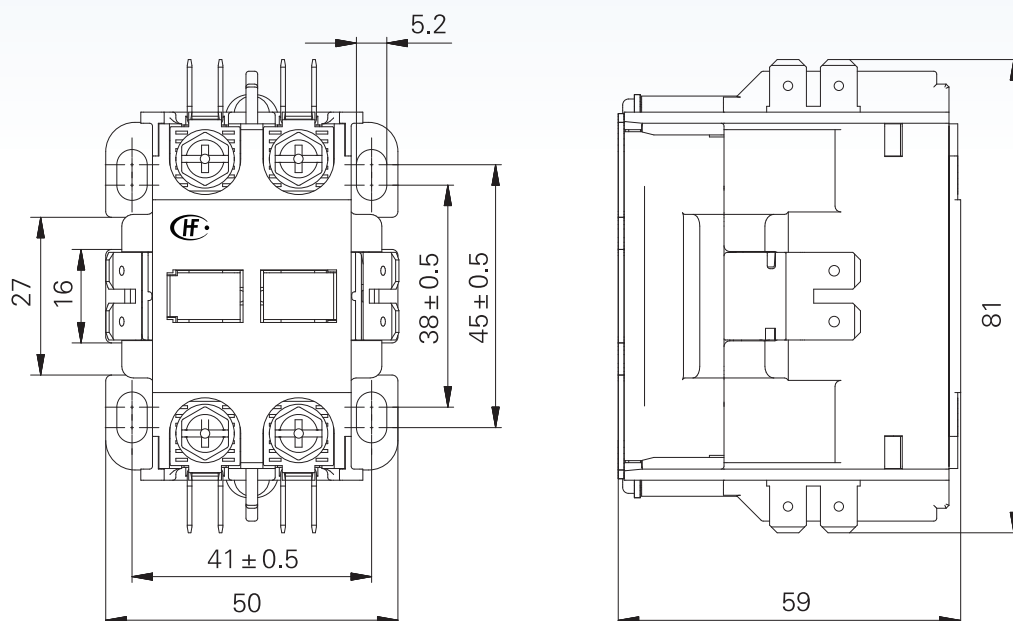

2 poles (metal base, 25-40FLA)

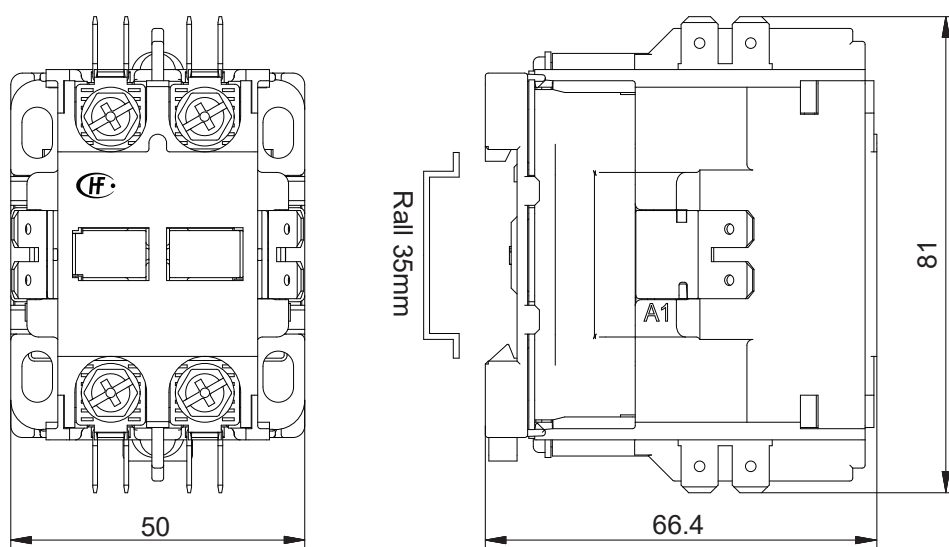

2 poles (rail mounting, 25-40FLA)

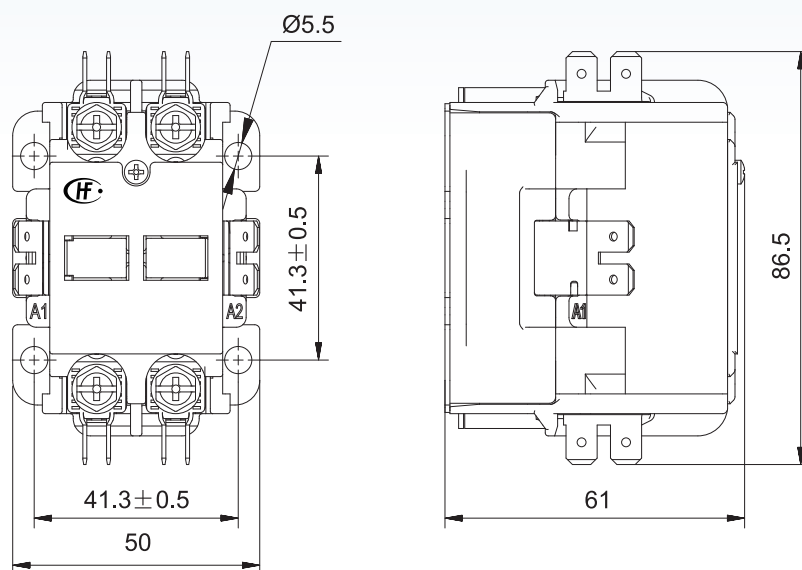

2 poles (metal base, 25-40FLA) - Quantum series (Charging Pile etc.)

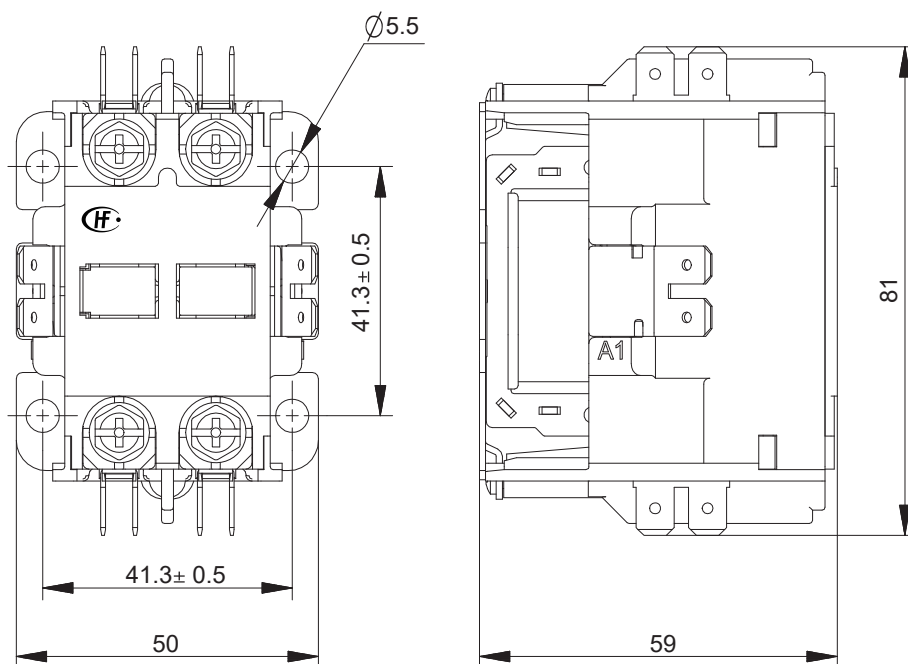

2 poles (metal base, 25-40FLA) – DC Coil, UL approved only



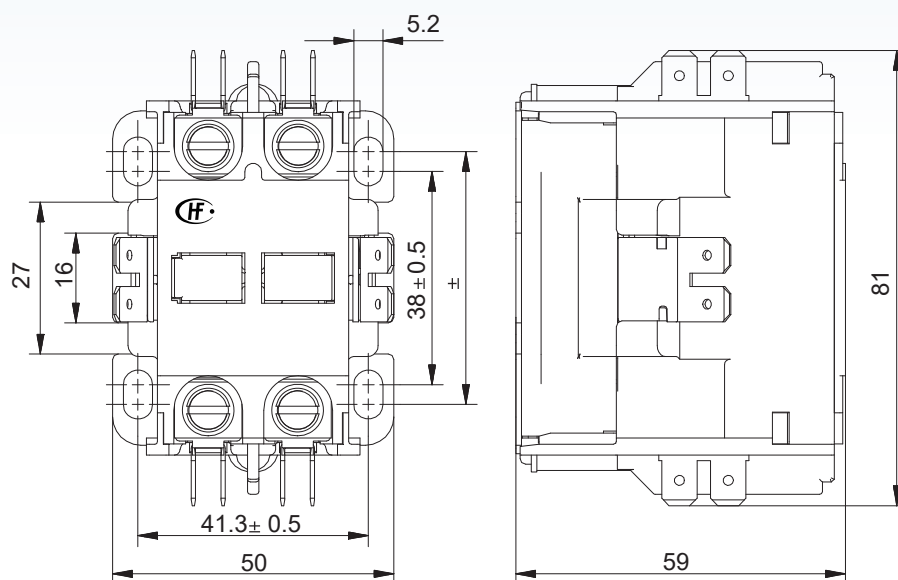

2 poles (metal base, 40FLA) – Normal Close, UL approved only

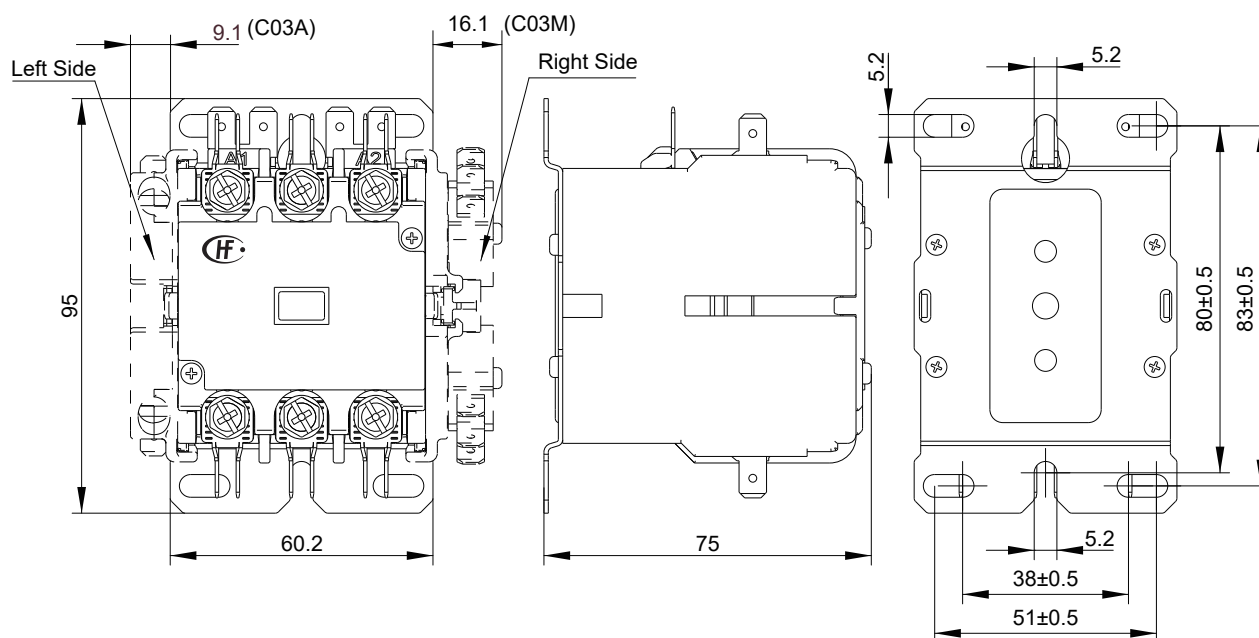

3 poles (metal base, 25-40FLA) - Quantum series

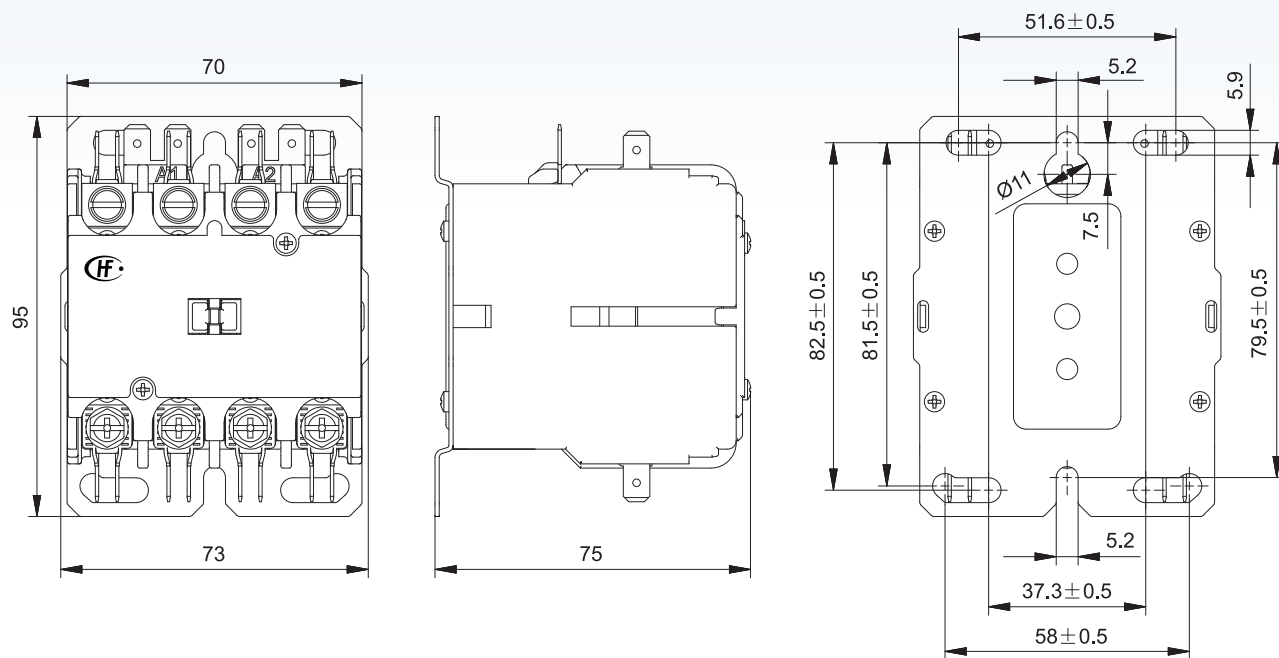

4 poles (metal base, 25-40FLA) - Quantum series, UL approved only

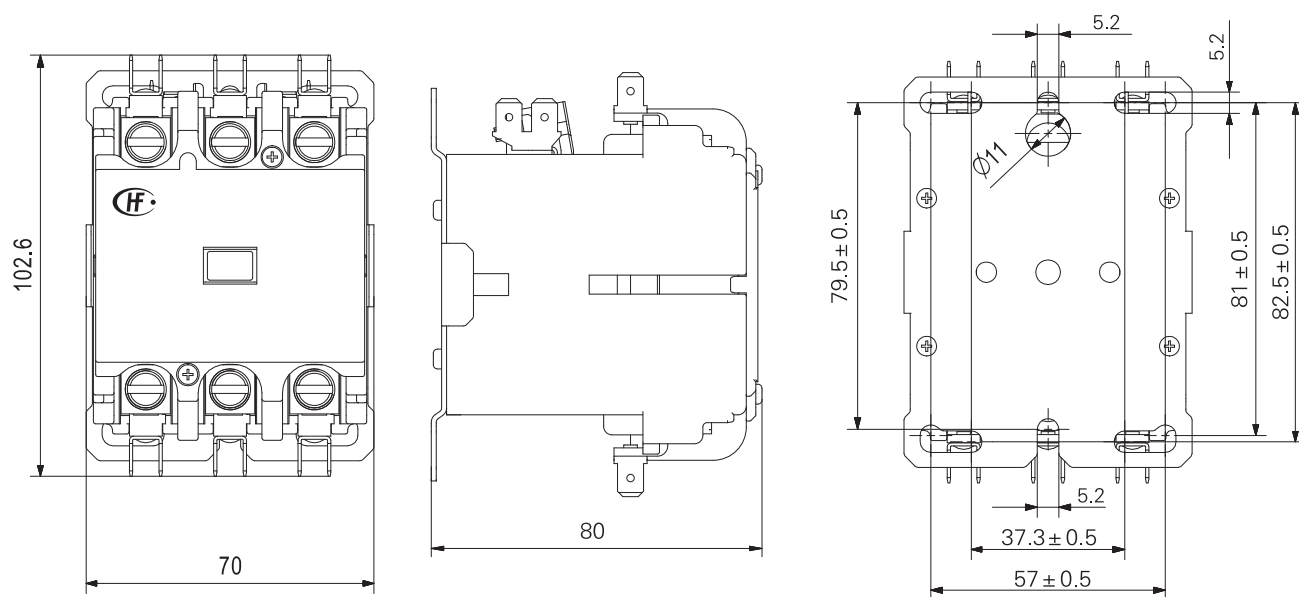

3 poles (metal base, 50-63FLA) - Quantum series

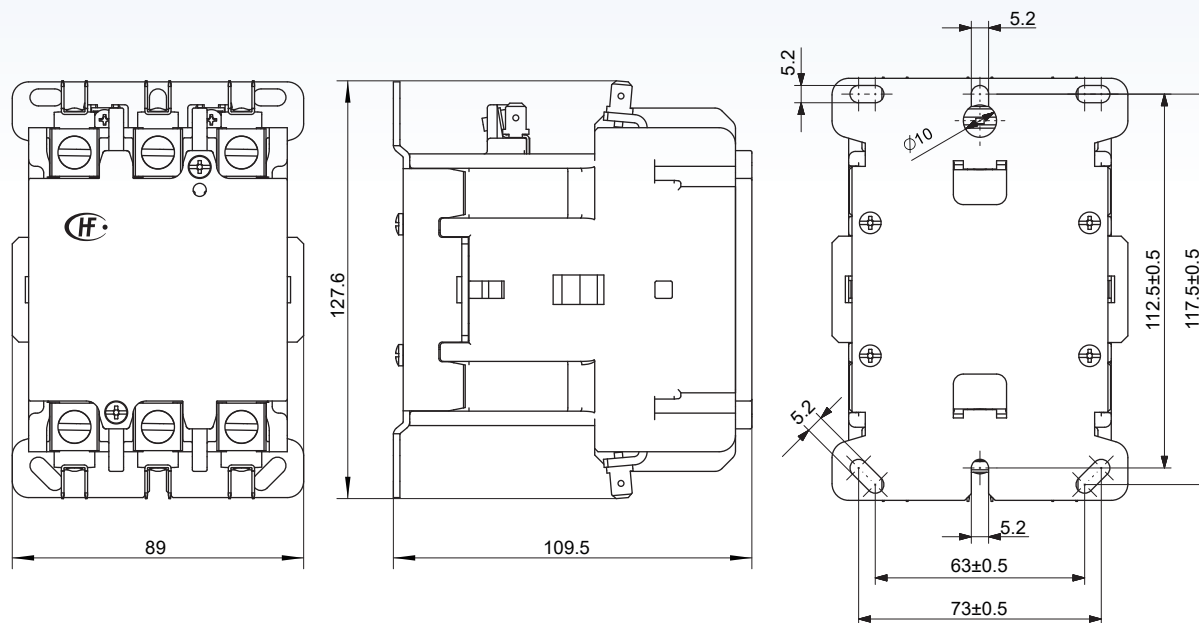

3 poles (metal base, 75-90FLA) - Quantum series

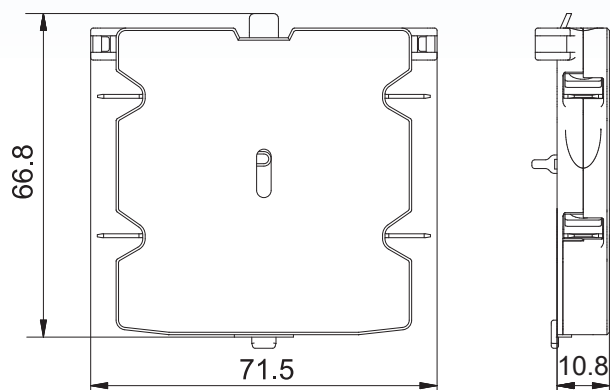

Auxiliary Contact Blocks - Used for 3P/4P Quantum series

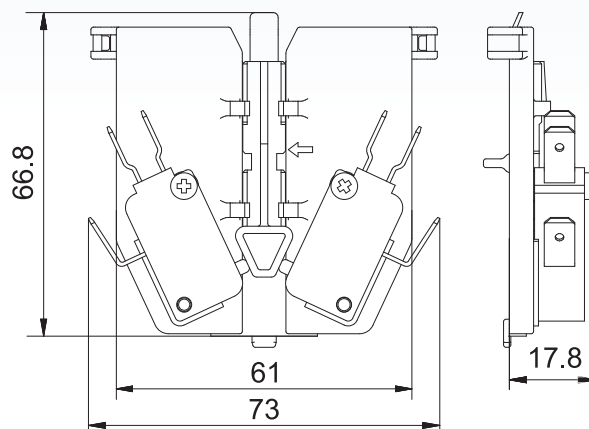

Microswitch Blocks - Used for 3P/4P Quantum series

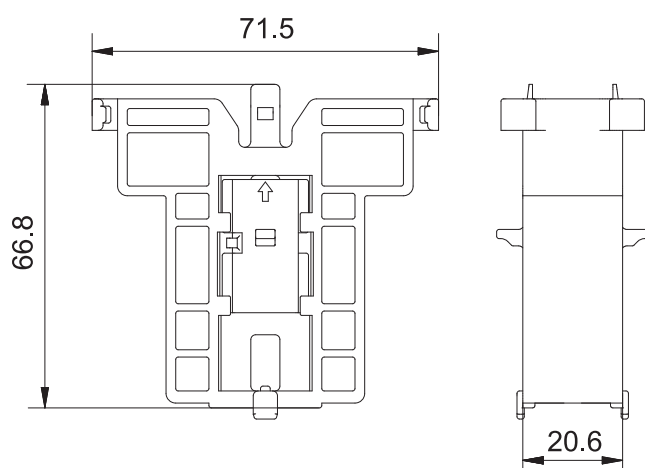

Interlock Blocks - Used for 3P/4P Quantum series

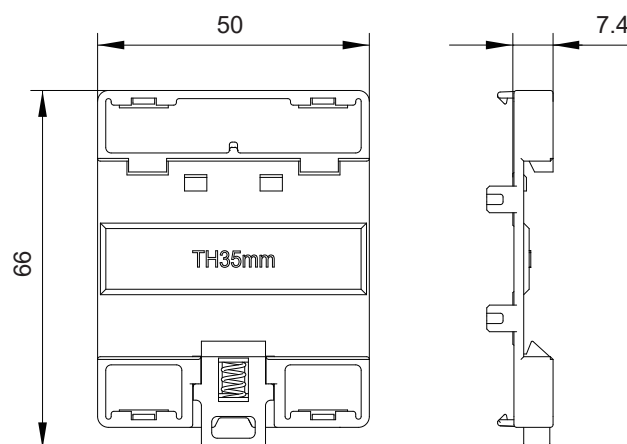

35mm DIN rail adapter - Used for 1P/2P series

Notes: The tolerance of undeclared outline dimensions is  $\pm 1.5$ .

## Wiring Diagram

### Contactors:

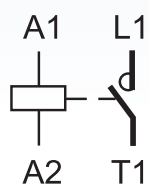

XMC0-□7

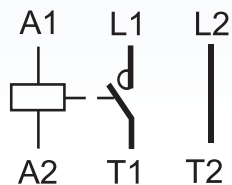

XMC0-□1

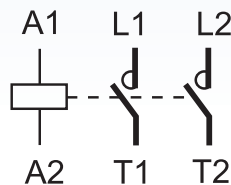

XMC0-□2

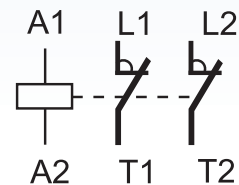

XMC0-□2C

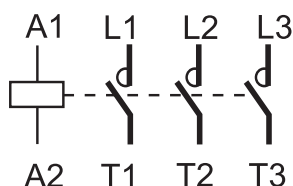

XMC0-□3

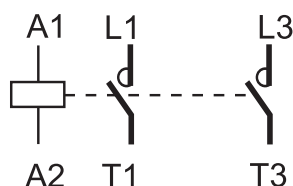

XMC0-□3A

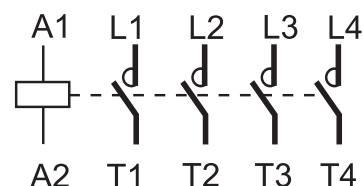

XMC0-□4

### Auxiliary Contact Blocks:

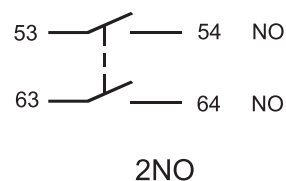
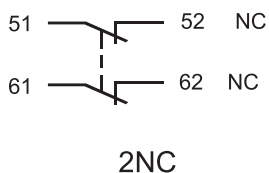
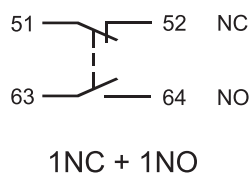
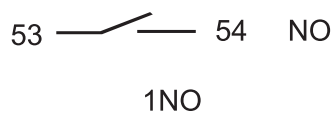
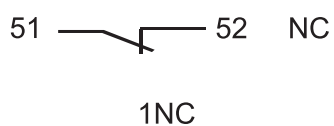

### Main Contact Terminals

Unit: mm

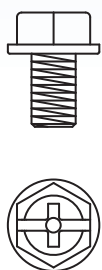

#### C type on 25-40A FLA

#10-32 combination  
phillips, slotted &  
5/16 hex head with  
#8 washer

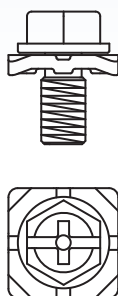

#### Special C type on 25-40A FLA

#10-32 sems screw  
with pressure plate

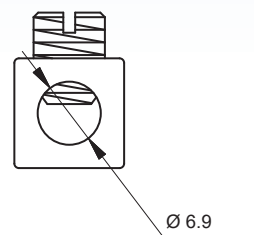

#### D type on 25-40A FLA

#14-4 AWG Cu/Al

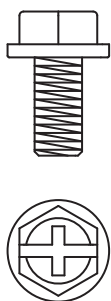

#### C type on 50-90A FLA

M6 combination  
phillips, slotted &  
3/8 hex head with  
#12 washer

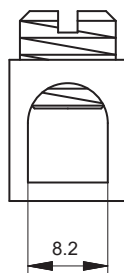

#### D type on 50-63A FLA

#14-2 AWG Cu/Al



#### D type on 75-90A FLA

#8-1/0 AWG Cu only



## Remarks:

- 1) Torque for Screws 25 lb-in /Lugs 25 lb-in for 25-40FLA types;  
Torque for Screws 45 lb-in /Lugs 50 lb-in for 50-63FLA types;  
Torque for Screws 50 lb-in /Lugs 60 lb-in for 75-90FLA types;  
Torque for Screws 8 lb-in for Auxiliary Contact Blocks;  
Torque for Coil Screws 8 lb-in for 3/4-pole 25-40FLA types and 12 lb-in for 50-90FLA types;
- 2) For QC connection ,the female connectors should meet IEC60760 and ensure the reliable connection between female connectors and QC terminals.
- 3) Please contact us for any application out of specification.

# Xiamen Hongfa Electroacoustic Co. Ltd

Add: No.560-578, Donglin Rd., Jimei North Ind. Dist., Xiamen, China

TEL: +86-592-6106688

FAX: +86-592-6106678

E-mail: marketing@hongfa.com

## Marketing & Sales Network

### Hongfa Europe GmbH

ADD: Marie-Curie-Ring 26, D-63477

Maintal, Germany

TEL: +49-6181-4306-0

E-mail: info@hongfa-europe.com

### Hongfa America, Inc.

ADD: 20381 Hermana Circle, Lake

Forest, CA92630, USA

TEL: +1-714-669-2888

E-mail: sales@hongfaamerica.com

### KG Technologies, Inc.

ADD: 6028 Stat Farm Drive

Rohnert Park, CA 94928, USA

TEL: +1.888.513.1874

E-mail: info@kgtechnologies.com

### Hongfa Italy Srl

ADD: C/O Regus Business Center

Via Paracleso, 26 Agrate

B.za (MB), Italy

TEL: +39-0362-890-1544

E-mail: info@hongfa-europe.com

### Hongfa Electroacoustic (Hongkong) Co., Ltd.

ADD: Rm 1810-12, 18/F., Shatin Galleria,

18-24 Shan Mei St., Fotan, N.T, HongKong

TEL: +852-2947-7889

E-mail: hongkong@hongfa.com

### Shanghai Hongfa Electroacoustic Co., Ltd.

ADD: NO.51.341, Jiuxin Rd., Jiuting

Town, Songjiang Dist., Shanghai

TEL: +86-21-37693111

E-mail: shanghai@hongfa.com

### Beijing Hongfa Electroacoustic Relay Co., Ltd.

ADD: 111Bldg, Phase IV Westside of Lian

-dong U Valley, Tongzhou Dist., Beijing

TEL: +86-10-56495556

E-mail: beijing@hongfa.com

### Sichuan Hongfa Relay Co., Ltd.

ADD: 12F, Hongfa Building, No.6 Wuxing 4th

Road, Wuhou District, Chengdu

TEL: +86-28-86627550

E-mail: sichuan@hongfa.com

### Hongfa India Branch

TEL: +91-9810415895

E-mail: amikhuda@hongfa.com

TEL: +91-9971187792

E-mail: rohit@hongfa.com

### Hongfa Korea Branch

ADD: RM302, Samwoo B/D, 286-4

Gaebong dong, Guro-gu,

Seoul, Korea

TEL: +82-10-5355-4899/+82-10-8704-4706

E-mail: korea@hongfa.com /  
khlee@hongfa.com

### Hongfa Brazil Branch

Non-automotive relay project

TEL: +86-0592-6196714

E-mail: southamerica@hongfa.com

Automotive relay project

TEL: +55-11-949697906

E-mail: mauro-loyola@hongfa.com

### Hongfa Philippine Branch

TEL: +639177189352 / +639175780846

E-mail: nia-videna@hongfa.com

### Hongfa Turkey Branch

TEL: +90-535-0221881

E-mail: info-turkey@hongfa.com

The relevant information on the products contained is for reference only.  
For details, please consult our business staff.

Headquarter's Marketing & Sales Center

ADD: No.566-578, Donglin Rd., Jimei North Ind. Dist., Xiamen

E-mail: marketing@hongfa.com

SALES SERVICE HOTLINE

**400-600-1502**



HONGFA GROUP



HONGFA ESC

Printed in May 2023