

Contactors Catalogue

For more information please visit our website:

www.hongfa.com



XIAMEN HONGFA ELECTRICAL SAFETY & CONTROLS CO.,LTD.
ADD:No.566 Donglin Road,Jimei North ind. District,Xiamen 361021



Established in 1984, Hongfa (stock code: 600885) has achieved the scale of multi-category products research/production and international sales abiding by the enterprise spirit of “Persevere for Progress, Strive for Excellence”. At present, Hongfa owns 38 fully-owned or holding subsidiaries with completed factory area of 350 thousand square meters and new factory area of 540 thousand square meters under construction. Hongfa products including switching devices (circuit breaker, contactor, SPD etc.), high/low voltage switchgear, relay, precision components, automation equipments etc.

Hongfa technical center, which is of state class in China, the R&D team is constituted of top technical personnel in the industry. The center has led the formulation of several national standards and implementation of several national key projects. Meanwhile, Hongfa is the only enterprise that owns postdoctor working station and academician working station of the industry in China.

Hongfa test & inspection center is the biggest and technically most advanced inspection and analysis lab of the industry in China. Also, the center is approved by VDE (German), UL (North America) and CNAS (China). Hongfa has gotten domestic/overseas safety certificates of UL/CUL, VDE, TÜV, CQC etc. for its products.

Hongfa Sales Center exploit the international high level market with abundant experience and advantage, which has won the strategic cooperation opportunity with the worldwide famous switching and electrification devices manufacturer. Many worldwide top 500 enterprises and domestic famous companies have become our partners, such as SAMSUNG, UTC, EATON, ENEL, INGERSOLL RAND, JCI, GE, EMERSON, HONEYWELL, Faxcoon, China State Grid, China Southern Grid, China Telecom, China Railway Engineering, China Railway Construction, China Coal, China Shenhua Group, China Huadian Group, China Guodian Group, China Huaneng, China Datang, Greenland Group, Gold Wind, TBEA, Gree, Media, Haier, and regional power companies.

Hongfa is willing to develop with global customers hand in hand to share the convenience and achievement brought to the humanbeing by the technology!

Cross reference

Definite Purpose Contactors

HONGFA	Tyco/PU	Siemens/Furnas	GE	CUTLER –hammer	Schneider/Square D.	Honeywell
XMC0	3100	42/45	CR453	C25	8910	R82



Contents

XMC0 Series

Description	▶ 01
Features	▶ 01
Environmental Characteristics	▶ 01
Model Nomenclature-Ordering Information	▶ 02
Characteristics	▶ 04
Outline Dinmensions	▶ 07
Wiring Diagram	▶ 16
Main Contact Terminals	▶ 17
Remarks	▶ 18

XMC0 Series

Definite Purpose Contactors

Description

Hongfa's Definite Purpose Contactor XMC0 meets the high requirements demands of the HVAC, refrigeration, heating,

data processing, welding, elevators, hoist & cranes, pool, commercial spa, and food service equipment industries. Hongfa contactors are compliance with UL 60947-4-1, GB/T 14048.4, IEC 60947-4-1 and EN 60947-4-1.



Features

1. Tools-free accessories for quick & easy snap on assembly.
2. Various terminal options for specific application.
3. Standard mounting plate.
4. Silver alloy contact can reach higher electrical endurance.
5. Class F (155°C) Coil insulation supporting a wide range of coil voltage, standard coil frequency 50/60Hz.
6. Coil cover optional for 1 pole and 2 pole AC contactors.
7. UL(USR/CNR) and CCC approved, some models with TÜV or KC certificate.
8. Flame arrest-protected components for use in refrigeration and air-conditioning equipment employing A2L refrigerants (Except for 2 poles w/ the contact normally closed, 1 pole & 2 poles w/ DC coil and 4 poles).
9. XMC0 25-63A of 1 pole, 2 poles and 3 poles have the test button on the cover.

Environmental characteristics

Operating position		Vertical or Horizontal (Metal/Plastic base mounting)
Ambient temperature	Operation	-40°C ~ +70°C/ -40°F ~ +158°F
	Storage	-40°C ~ +70°C / -40°F ~ +158°F
Relative humidity		90%~95%RH at 40°C
Pollution degree		3

Model nomenclature - Ordering Information

Model nomenclature - Ordering Information

XMC	0	- 50	J33	.	E	B	B	C	0	0	F	N	G	Z	W	-X						
<table><tr><td>Product Type</td><td>Option</td></tr><tr><td>XMC = Contactor Series</td><td>Customer assigned suffix "X" where "X" may be any alphanumeric character or any combined alphanumeric character.</td></tr></table>																	Product Type	Option	XMC = Contactor Series	Customer assigned suffix "X" where "X" may be any alphanumeric character or any combined alphanumeric character.		
Product Type	Option																					
XMC = Contactor Series	Customer assigned suffix "X" where "X" may be any alphanumeric character or any combined alphanumeric character.																					
<table><tr><td>Design Sequence Number</td><td>A2L Option</td></tr><tr><td>0 = Design Sequence Number</td><td>Blank = Non-A2L/Standard product W = A2L Compliant</td></tr></table>																	Design Sequence Number	A2L Option	0 = Design Sequence Number	Blank = Non-A2L/Standard product W = A2L Compliant		
Design Sequence Number	A2L Option																					
0 = Design Sequence Number	Blank = Non-A2L/Standard product W = A2L Compliant																					
<table><tr><td>Full Load Amperes (FLA)</td><td>Contact Construction Style (For 50/63 FLA only)</td></tr><tr><td>25 = 25A 32 = 32A 40 = 40A 50 = 50A</td><td>Blank = Flat construction in shape Z = Bend construction in shape (No "Break All Lines" restriction)</td></tr></table>																	Full Load Amperes (FLA)	Contact Construction Style (For 50/63 FLA only)	25 = 25A 32 = 32A 40 = 40A 50 = 50A	Blank = Flat construction in shape Z = Bend construction in shape (No "Break All Lines" restriction)		
Full Load Amperes (FLA)	Contact Construction Style (For 50/63 FLA only)																					
25 = 25A 32 = 32A 40 = 40A 50 = 50A	Blank = Flat construction in shape Z = Bend construction in shape (No "Break All Lines" restriction)																					
<table><tr><td>Number of Poles</td><td>Main Contact Quick Terminals</td></tr><tr><td>1 = 1-pole+shunt (25-40A) 7 = 1-pole (25-40A) 2 = 2-pole (25-40A) 2C = 2-pole Normal Close (40A,UL approved only) 3 = 3-pole (25-90A) 3A = 2-pole (3P frame, 25-90A) 4 = 4-pole (25-40A,UL approved only) Jmn = Matching mechanically interlocked block (3P/4P frame). "m" = 3A or 3 or 4, number of poles of the contactor A (on the left) and "n" = 3A or 3 or 4, number of poles of the contactor B (on the right). Note: Quantum series only available for 2P/3P/4P frame, please contact us if you have any request.</td><td>Blank = Quad Terminals in 1- and 2- pole models and Dual Terminals in 3/4-pole models G = None QC Terminals Q = Quad Terminals in 3/4-pole models (Only the side no coil terminals)</td></tr></table>																	Number of Poles	Main Contact Quick Terminals	1 = 1-pole+shunt (25-40A) 7 = 1-pole (25-40A) 2 = 2-pole (25-40A) 2C = 2-pole Normal Close (40A,UL approved only) 3 = 3-pole (25-90A) 3A = 2-pole (3P frame, 25-90A) 4 = 4-pole (25-40A,UL approved only) Jmn = Matching mechanically interlocked block (3P/4P frame). "m" = 3A or 3 or 4, number of poles of the contactor A (on the left) and "n" = 3A or 3 or 4, number of poles of the contactor B (on the right). Note: Quantum series only available for 2P/3P/4P frame, please contact us if you have any request.	Blank = Quad Terminals in 1- and 2- pole models and Dual Terminals in 3/4-pole models G = None QC Terminals Q = Quad Terminals in 3/4-pole models (Only the side no coil terminals)		
Number of Poles	Main Contact Quick Terminals																					
1 = 1-pole+shunt (25-40A) 7 = 1-pole (25-40A) 2 = 2-pole (25-40A) 2C = 2-pole Normal Close (40A,UL approved only) 3 = 3-pole (25-90A) 3A = 2-pole (3P frame, 25-90A) 4 = 4-pole (25-40A,UL approved only) Jmn = Matching mechanically interlocked block (3P/4P frame). "m" = 3A or 3 or 4, number of poles of the contactor A (on the left) and "n" = 3A or 3 or 4, number of poles of the contactor B (on the right). Note: Quantum series only available for 2P/3P/4P frame, please contact us if you have any request.	Blank = Quad Terminals in 1- and 2- pole models and Dual Terminals in 3/4-pole models G = None QC Terminals Q = Quad Terminals in 3/4-pole models (Only the side no coil terminals)																					
<table><tr><td>Coil Voltage</td><td>Coil Cover (For 1 & 2 Pole only)</td></tr><tr><td>E = 24VAC 50/60Hz F = 110-120VAC 50/60Hz I = 208-220VAC 50Hz 208-240VAC 60Hz L = 277VAC 60Hz N = 380-415VAC 50Hz 440-480VAC 60Hz U = 550-600VAC 50/60Hz P = 12VDC (For 1P/1P+shunt/2P,UL approved only) Q = 24VDC (For 1P/1P+shunt/2P,UL approved only) R = 36VDC (For 1P/1P+shunt/2P,UL approved only) Note: Please contact us if you have any other request.</td><td>Blank = W/o coil cover N = W/ coil cover Note: Only applicable to some specific customers in the North America, please contact us if you have any request.</td></tr></table>																	Coil Voltage	Coil Cover (For 1 & 2 Pole only)	E = 24VAC 50/60Hz F = 110-120VAC 50/60Hz I = 208-220VAC 50Hz 208-240VAC 60Hz L = 277VAC 60Hz N = 380-415VAC 50Hz 440-480VAC 60Hz U = 550-600VAC 50/60Hz P = 12VDC (For 1P/1P+shunt/2P,UL approved only) Q = 24VDC (For 1P/1P+shunt/2P,UL approved only) R = 36VDC (For 1P/1P+shunt/2P,UL approved only) Note: Please contact us if you have any other request.	Blank = W/o coil cover N = W/ coil cover Note: Only applicable to some specific customers in the North America, please contact us if you have any request.		
Coil Voltage	Coil Cover (For 1 & 2 Pole only)																					
E = 24VAC 50/60Hz F = 110-120VAC 50/60Hz I = 208-220VAC 50Hz 208-240VAC 60Hz L = 277VAC 60Hz N = 380-415VAC 50Hz 440-480VAC 60Hz U = 550-600VAC 50/60Hz P = 12VDC (For 1P/1P+shunt/2P,UL approved only) Q = 24VDC (For 1P/1P+shunt/2P,UL approved only) R = 36VDC (For 1P/1P+shunt/2P,UL approved only) Note: Please contact us if you have any other request.	Blank = W/o coil cover N = W/ coil cover Note: Only applicable to some specific customers in the North America, please contact us if you have any request.																					
<table><tr><td>Mounting Plate</td><td>Coil Terminals</td></tr><tr><td>Blank = Metal plate (Quantum series) B = Metal plate</td><td>Blank = Dual QC w/o screw in 1- and 2- pole models and Single QC with screw in 3/4-pole models V = The coil terminals are vertical (For 1 & 2 Pole only) F = Dual QC in 3/4-pole models</td></tr></table>																	Mounting Plate	Coil Terminals	Blank = Metal plate (Quantum series) B = Metal plate	Blank = Dual QC w/o screw in 1- and 2- pole models and Single QC with screw in 3/4-pole models V = The coil terminals are vertical (For 1 & 2 Pole only) F = Dual QC in 3/4-pole models		
Mounting Plate	Coil Terminals																					
Blank = Metal plate (Quantum series) B = Metal plate	Blank = Dual QC w/o screw in 1- and 2- pole models and Single QC with screw in 3/4-pole models V = The coil terminals are vertical (For 1 & 2 Pole only) F = Dual QC in 3/4-pole models																					
<table><tr><td>Top Cover</td><td>Auxiliary Contacts or Microswitch on Left Side (For 3/4-pole models only)</td><td>Auxiliary Contacts or Microswitch on Right Side (For 3/4-pole models only)</td></tr><tr><td>Blank = Short cover (Quantum series) B = Short cover</td><td>0 = None (Standard Type) 1 = 1NC + 1NO, 0.250" quick connect terminal 3 = 1NC, 0.250" quick connect terminal 4 = 1NO, 0.250" quick connect terminal 5 = 2NC, 0.250" quick connect terminal 6 = 2NO, 0.250" quick connect terminal 1P = 1NC + 1NO, pressure plate screw 3P = 1NC, pressure plate screw 4P = 1NO, pressure plate screw 5P = 2NC, pressure plate screw 6P = 2NO, pressure plate screw L = 2 SPDT L1 = 1 SPDT, left side (position 1) of microswitch block L2 = 1 SPDT, right side (position 2) of microswitch block</td><td>0 = None (Standard Type) 1 = 1NC + 1NO, 0.250" quick connect terminal 3 = 1NC, 0.250" quick connect terminal 4 = 1NO, 0.250" quick connect terminal 5 = 2NC, 0.250" quick connect terminal 6 = 2NO, 0.250" quick connect terminal 1P = 1NC + 1NO, pressure plate screw 3P = 1NC, pressure plate screw 4P = 1NO, pressure plate screw 5P = 2NC, pressure plate screw 6P = 2NO, pressure plate screw R = 2 SPDT R1 = 1 SPDT, left side (position 1) of microswitch block R2 = 1 SPDT, right side (position 2) of microswitch block</td></tr></table>																	Top Cover	Auxiliary Contacts or Microswitch on Left Side (For 3/4-pole models only)	Auxiliary Contacts or Microswitch on Right Side (For 3/4-pole models only)	Blank = Short cover (Quantum series) B = Short cover	0 = None (Standard Type) 1 = 1NC + 1NO, 0.250" quick connect terminal 3 = 1NC, 0.250" quick connect terminal 4 = 1NO, 0.250" quick connect terminal 5 = 2NC, 0.250" quick connect terminal 6 = 2NO, 0.250" quick connect terminal 1P = 1NC + 1NO, pressure plate screw 3P = 1NC, pressure plate screw 4P = 1NO, pressure plate screw 5P = 2NC, pressure plate screw 6P = 2NO, pressure plate screw L = 2 SPDT L1 = 1 SPDT, left side (position 1) of microswitch block L2 = 1 SPDT, right side (position 2) of microswitch block	0 = None (Standard Type) 1 = 1NC + 1NO, 0.250" quick connect terminal 3 = 1NC, 0.250" quick connect terminal 4 = 1NO, 0.250" quick connect terminal 5 = 2NC, 0.250" quick connect terminal 6 = 2NO, 0.250" quick connect terminal 1P = 1NC + 1NO, pressure plate screw 3P = 1NC, pressure plate screw 4P = 1NO, pressure plate screw 5P = 2NC, pressure plate screw 6P = 2NO, pressure plate screw R = 2 SPDT R1 = 1 SPDT, left side (position 1) of microswitch block R2 = 1 SPDT, right side (position 2) of microswitch block
Top Cover	Auxiliary Contacts or Microswitch on Left Side (For 3/4-pole models only)	Auxiliary Contacts or Microswitch on Right Side (For 3/4-pole models only)																				
Blank = Short cover (Quantum series) B = Short cover	0 = None (Standard Type) 1 = 1NC + 1NO, 0.250" quick connect terminal 3 = 1NC, 0.250" quick connect terminal 4 = 1NO, 0.250" quick connect terminal 5 = 2NC, 0.250" quick connect terminal 6 = 2NO, 0.250" quick connect terminal 1P = 1NC + 1NO, pressure plate screw 3P = 1NC, pressure plate screw 4P = 1NO, pressure plate screw 5P = 2NC, pressure plate screw 6P = 2NO, pressure plate screw L = 2 SPDT L1 = 1 SPDT, left side (position 1) of microswitch block L2 = 1 SPDT, right side (position 2) of microswitch block	0 = None (Standard Type) 1 = 1NC + 1NO, 0.250" quick connect terminal 3 = 1NC, 0.250" quick connect terminal 4 = 1NO, 0.250" quick connect terminal 5 = 2NC, 0.250" quick connect terminal 6 = 2NO, 0.250" quick connect terminal 1P = 1NC + 1NO, pressure plate screw 3P = 1NC, pressure plate screw 4P = 1NO, pressure plate screw 5P = 2NC, pressure plate screw 6P = 2NO, pressure plate screw R = 2 SPDT R1 = 1 SPDT, left side (position 1) of microswitch block R2 = 1 SPDT, right side (position 2) of microswitch block																				
<table><tr><td>Main Contact Terminals</td><td colspan="2">For example: (Refer to HF logo position,see page 12.)</td></tr><tr><td>C = Slotted & Hex head washer w/ quick connect D = Box Lug w/ quick connect E = Box lug w/ quick connect (Line side) Slotted & Hex head washer w/ quick connect (Load side) F = Slotted & Hex head washer w/ quick connect (Line side) Box lug w/ quick connect (Load side) Note: Please contact us if you have any other request.</td><td colspan="2">34P = 1NC 0.250" quick connect terminal on left side 1NO pressure plate screw on right side LR1 = 2 SPDT on left side 1 SPDT (position 1 of microswitch block) on right side 3R2 = 1NC 0.250" quick connect terminal on left side 1 SPDT (position 2 of microswitch block) on right side Note: If "00" will be the final digits in selection, omit from model nomenclature.</td></tr></table>																	Main Contact Terminals	For example: (Refer to HF logo position,see page 12.)		C = Slotted & Hex head washer w/ quick connect D = Box Lug w/ quick connect E = Box lug w/ quick connect (Line side) Slotted & Hex head washer w/ quick connect (Load side) F = Slotted & Hex head washer w/ quick connect (Line side) Box lug w/ quick connect (Load side) Note: Please contact us if you have any other request.	34P = 1NC 0.250" quick connect terminal on left side 1NO pressure plate screw on right side LR1 = 2 SPDT on left side 1 SPDT (position 1 of microswitch block) on right side 3R2 = 1NC 0.250" quick connect terminal on left side 1 SPDT (position 2 of microswitch block) on right side Note: If "00" will be the final digits in selection, omit from model nomenclature.	
Main Contact Terminals	For example: (Refer to HF logo position,see page 12.)																					
C = Slotted & Hex head washer w/ quick connect D = Box Lug w/ quick connect E = Box lug w/ quick connect (Line side) Slotted & Hex head washer w/ quick connect (Load side) F = Slotted & Hex head washer w/ quick connect (Line side) Box lug w/ quick connect (Load side) Note: Please contact us if you have any other request.	34P = 1NC 0.250" quick connect terminal on left side 1NO pressure plate screw on right side LR1 = 2 SPDT on left side 1 SPDT (position 1 of microswitch block) on right side 3R2 = 1NC 0.250" quick connect terminal on left side 1 SPDT (position 2 of microswitch block) on right side Note: If "00" will be the final digits in selection, omit from model nomenclature.																					

Type Model Nomenclature - Ordering Information

Auxiliary Contact Blocks:

C03	A	11	P	Q	X
Basic Designation					
C03 = For XMC0 3P/4P Series Definite Purpose Contactors.					
Accessory Category					
A = Auxiliary Contacts Block					
Contact Type					
01 = 1NC 10 = 1NO 11 = 1NC + 1NO 02 = 2NC 20 = 2NO					
Note: NC = Normally Closed, NO = Normally Opened.					
Quick Connect Terminals					
Blank = 0.250" quick connect terminals P = Pressure plate screw (None QC terminals)					
Used Function					
Q = Match with Quantum series					
Option					
Customer assigned suffix "X" where "X" may be any alphanumeric character or any combined alphanumeric character.					

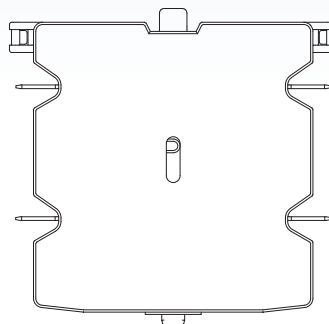

Microswitch Blocks:

C03	M	10	Q	X
Basic Designation				
C03 = For XMC0 3P/4P Series Definite Purpose Contactors.				
Accessory Category				
M = Microswitch Block				
Contact Type				
Microswitch at Left side(position 1) for Microswitch Assembly		Microswitch at Right side(position 2) for Microswitch Assembly		
0 = None	3 = 1 SPST-NC	0 = None	3 = 1 SPST-NC	
1 = 1 SPDT	4 = 1 SPST-NO	1 = 1 SPDT	4 = 1 SPST-NO	
Note: SPDT = Single Pole Double Throw, SPST = Single Pole Single Throw, NC = Normally Closed, NO = Normally Opened.				
Used Function				
Q = Match with Quantum series				
Option				
Customer assigned suffix "X" where "X" may be any alphanumeric character or any combined alphanumeric character.				

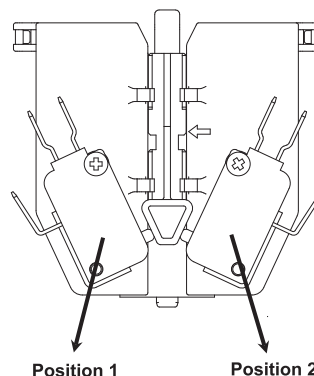

Interlock Blocks:

C03	J	1Q	X
Basic Designation			
C03 = For XMC0 3P/4P Series Definite Purpose Contactors.			
Accessory Category			
J = Mechanically Interlocked Block			
Interlock Type			
2Q = Match with 75-90A(Quantum series) 1Q = Match with 25-63A(Quantum series)			
Option			
Customer assigned suffix "X" where "X" may be any alphanumeric character or any combined alphanumeric character.			

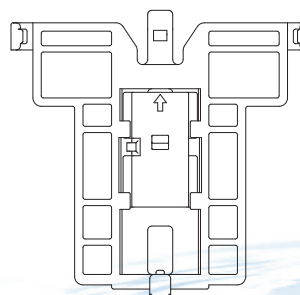

DIN Rail Adapters:

C01 D 1 X

Basic Designation
C01 = For XMC0 1P/2P Series Definite Purpose Contactors.
Accessory Category
D = DIN rail adapter
Used Function
1 = Match with 25-40A
Option
Customer assigned suffix "X" where "X" may be any alphanumeric character or any combined alphanumeric character.

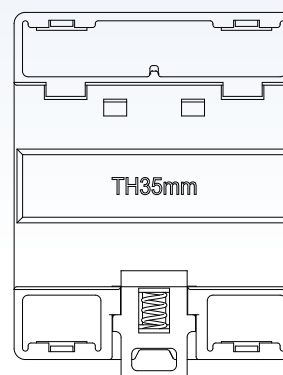

Characteristics

Full Load Amps (FLA)	Poles	Voltage	Locked Rotor Amps (LRA)	Resistive Amps Rating (RES)	Maximum Horsepower (HP)			Catalog Number
					Voltage	Single Phase	Three Phase	
25	1	240/277 480 600	150 125 100	35	240/277	2	-	XMC0-257* XMC0-251*
32	1	240/277 480 600	180 150 120	40	240/277	2	-	XMC0-327* XMC0-321*
40	1	240/277 480 600	240 200 160	50	240/277	3	-	XMC0-407* XMC0-401
25	1	240/277 480 600	120 100 80	35	240/277	2	-	XMC0-257* XMC0-251* (DC Coil)
32	1	240/277 480 600	150 125 100	40	240/277	2	-	XMC0-327* XMC0-321* (DC Coil)
40	1	240/277 480 600	200 160 120	50	240/277	3	-	XMC0-407* XMC0-401 (DC Coil)
25	2	240/277 480 600	150 125 100	35	240/277	3	-	XMC0-252*
32	2	240/277 480 600	180 150 120	40	240/277	3	-	XMC0-322*
40	2	240/277 480 600	240 200 160	50	240/277	3	-	XMC0-402*
25	2	240/277 480 600	120 100 80	35	240/277	2	-	XMC0-252* (DC Coil)
32	2	240/277 480 600	150 125 100	40	240/277	2	-	XMC0-322* (DC Coil)
40	2	240/277 480 600	200 160 120	50	240/277	3	-	XMC0-402* (DC Coil)
40	2C	240/277	180	50	240/277	-	-	XMC0-402C*

Characteristics (Continued)

Full Load Amps(FLA)	Poles	Voltage	Locked Rotor Amps (LRA)	Resistive Amps Rating (RES)	Maximum Horsepower(HP)			Catalog Number
					Voltage	Single Phase	Three Phase	
25	2	240/277	150	35	240/277	3	7.5	XMC0-253A*
	3	480	125		480	-	15	XMC0-253*
	4	600	100		600	-	20	XMC0-254*
32	2	240/277	180	40	240/277	5	10	XMC0-323A*
	3	480	150		480	-	15	XMC0-323*
	4	600	120		600	-	20	XMC0-324*
40	2	240/277	240	50	240/277	7.5	10	XMC0-403A*
	3	480	200		480	-	20	XMC0-403*
	4	600	160		600	-	25	XMC0-404*
50	2	240/277	300	63	240/277	10	15	XMC0-503A*
	3	480	250		480	-	25	XMC0-503*
		600	200+		600	-	25	
63	2	240/277	360	75	240/277	10	20	XMC0-633A*
	3	480	300		480	-	30	XMC0-633*
		600	240+		600	-	30	
50	2	240/277	300	63	240/277	10	15	XMC0-503A*Z
	3	480	250		480	-	25	XMC0-503*Z
		600	200		600	-	25	
63	2	240/277	360	75	240/277	10	20	XMC0-633A*Z
	3	480	300		480	-	30	XMC0-633*Z
		600	240		600	-	30	
75	2	240/277	450	94	240/277	15	25	XMC0-753A*
	3	480	375		480	-	40	XMC0-753*
		600	300		600	-	40	
90	2	240/277	540	120	240/277	20	30	XMC0-903A*
	3	480	450		480	-	50	XMC0-903*
		600	360		600	-	50	

Notes:

1. All models can be used for the application which is no higher than the certificated load, including certificated voltage, FLA, LRA or RES.
2. All the ratings have no "Break All Lines" restriction, except the rating "600VAC 50FLA/200LRA" for "XMC0-50 without Z" and "600VAC 63FLA/240LRA" for "XMC0-63 without Z".
3. Contact factory representative for Cd free option.

Auxiliary Contacts Block Characteristics

Contact Type:	Rated voltage (VAC)	120	240	480	600
1NO, 1NC,	Breaking current (A)	3.0	1.5	0.75	0.6
1NO+1NC,	Making current (A)	30	15	7.5	6
2NO, 2NC	Conventional free air thermal current	10	10	10	10

Microswitch Blocks Characteristics

Contact type - SPDT	10A or 11A or 16A, 1/3 HP, 125VAC or 250 VAC 1/2A, 125 VDC; 1/4A, 250 VDC 4A 120 VAC on Lamp Load
Note: Please contact us if you have any other request.	

AC Coil characteristics @ 25℃ (Cold state)

Part number	Nominal Coil Voltage	Nominal Inrushed VA		Nominal Sealed VA		Maximum Pick-up Volts	Drop-out Volts Range
		60Hz	50Hz	60Hz	50Hz		
XMC0-□1/7	24	25	27	6.5	8.5	18	6-15
	120	25	27	7	9	88	25-70
	208/240	27	25	8.5	8.5	176	50-140
	277	25	-	8.5	-	215	60-165
XMC0-□2	24	25	27	6.5	8.5	18	6-15
	120	25	27	7	9	88	25-70
	208/240	27	25	8.5	8.5	176	50-140
	277	25	-	8.5	-	215	60-165
XMC0-□2C	208/240	30	28	7.5	8	176	50-140
XMC0-□3/3A	24	50	55	8	10	18	6-15
	120	60	65	10	13.5	88	25-70
	208/240	50	45	9.5	9.5	176	50-140
	277	50	-	10.5	-	215	60-165
XMC0-□4	24	55	60	9	12	18	6-15
	120	60	65	11	14	88	25-70
	208/240	60	55	12	12.5	176	50-140
	277	60	-	11.5	-	215	60-165
XMC0-503/633	24	90	100	12.5	16.5	18	6-15
	120	90	100	13	17	88	25-70
	208/240	100	90	15	15	176	50-140
	277	90	-	14	-	215	60-165
XMC0-753/903	24	190	210	23.5	30	18	6-15
	120	230	255	30.5	38.5	88	25-70
	208/240	240	230	32	32	176	50-140
	277	210	-	25	-	215	60-165

Notes:

1. $U_s=24VAC$ 50/60Hz ("E" coil) or $120VAC$ 50/60Hz ("F" coil) or $220VAC/50Hz$, $240VAC/60Hz$ ("I" coil) or $277VAC/60Hz$ ("L" coil).
2. Inrushed and Sealed VA are tested at U_s .
3. Please contact us if you have any other request.

DC Coil characteristics @ 25℃ (Cold state)

Part number	Nominal Coil Voltage	Nominal Inrushed /Sealed Watts	Maximum Inrushed /Sealed Watts	Maximum Pick-up Volts	Minimum Drop-out Volts
XMC0-□1/7	12	5	6	9.6	1.2
	24	5	6	19.2	2.4
	36	5	6	28.7	3.6
XMC0-□2	12	5	6	9.6	1.2
	24	5	6	19.2	2.4
	36	5	6	28.7	3.6

Notes:

1. Inrushed and Sealed VA are tested at Us.

Outline Dimensions

Unit:mm

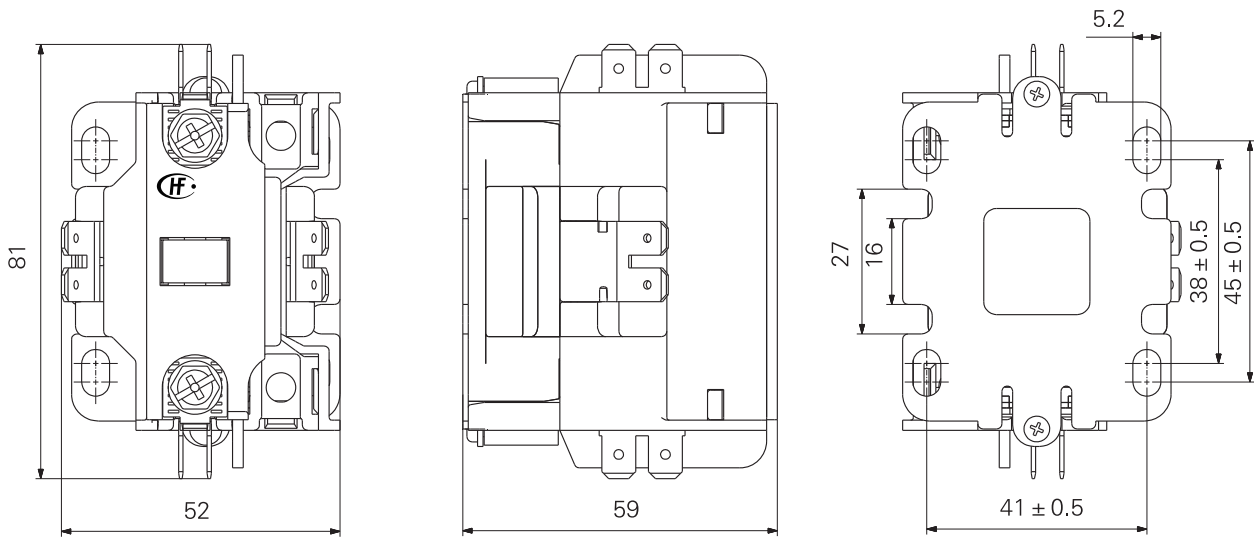

1 pole (metal base, 25-40FLA)

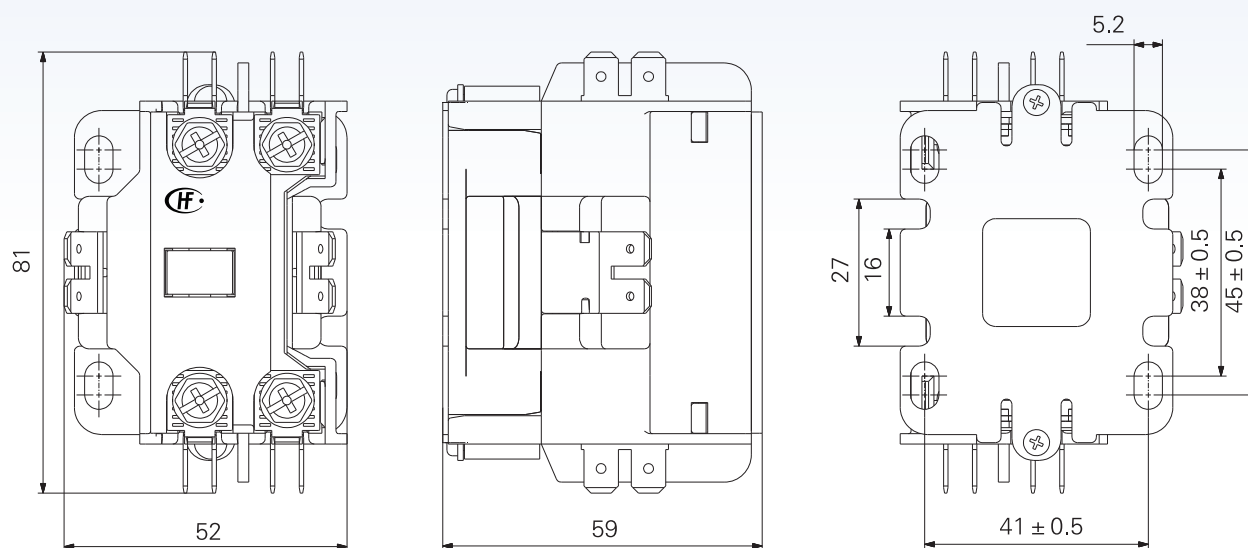

1 pole+shunt (metal base, 25-40FLA)

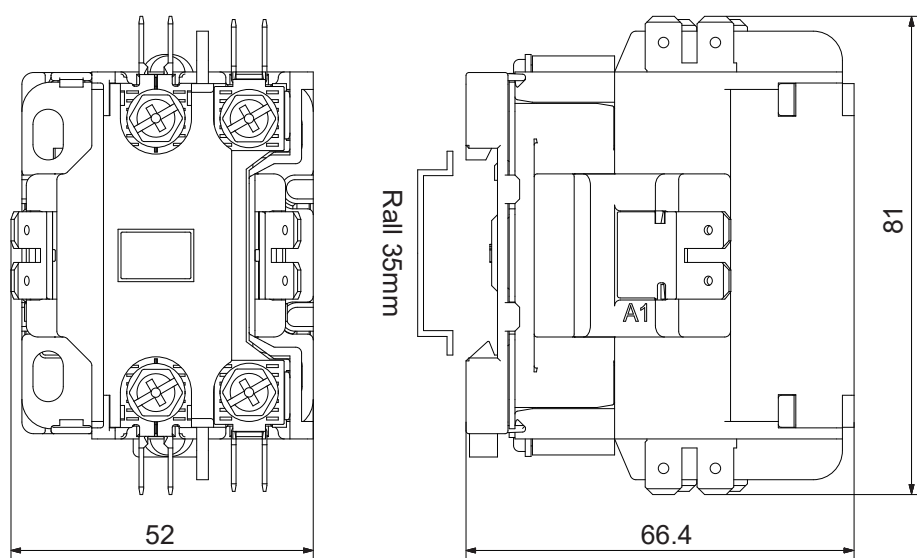

1 pole+shunt (rail mounting, 25-40FLA)

Outline Dimensions

Unit:mm

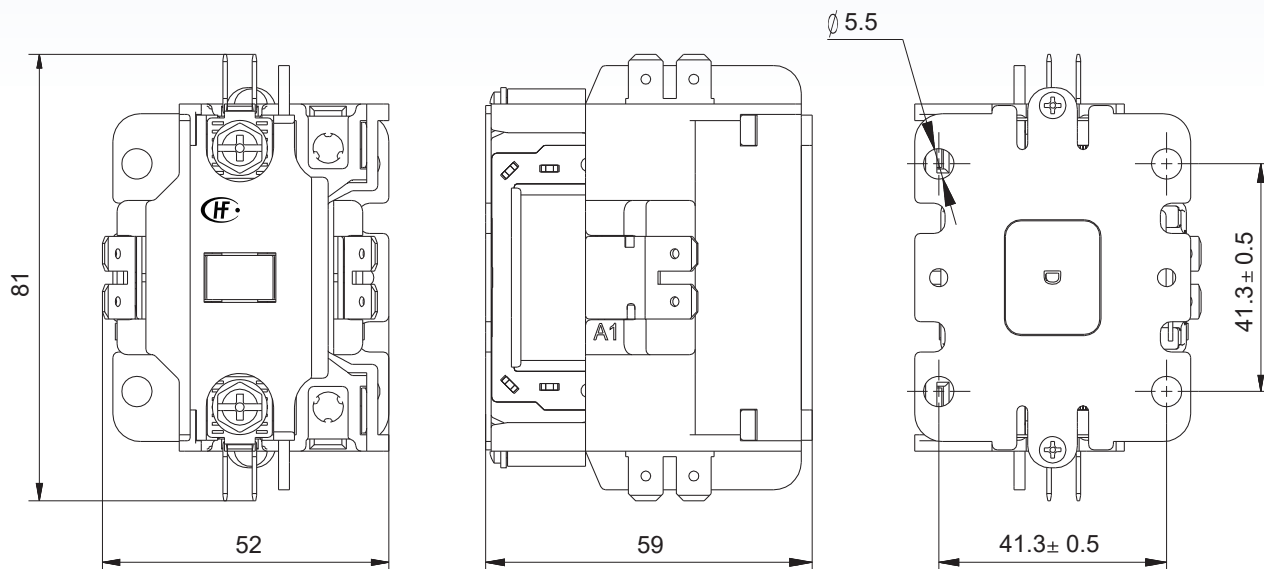

1 pole (metal base, 25-40FLA) - DC Coil, UL approved only

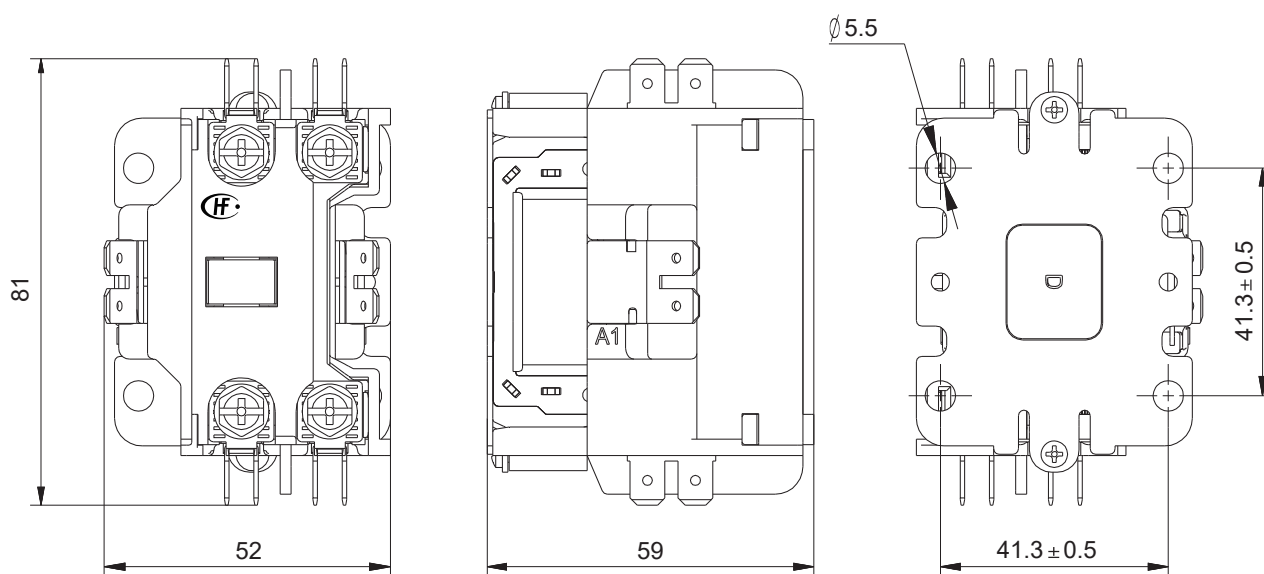

1 pole+shunt (metal base, 25-40FLA) - DC Coil, UL approved only

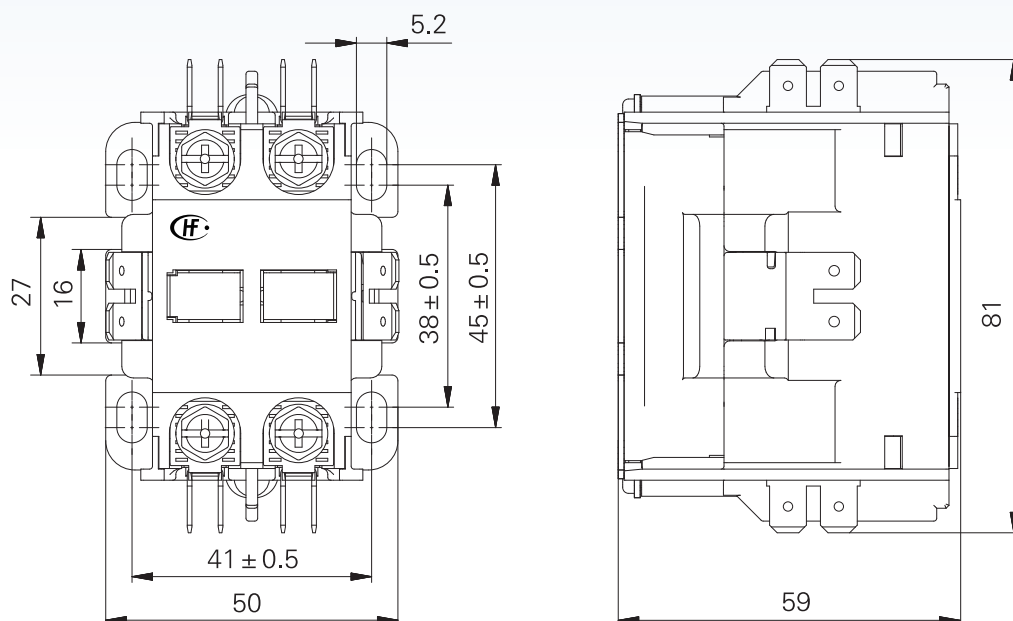

2 poles (metal base, 25-40FLA)

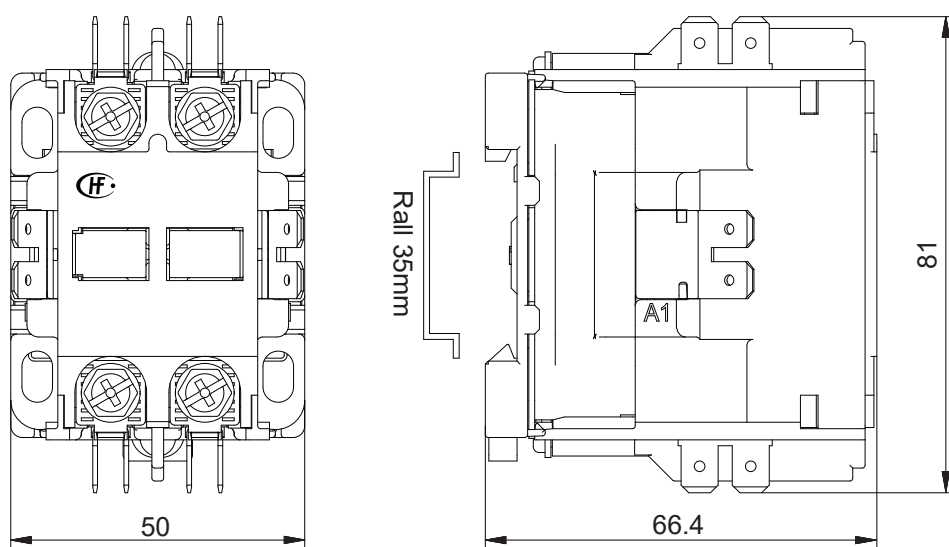

2 poles (rail mounting, 25-40FLA)

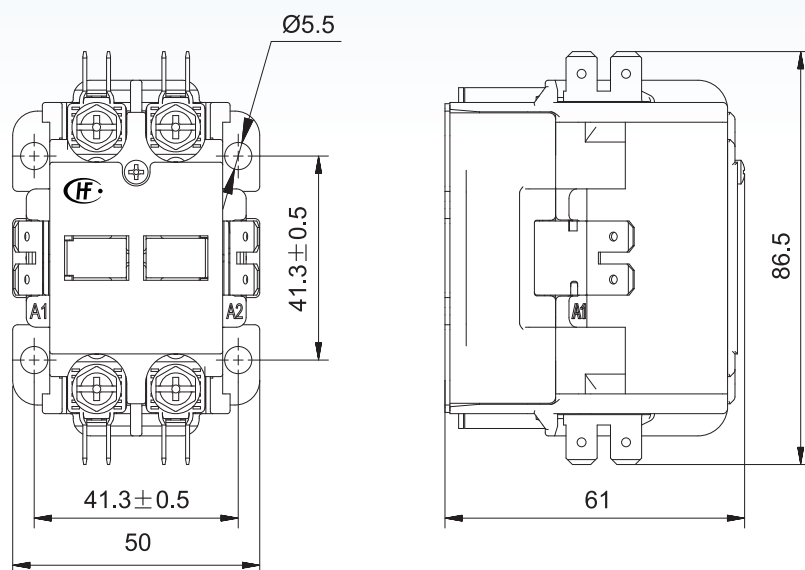

2 poles (metal base, 25-40FLA) - Quantum series (Charging Pile etc.)

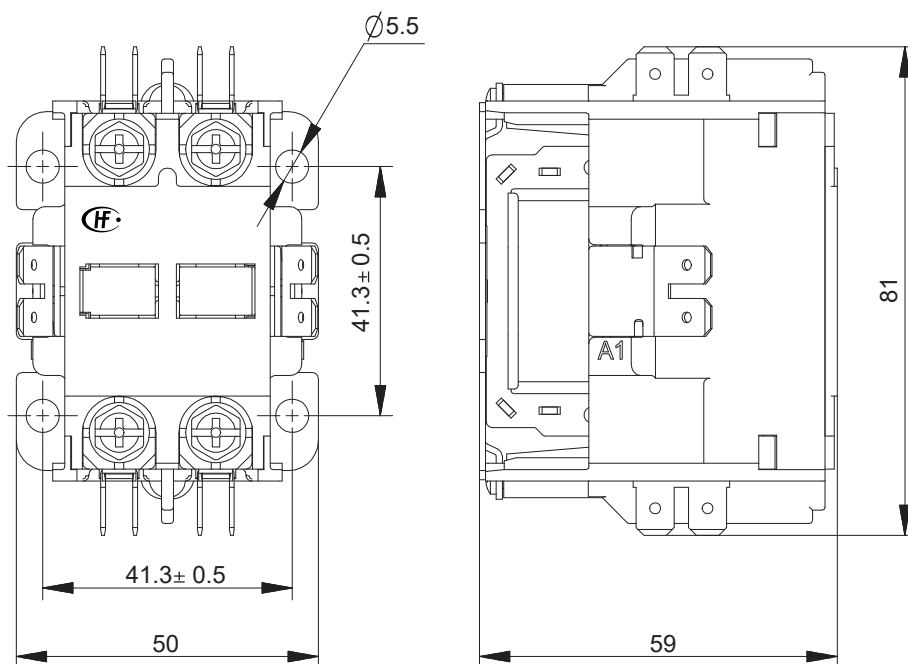

2 poles (metal base, 25-40FLA) – DC Coil, UL approved only

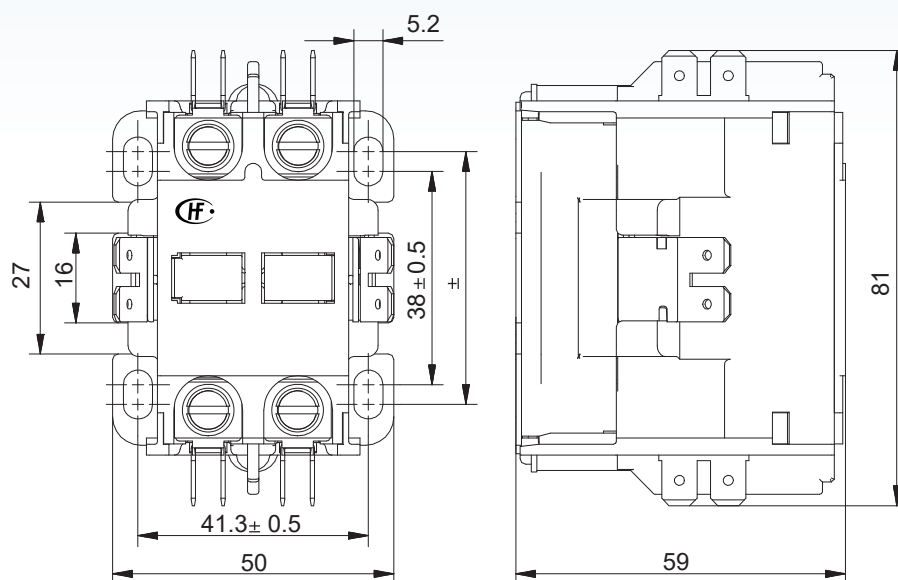

2 poles (metal base, 40FLA) – Normal Close, UL approved only

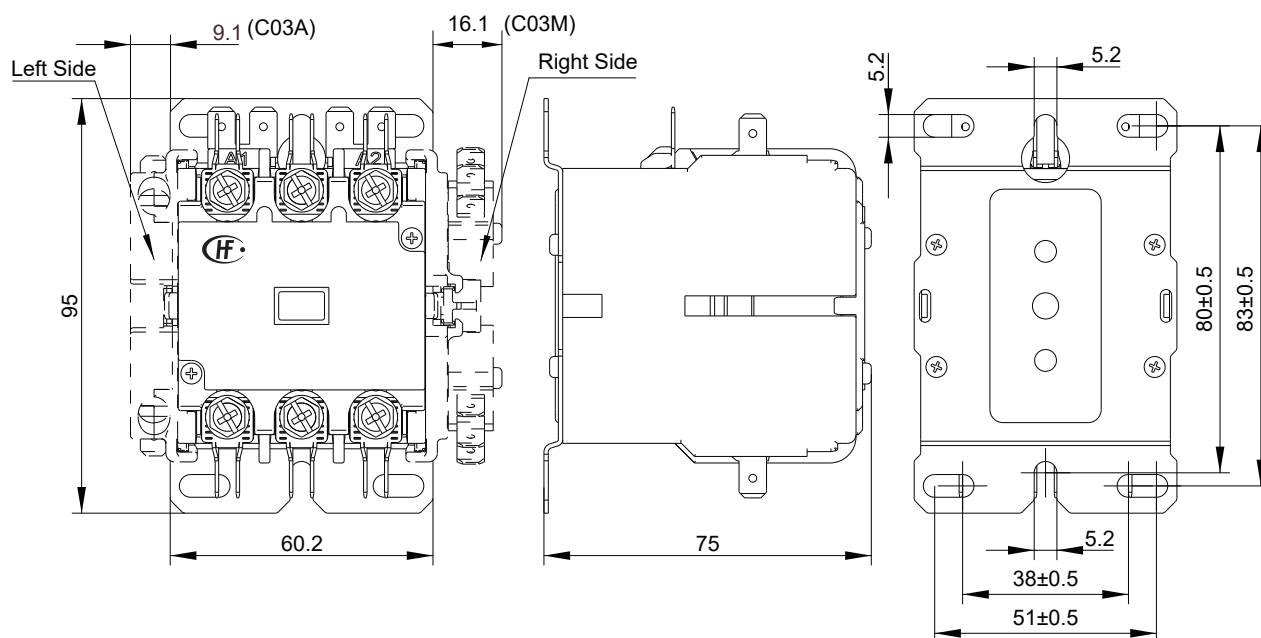

3 poles (metal base, 25-40FLA) - Quantum series

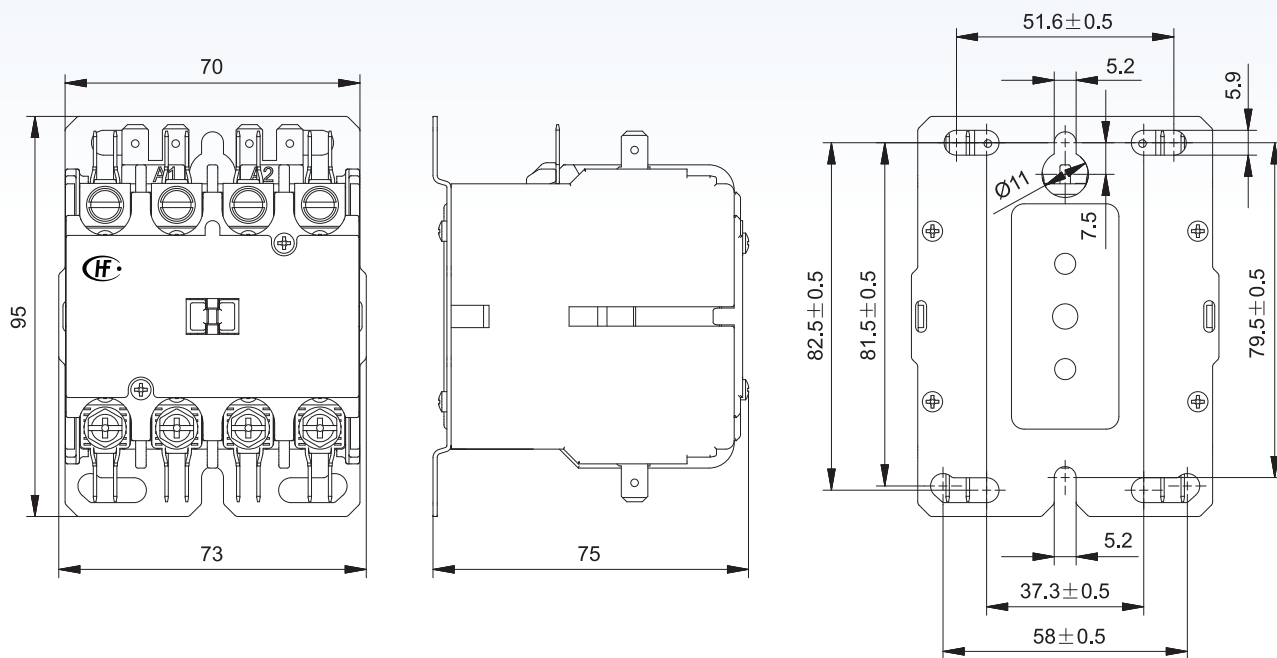

4 poles (metal base, 25-40FLA) - Quantum series, UL approved only

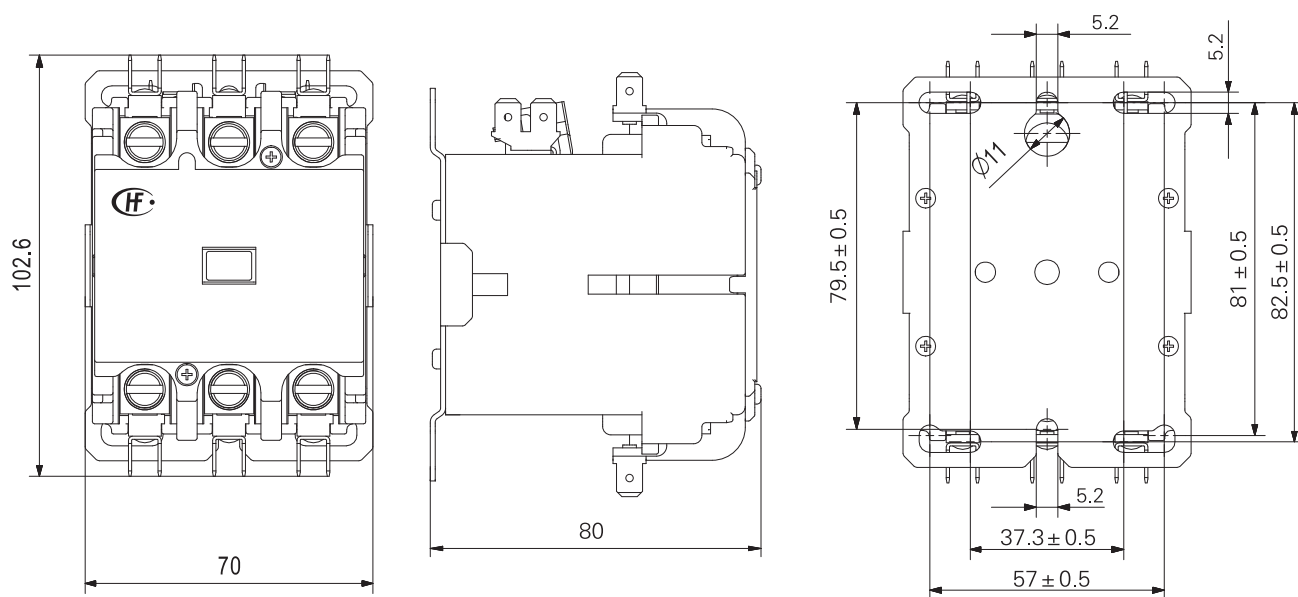

3 poles (metal base, 50-63FLA) - Quantum series

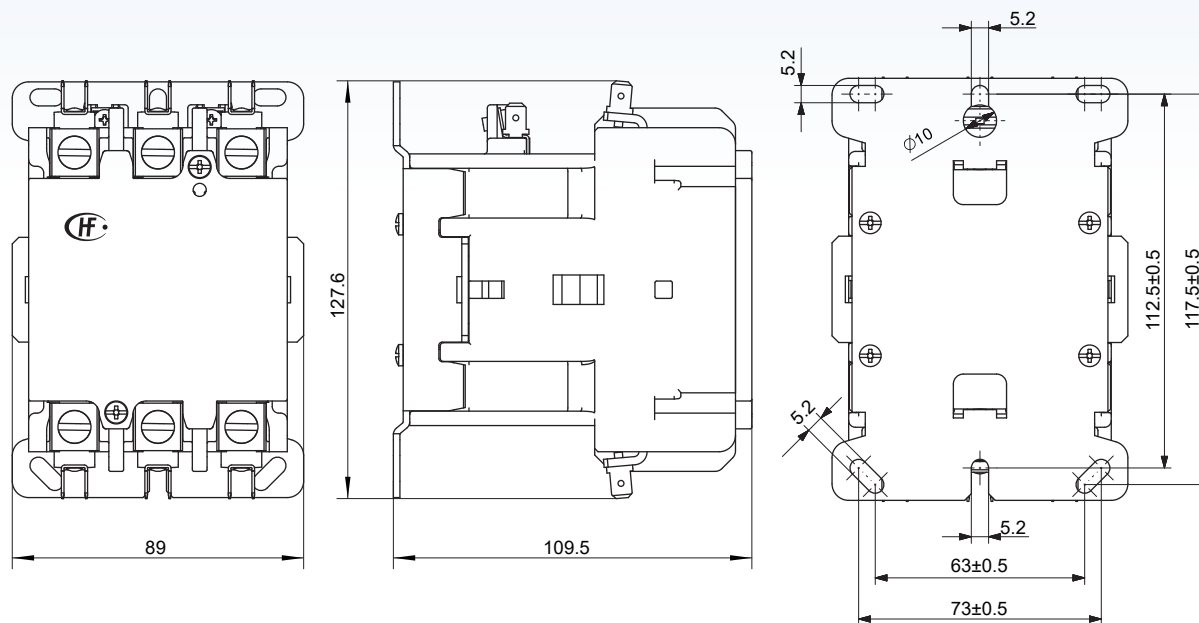

3 poles (metal base, 75-90FLA) - Quantum series

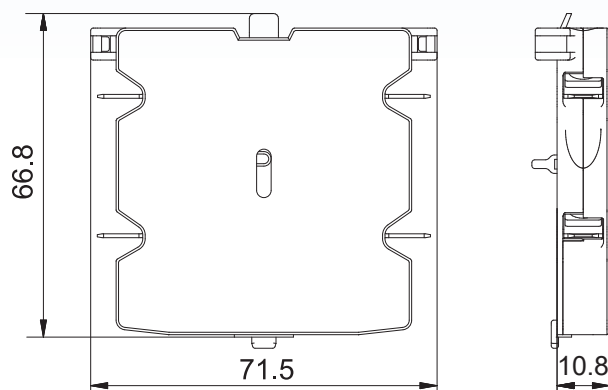

Auxiliary Contact Blocks - Used for 3P/4P Quantum series

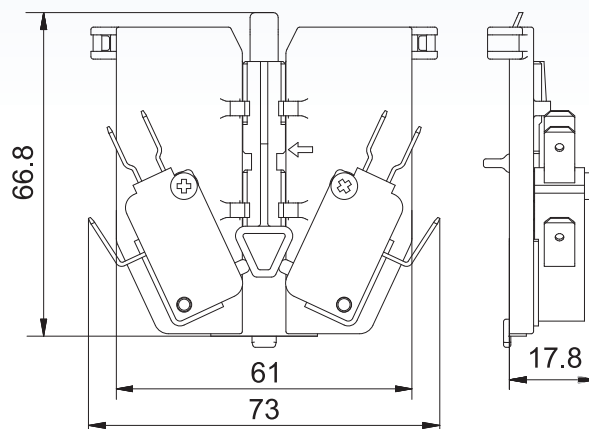

Microswitch Blocks - Used for 3P/4P Quantum series

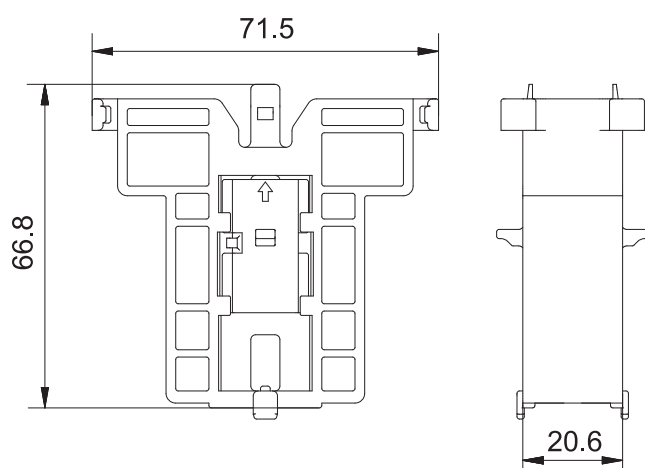

Interlock Blocks - Used for 3P/4P Quantum series

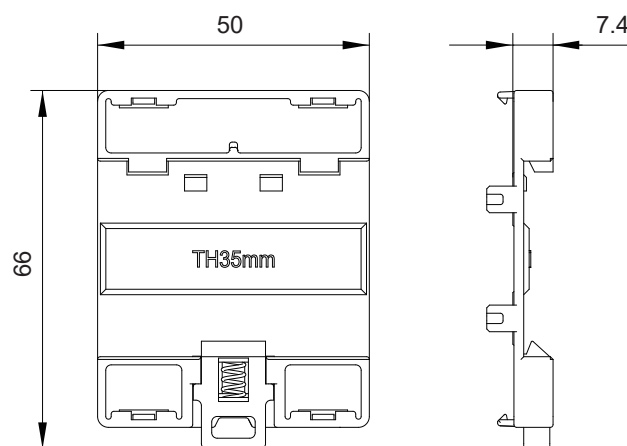

35mm DIN rail adapter - Used for 1P/2P series

Notes: The tolerance of undeclared outline dimensions is ± 1.5 .

Wiring Diagram

Contactors:

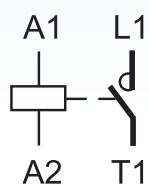

XMC0-□7

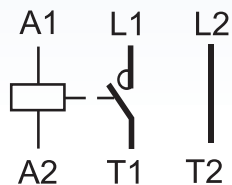

XMC0-□1

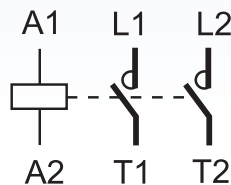

XMC0-□2

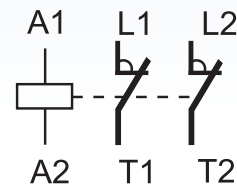

XMC0-□2C

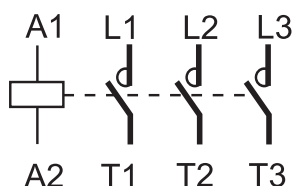

XMC0-□3

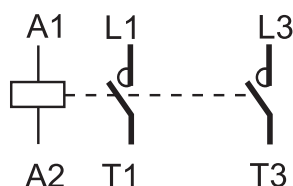

XMC0-□3A

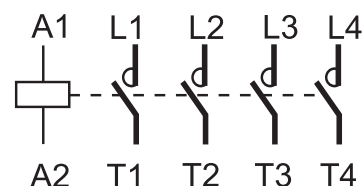

XMC0-□4

Auxiliary Contact Blocks:

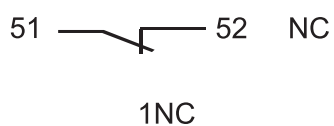

1NC

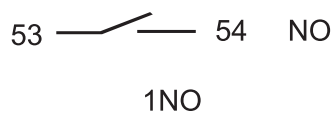

1NO

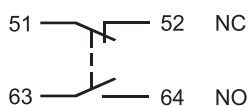

1NC + 1NO

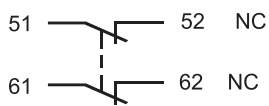

2NC

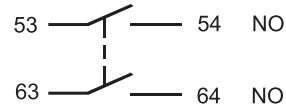

2NO

Main Contact Terminals

Unit: mm

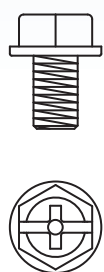

C type on 25-40A FLA

#10-32 combination
phillips, slotted &
5/16 hex head with
#8 washer

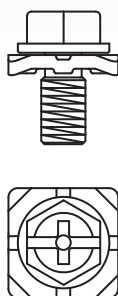

Special C type on 25-40A FLA

#10-32 sems screw
with pressure plate

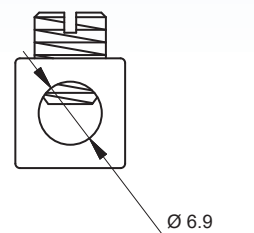

D type on 25-40A FLA

#14-4 AWG Cu/Al

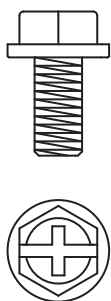

C type on 50-90A FLA

M6 combination
phillips, slotted &
3/8 hex head with
#12 washer

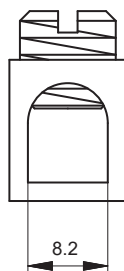

D type on 50-63A FLA

#14-2 AWG Cu/Al



D type on 75-90A FLA

#8-1/0 AWG Cu only

Remarks:

- 1) Torque for Screws 25 lb-in /Lugs 25 lb-in for 25-40FLA types;
Torque for Screws 45 lb-in /Lugs 50 lb-in for 50-63FLA types;
Torque for Screws 50 lb-in /Lugs 60 lb-in for 75-90FLA types;
Torque for Screws 8 lb-in for Auxiliary Contact Blocks;
Torque for Coil Screws 8 lb-in for 3/4-pole 25-40FLA types and 12 lb-in for 50-90FLA types;
- 2) For QC connection ,the female connectors should meet IEC60760 and ensure the reliable connection between female connectors and QC terminals.
- 3) Please contact us for any application out of specification.

Xiamen Hongfa Electroacoustic Co. Ltd

Add: No.560-578, Donglin Rd., Jimei North Ind. Dist., Xiamen, China

TEL: +86-592-6106688

FAX: +86-592-6106678

E-mail: marketing@hongfa.com

Marketing & Sales Network

Hongfa Europe GmbH

ADD: Marie-Curie-Ring 26, D-63477
Maintal, Germany

TEL: +49-6181-4306-0

E-mail: info@hongfa-europe.com

Hongfa America, Inc.

ADD: 20381 Hermana Circle, Lake
Forest, CA92630, USA

TEL: +1-714-669-2888

E-mail: sales@hongfaamerica.com

KG Technologies, Inc.

ADD: 6028 Stat Farm Drive
Rohnert Park, CA 94928, USA

TEL: +1.888.513.1874

E-mail: info@kgtechnologies.com

Hongfa Italy Srl

ADD: C/O Regus Business Center
Via Paracleso, 26 Agrate
B.za (MB), Italy

TEL: +39-0362-890-1544

E-mail: info@hongfa-europe.com

Hongfa Electroacoustic (Hongkong) Co., Ltd.

ADD: Rm 1810-12, 18/F., Shatin Galleria,
18-24 Shan Mei St., Fotan, N.T., HongKong

TEL: +852-2947-7889

E-mail: hongkong@hongfa.com

Shanghai Hongfa Electroacoustic Co., Ltd.

ADD: NO.51.341, Jiuxin Rd., Jiuting
Town, Songjiang Dist., Shanghai

TEL: +86-21-37693111

E-mail: shanghai@hongfa.com

Beijing Hongfa Electroacoustic Relay Co., Ltd.

ADD: 111Bldg, Phase IV Westside of Lian
-dong U Valley, Tongzhou Dist., Beijing

TEL: +86-10-56495556

E-mail: beijing@hongfa.com

Sichuan Hongfa Relay Co., Ltd.

ADD: 12F, Hongfa Building, No.6 Wuxing 4th
Road, Wuhou District, Chengdu

TEL: +86-28-86627550

E-mail: sichuan@hongfa.com

Hongfa India Branch

TEL: +91-9810415895

E-mail: amitkhuda@hongfa.com

TEL: +91-9971187792

E-mail: rohit@hongfa.com

Hongfa Korea Branch

ADD: RM302, Samwoo B/D, 286-4
Gaebong dong, Guro-gu,
Seoul, Korea

TEL: +82-10-5355-4899/+82-10-8704-4706

E-mail: korea@hongfa.com /
khlee@hongfa.com

Hongfa Brazil Branch

Non-automotive relay project

TEL: +86-0592-6196714

E-mail: southamerica@hongfa.com

Automotive relay project

TEL: +55-11-949697906

E-mail: mauro-loyola@hongfa.com

Hongfa Philippine Branch

TEL: +639177189352 / +639175780846

E-mail: nia-videna@hongfa.com

Hongfa Turkey Branch

TEL: +90-535-0221881

E-mail: info-turkey@hongfa.com

The relevant information on the products contained is for reference only.
For details, please consult our business staff.

Headquarter's Marketing & Sales Center

ADD: No.566-578, Donglin Rd., Jimei North Ind. Dist., Xiamen

E-mail: marketing@hongfa.com

SALES SERVICE HOTLINE

400-600-1502



HONGFA GROUP



HONGFA ESC

March 2024